



**WHITEHORSES**

Buy. Sell. Let. Relax!

0114 268 8533  
info@whitehorses.com  
www.whitehorses.com

**33 Alms Hill Road, Parkhead**

Sheffield

Offers in Region of £550,000

# 33 Alms Hill Road

Parkhead, Sheffield

An absolutely beautiful, four bedroom, two bathroom, bay windowed, semi detached home. Having been tastefully extended to the loft to create a beautiful master bedroom that enjoys some truly fantastic views across to Ecclesall woods and beyond, the bedroom also comes with its own en-suite bathroom. Enjoying an open plan contemporary fitted dining kitchen with direct garden access the property is absolutely perfect for the growing family market and simply must be viewed internally to be fully appreciated. With three super spacious and light floors of accommodation that total an impressive 1,536 sq feet number 33 also benefits from a rear larger than expected southerly facing garden, ample front driveway and a detached garage. Located on this highly desirable, quiet residential road within the very heart of ultra popular Parkhead and falls with catchment for excellent schools including both Dobcoft juniors and Silverdale secondary.

Council Tax band: D Tenure: Leasehold

- FABULOUS FOUR BEDROOM TWO BATHROOM BAY WINDOWED SEMI-DETACHED
- STUNNING LOFT MASTER BEDROOM WITH EN-SUITE BATHROOM
- REAR LARGE PRIVATE SOUTHERLY FACING GARDEN DRIVEWAY AND GARAGE
- INCREDIBLE REAR VIEWS OVER TOWARDS ECCLESALL WOODS AND BEYOND
- EXCELLENT SCHOOLING CATCHMENTS INCLUDING DOBCROFT JUNIORS AND SILVERDALE SECONDARY
- THREE SPACIOUS AND LIGHT FLOORS OF ACCOMMODATION TOTTALLING AN IMPRESSIVE 1,536 SQ FT





### Garage

Approx. 14.9 sq. metres (160.5 sq. feet)



### Ground Floor

Approx. 50.2 sq. metres (540.6 sq. feet)

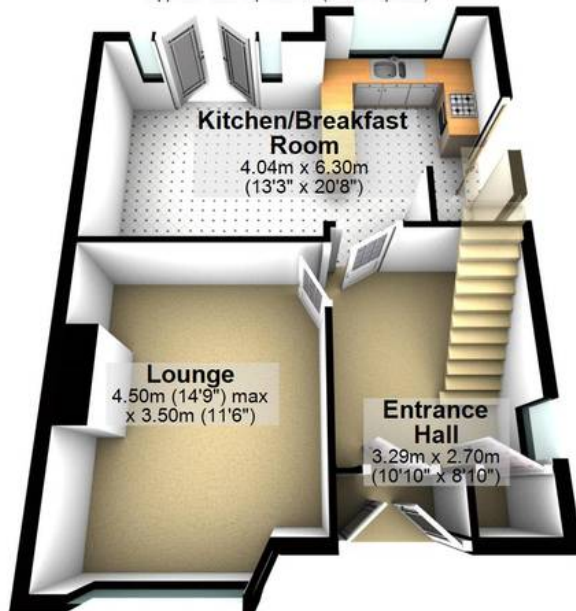

### First Floor

Approx. 50.2 sq. metres (540.6 sq. feet)



### Second Floor

Approx. 27.4 sq. metres (294.6 sq. feet)

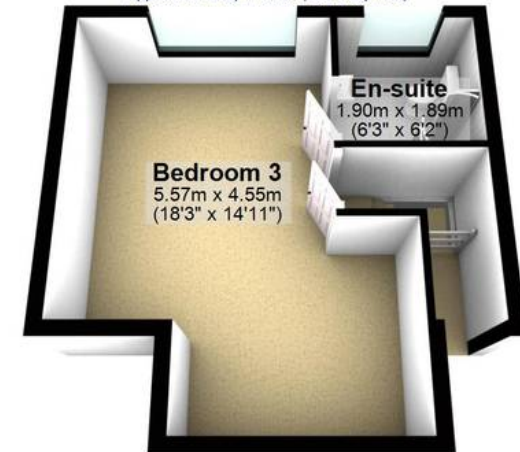

Total area: approx. 142.7 sq. metres (1536.3 sq. feet)

All measurements are approximate  
Plan produced using PlanUp.