



WHITEHORNES

Buy. Sell. Let. Relax!

0114 268 8533
info@whitehorns.com
www.whitehorns.com

95 Tavistock Road, Nether Edge

Sheffield

Guide Price £230,000

95 Tavistock Road

Nether Edge, Sheffield

An absolutely fabulous three bedroom, mid Victorian terraced property. With three lovely floors of accommodation totalling an impressive 972 sq feet this property is pitch perfect for the professional couple, first time buyers or the young family alike. Retaining a wealth of the original period features, character and charm associated with a property from this era and blending them with a modern finish including a log burner to front sitting room it's easy to say that viewing is absolutely essential to do full justice to this beautiful home. Located in the very heart of ultra popular Nether Edge on the south west of the city within a short stroll of fashionable Abbeydale Road that offers up an array of independent cafes, eateries and shops, excellent public transport links are close as are urban green spaces and not forgetting The Peak District is up the road. With easy on road parking to the front and rear garden the property in brief comprises front sitting

Council Tax band: A Tenure: Leasehold

- FABULOUS THREE BEDROOM VICTORIAN TERRACED HOME
- NUMEROUS BEAUTIFUL ORIGINAL PERIOD FEATURES CHARACTER AND CHARM ASSOCIATED WITH A PROPERTY FROM THIS ERA
- LOG BURNING STOVE TO THE LOVELY FRONT SITTING ROOM
- PERFECT FOR THE PROFESSIONAL COUPLE FIRST TIME BUYER OR YOUNG FAMILY ALIKE
- EXCELLENT LOCAL SCHOOL CATCHMENTS AVAILABLE INCLUDING MERCIA SECONDARY
- HEART OF ULTRA POPULAR NETHER EDGE ON THE SOUTH WEST OF THE CITY
- FASHIONABLE ABBEYDALE ROAD A SHORT STROLL





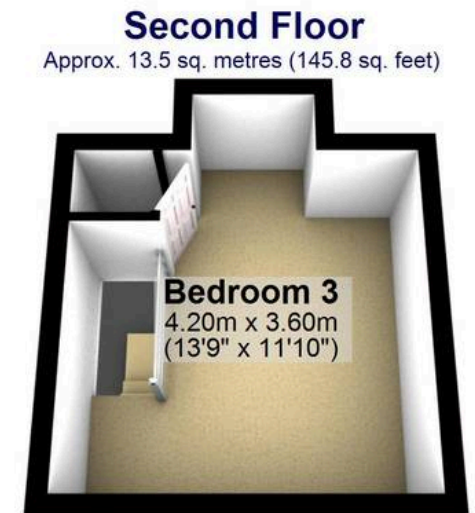
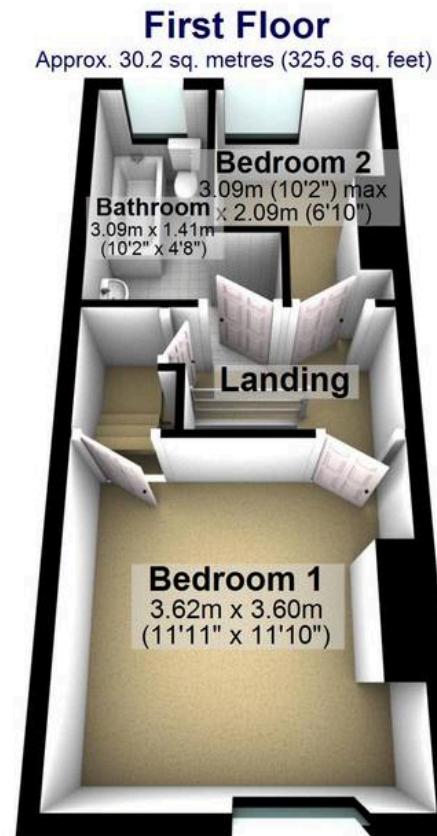
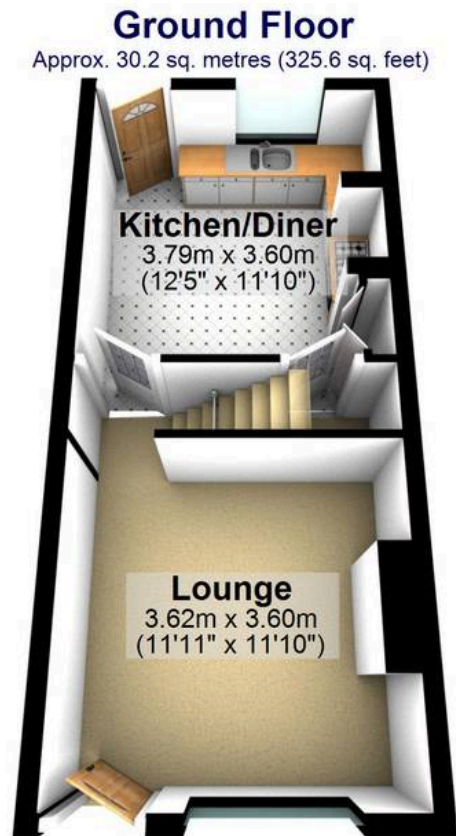
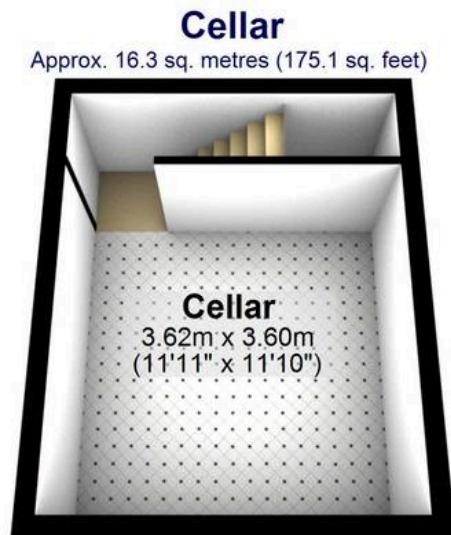

Total area: approx. 90.3 sq. metres (972.0 sq. feet)

All measurements are approximate
Plan produced using PlanUp.