



WHITEHORNS
Buy. Sell. Let. Relax!
0114 268 8533
info@whitehorns.com
www.whitehorns.com

293 Cemetery Road, Sharrow Head

Sheffield

Guide Price £550,000 - £575,000

293 Cemetery Road

Sharrow Head, Sheffield

Only upon a detailed internal viewing will the true beauty of this exceptional six bedroom, two bathroom, bay windowed, Victorian end of terrace be fully revealed. Finished to the very highest of standards by the current vendors with no expense spared the property has been careful to retain the original period features, character and charm associated with a property from this era and effortlessly blended them with a contemporary, fresh, modern vibe that is pitch perfect for the growing family market. With four incredibly light and spacious floors of accommodation that total an impressive 2,117 sq feet that incorporate a basement utility room together with a fabulous rear landscaped, private garden. Located on this incredibly popular residential road in the heart of Sheffield eleven, number 293 is within walking distance to the city centre, hospitals and universities are also close by.

Council Tax band: C Tenure: Leasehold

- FABULOUS SIX BEDROOM TWO BATHROOM END OF TERRACED PROPERTY
- FOUR FANTASTIC FLOORS OF ACCOMMODATION TOTALLING AN IMPRESSIVE 2,117 SQ FEET
- FINISHED INTERNALLY TO THE VERY HIGHEST OF STANDARDS WITH NO EXPENSE SPARED BY THE CURRENT VENDORS
- LOCATED ON THIS SUPER POPULAR RESIDENTIAL ROAD IN THE HEART OF SHARROW HEAD
- EXCELLENT SCHOOLING CATCHMENTS AVAILABLE INCLUDING HUNTERS BAR JUNIOR AND HIGH STORRS SECONDARY
- AVAILABLE WITH NO UPWARD CHAIN INVOLVED AND VIEWING ABSOLUTELY ESSENTIAL





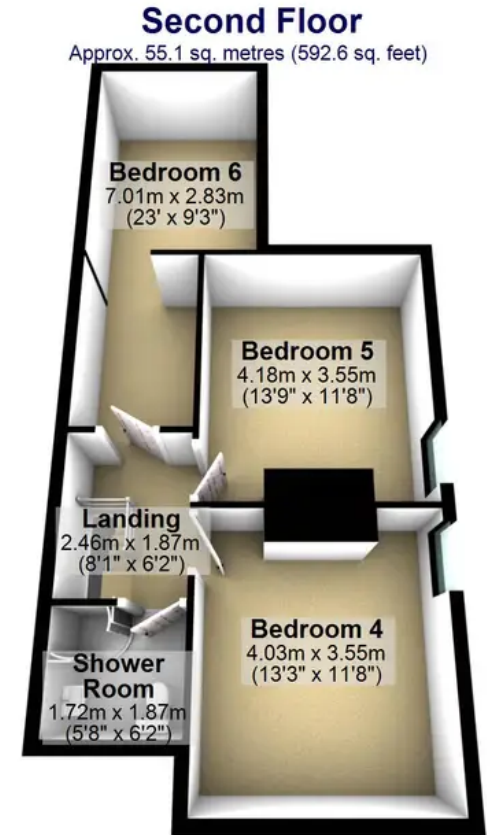
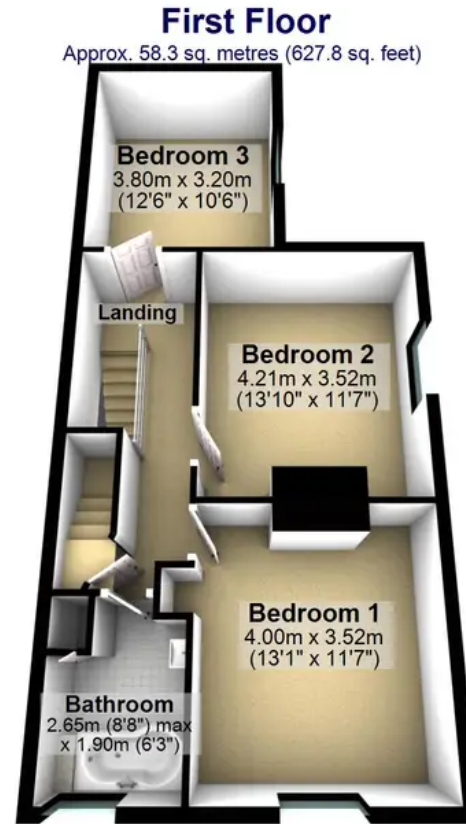
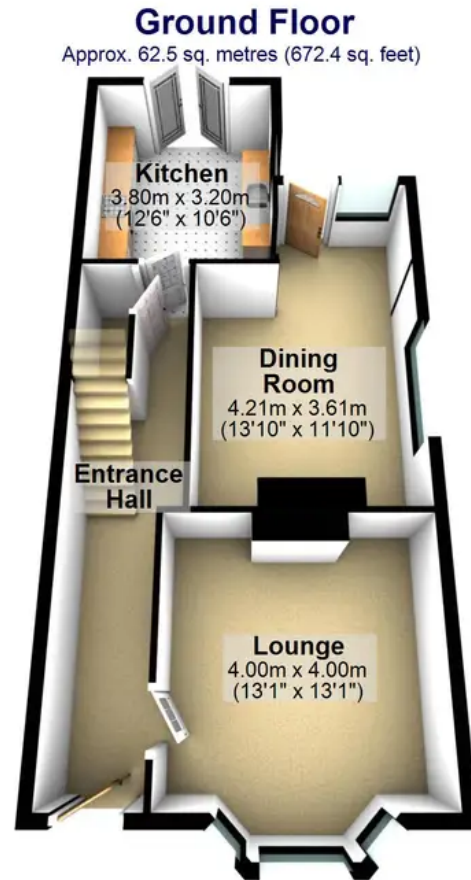
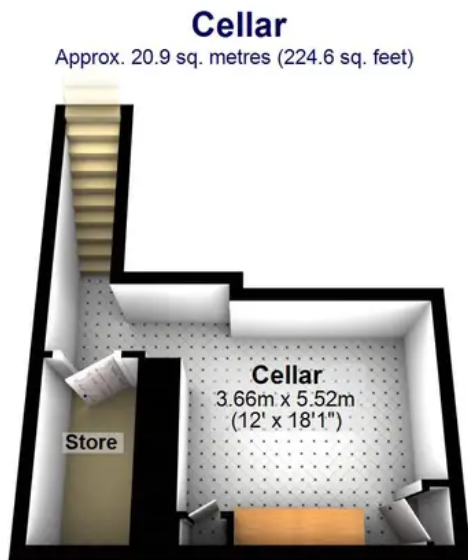

Total area: approx. 196.7 sq. metres (2117.3 sq. feet)

All measurements are approximate
Plan produced using PlanUp.