



WHITEHORNS

Buy. Sell. Let. Relax!

0114 268 8533
info@whitehorns.com
www.whitehorns.com

56 Wake Road, Nether Edge

Sheffield

Guide Price £325,000 – £350,000

56 Wake Road

Nether Edge, Sheffield

Nestled in the heart of the ultra-popular Nether Edge on the south-western outskirts of the city, this fabulous, immaculately presented four double bedroom period villa terraced property presents a covetable blend of character and contemporary finish that has had no expense spared by the current vendors. Spanning three floors and offering an impressive total of 1,846 sq feet, this home is ideal for a family market or the professional couple alike. With excellent local school catchments including Mercia and High Storrs Secondary, this property stands out as a rare find in a sought-after area. The spacious living areas are complemented by a beautiful fitted open plan dining kitchen with easy access to the private garden, offering a seamless indoor-outdoor lifestyle. Additionally, there is easy on-road parking to the front. The sizeable cellar offers the exciting opportunity for a full conversion, providing the potential to add value in the future. Buzzing Nether Edge Village feel center and Abbeydale

Council Tax band: B Tenure: Leasehold

- FABULOUS FOUR DOUBLE BEDROOM PERIOD VILLA TERRACE
- EASY ACCESS TO NETHER EDGE VILLAGE FEEL CENTRE AND ABBEYDALE ROAD THAT BOTH OFFER AN ARRAY OF INDEPENDENT CAFES AND EATERIES
- DOUBLE REAR OFF SHOT PRIVATE GARDEN AND EASY ON ROAD PARKING TO THE FRONT
- EXCELLENT LOCAL SCHOOL CATCHMENTS INCLUDING MERCIA AND HIGH STORRS SECONDARY
- PERFECT FOR THE FAMILY OR PROFESSIONAL COUPLE WITH VIEWING ESSENTIAL TO DO FULL JUSTICE
- HEART OF ULTRA POPULAR NETHER EDGE ON THE SOUTH WEST OF THE CITY





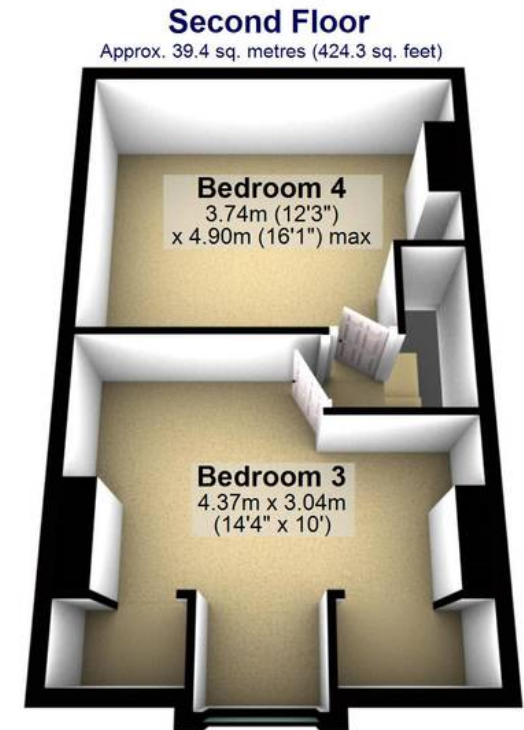
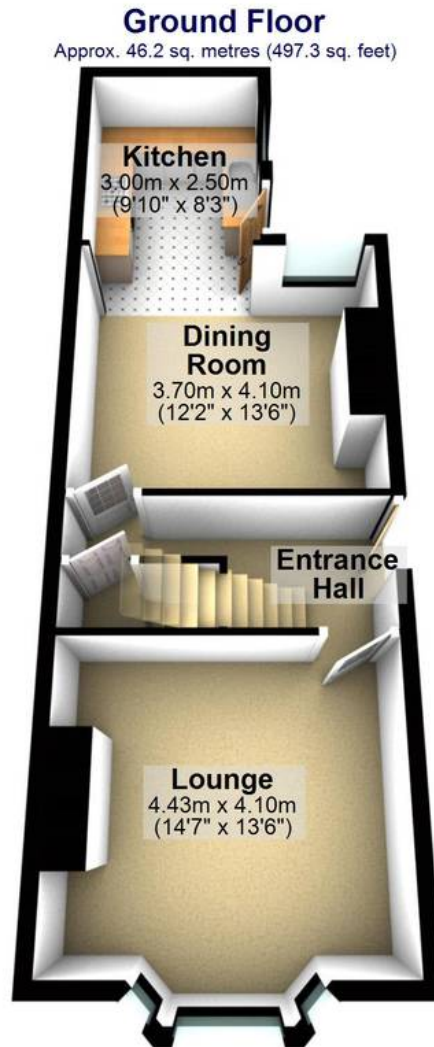
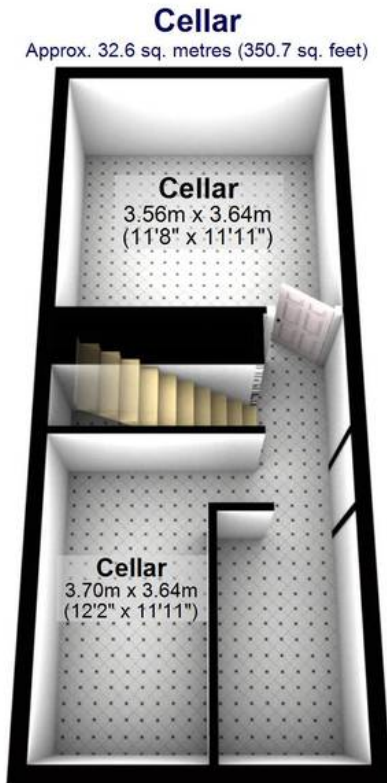

Total area: approx. 171.5 sq. metres (1846.3 sq. feet)

All measurements are approximate
Plan produced using PlanUp.