



WHITEHORNS

Buy. Sell. Let. Relax!

0114 268 8533
info@whitehorns.com
www.whitehorns.com

22 Celandine Gardens, Bradway

Sheffield

Offers in Region of £199,950

22 Celandine Gardens

Bradway, Sheffield

An absolutely stunning one-bedroom semi-detached home, nestled in a quiet cul-de-sac at the heart of the highly sought-after Bradway. This unique property boasts a modern and stylish design that has been fully modernised and finished to an exceptional standard - truly a home where no expense has been spared. Upon entering, you are greeted by the unique internal layout that sets this property apart from the rest. The seamless flow between the living spaces creates a sense of openness and warmth. Ideal for a first-time buyer, professional couple, downsizer, or investor, this home offers versatile living. The property features a private rear garden parking to the front ensures convenience for residents and visitors alike. Boasting stunning views towards the golf course and beyond, this home offers a picturesque backdrop that enhances the overall appeal of the property. The proximity to numerous local amenities and the renowned Peak District makes this an ideal location for those seeking both convenience

Council Tax band: A Tenure: Leasehold

- STUNNING ONE BEDROOM SEMI DETACHED HOME
- UNIQUE INTERNAL LAYOUT/DESIGN WITH VIEWING ESSENTIAL
- FULLY MODERNISED AND FINISHED TO A SUPER HIGH STANDARD WITH NO EXPENSE SPARED
- QUIET CUL DE SAC POSITION IN THE VERY HEART OF ULTRA POPULAR BRADWAY
- PRIVATE REAR GARDEN AND PARKING TO THE FRONT
- IDEAL FOR THE FIRST TIME BUYER





Ground Floor

Approx. 26.0 sq. metres (280.3 sq. feet)

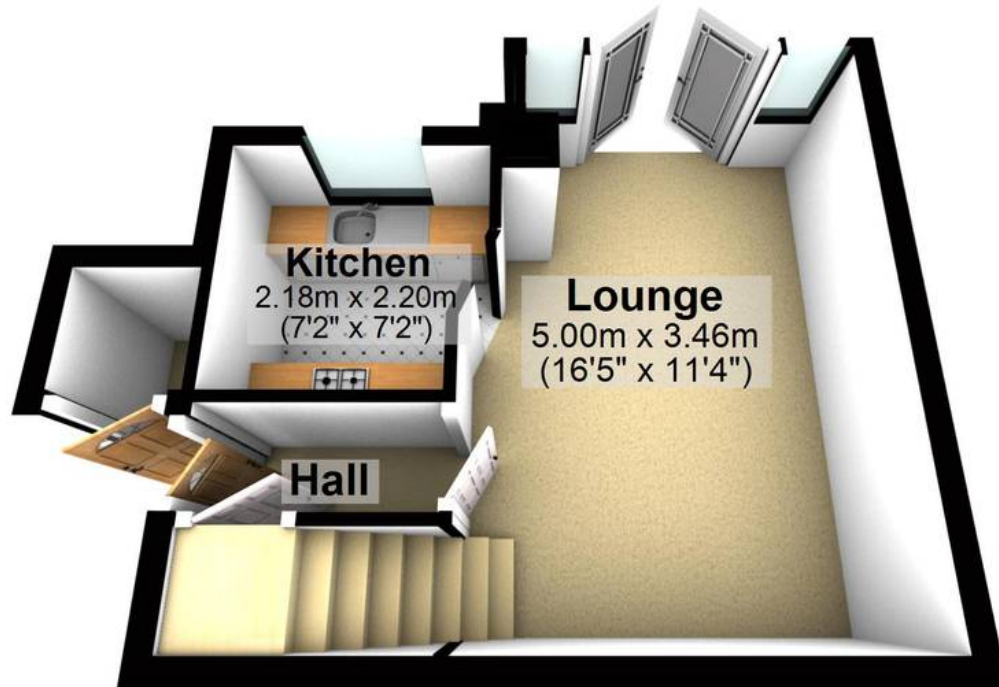

First Floor

Approx. 23.3 sq. metres (251.1 sq. feet)

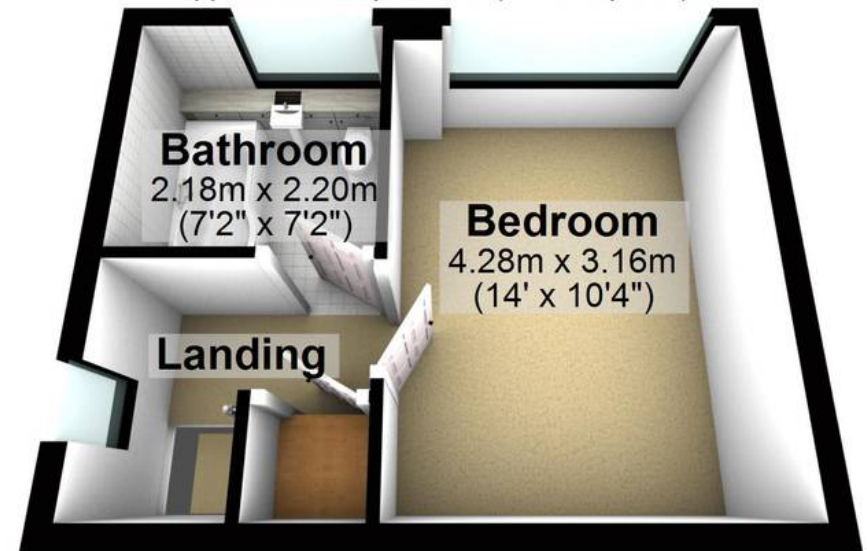

Total area: approx. 49.4 sq. metres (531.3 sq. feet)

All measurements are approximate
Plan produced using PlanUp.