

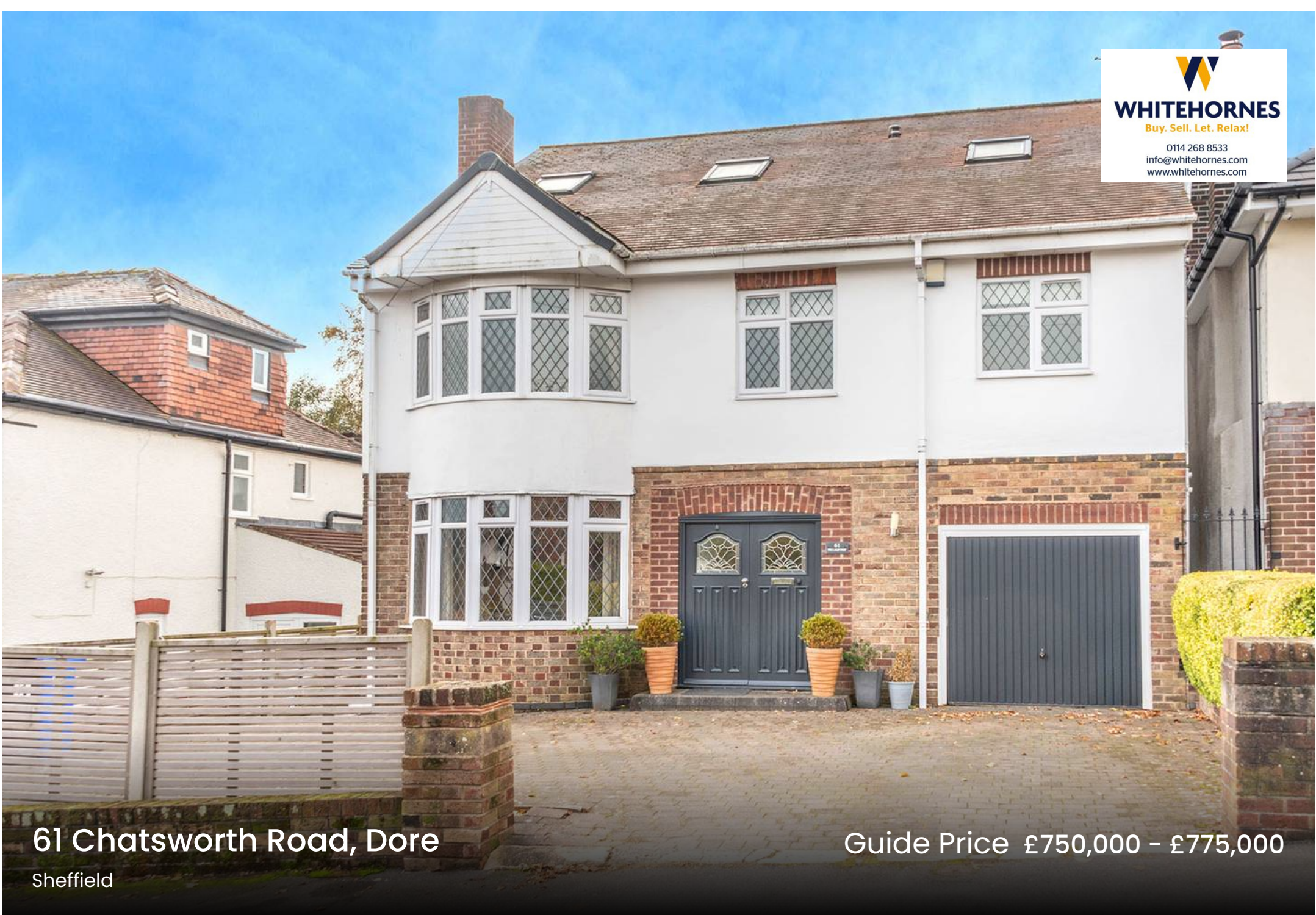

WHITEHORNES

Buy. Sell. Let. Relax!

0114 268 8533
info@whitehorns.com
www.whitehorns.com



61 Chatsworth Road, Dore
Sheffield

Guide Price £750,000 - £775,000

61 Chatsworth Road

Dore, Sheffield

An absolutely fabulous, five bedroom, three bathroom, double fronted, detached family home. Having been tastefully extended over the years to the side, rear and loft to create three superb floors of flexible living accommodation that total an impressive 2,599 sq feet. Quietly tucked away on this prestigious residential road in the heart of ultra popular Dore on the south west of the city. Pitch perfect for the growing family market looking to acquire a forever family home it's easy to say that viewing is prerequisite to fully appreciate the size and style on offer by this gorgeous property. With numerous reception rooms, open plan fitted living dining kitchen to the ground floor, excellent master loft bedroom with en-suite and ample storage together with four further generous sized bedrooms and two bathrooms are on the first floor. Enjoying some incredible views to the rear over the moors and beyond, number sixty one also has a larger than expected rear private sunny garden, ample front driveway

Council Tax band: D Tenure: Leasehold

- STUNNING FIVE BEDROOM THREE BATHROOM DETACHED FAMILY HOME
- TASTEFULLY EXTENDED TO THE SIDE REAR AND LOFT TO CREATE THIS SIZEABLE PROPERTY
- THREE INCREDIBLE FLOORS OF ACCOMMODATION THAT TOTAL AN IMPRESSIVE 2,599 SQ FT
- IMPRESSIVE REAR ENCLOSED PRIVATE SUNNY GARDEN AND FAR REACHING VIEWS OVER THE PEAK DISTRICT
- EXCELLENT SCHOOLING CATCHMENTS





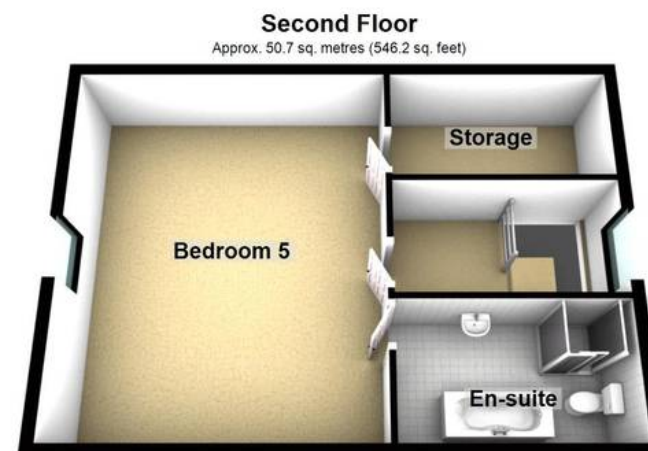
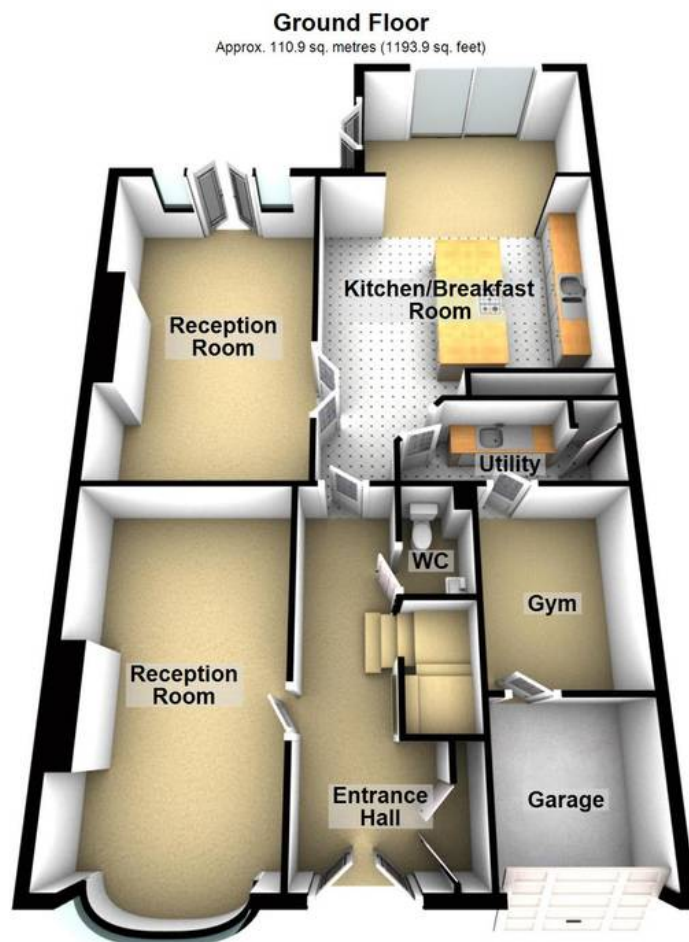

Total area: approx. 241.5 sq. metres (2599.8 sq. feet)