



**WHITEHORSES**

Buy. Sell. Let. Relax!

0114 268 8533  
info@whitehorses.com  
www.whitehorses.com

**15 Lees Hall Road, Sheffield**

Sheffield

In Excess of **£350,000**



# 15 Lees Hall Road

Sheffield, Sheffield

Presenting this beautiful four bedroomed semi detached property located in the heart of the well sought after suburb of Norton Lees. Totalling an impressive 1,428 Sq Ft across four floors this property briefly consists of a well appointed kitchen, dining room, lounge, family bathroom, 4 bedrooms including a loft bedroom with ensuite bathroom and a cellar. To the outside is a large private and enclosed rear garden and ample off road parking. Number 15 is conveniently located with local amenities including Meersbrook Park and Lees Hall Golf Club only a short stroll away. Located in local schooling catchments including Ofsted rated Carter Knowle Junior School. It is easy to say that viewing is essential to do full justice of the fantastic finish of this light and bright property. Falling into council tax band C there is an annual charge of £2,021.

Council Tax band: C

Tenure: Leasehold

- FOUR BEDROOMED SEMI DETACHED PROPERTY
- FOUR FLOOR OF SPACIOUS AND LIGHT ACCOMODATION TOTALLING 1428 SQ FT
- HEART OF THE WELL SOUGH AFTER SUBURB OF NORTON LEES
- FINISHED TO A BEAUTIFUL STANDARD BY THE CURRENT VENDORS
- PRIVATE AND ENCLOSED REAR GARDEN
- VIEWING ESSENTIAL TO DO FULL JUSTICE
- LOCAL SCHOOLING CATCHMENTS INCLUDING CARTER KNOWLE JUNIOR SCHOOL AND NEWFIELD SECONDARY SCHOOL
- CLOSE TO LOCAL AMENITIES INCLUDING MEERSBROOK PARK A SHORT STROLL AWAY
- LEASEHOLD PROPERTY WITH 676 YEARS LEFT GROUND









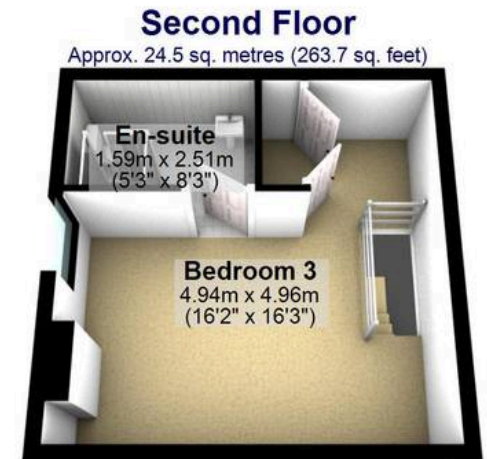
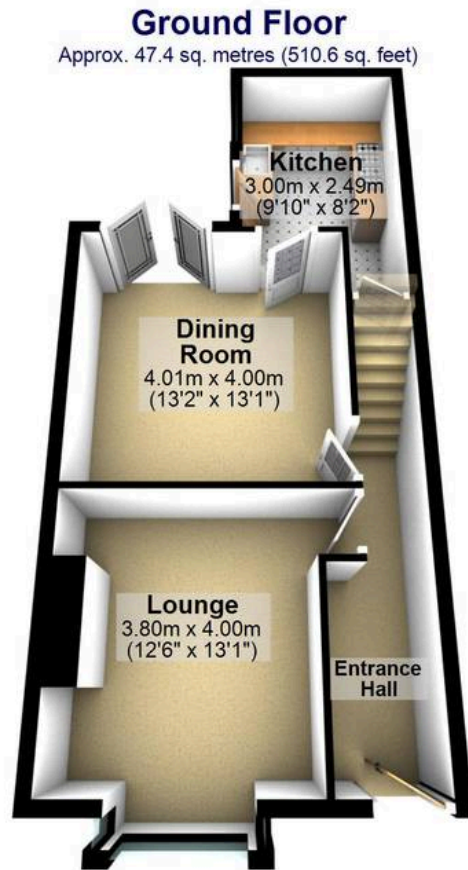
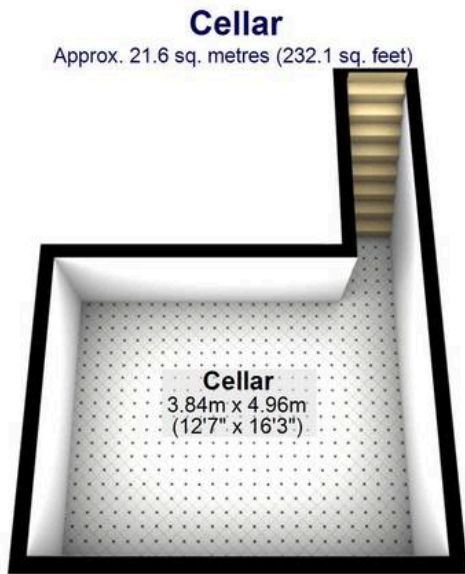

Total area: approx. 132.8 sq. metres (1428.9 sq. feet)

All measurements are approximate  
Plan produced using PlanUp.