



**WHITEHORSES**

Buy. Sell. Let. Relax!

0114 268 8533  
info@whitehorses.com  
www.whitehorses.com

**27 Swift Close, Bradwell**

Hope Valley

In Excess of **£350,000**

# 27 Swift Close

Bradwell, Hope Valley

Council Tax band: C

Tenure: Freehold

- THREE BEDROOMED STONE-BUILT SEMI-DETACHED PROPERTY
- LOCATED IN THE HEART OF THE WELL SOUGHT AFTER BRADWELL
- ALLOCATED PARKING SPACES FOR THREE VEHICLES
- PERFECT FOR FIRST TIME BUYERS OR YOUNG FAMILIES ALIKE
- SOUTH-FACING PRIVATE REAR GARDEN AND BENEFITTING FROM SOLAR PANELS
- CLOSE TO LOCAL AMENITIES INCLUDING SHOPS AND EATERIES
- STUNNING VIEWS OF BRADWELL EDGE
- LOCAL SCHOOL CATCHMENT FOR BRADWELL JUNIOR SCHOOL
- BENEFITTING FROM NO ONWARD CHAIN
- FREEHOLD PROPERTY AND COUNCIL TAX BAND C £1,996 P/A





## Ground Floor

Approx. 41.7 sq. metres (449.3 sq. feet)

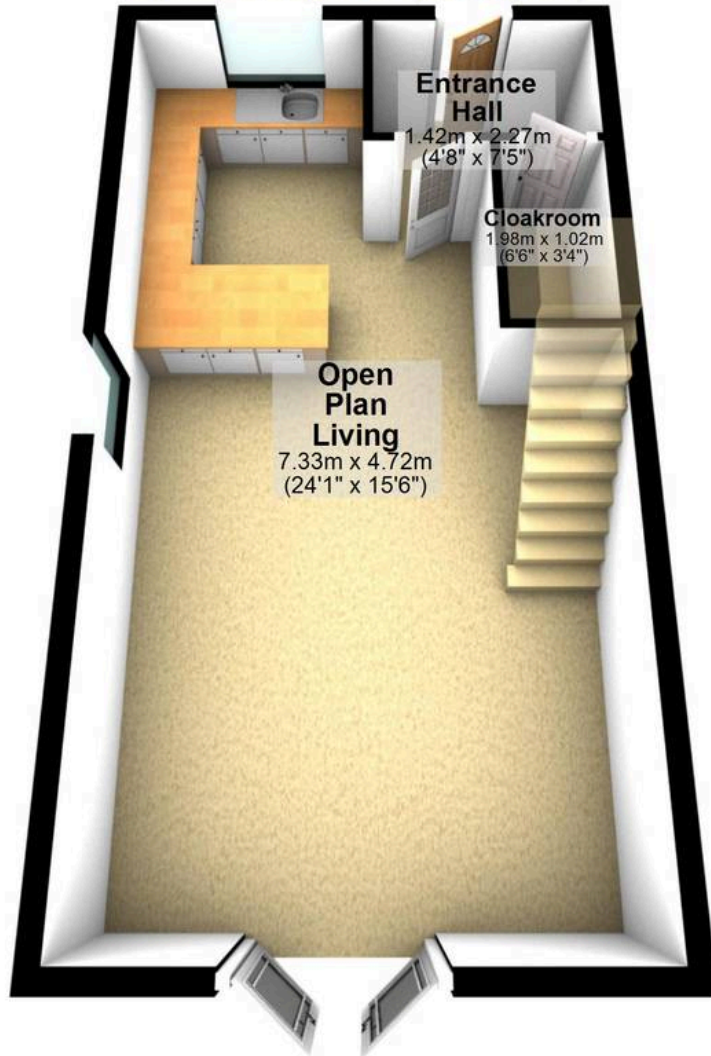

## First Floor

Approx. 41.7 sq. metres (449.3 sq. feet)

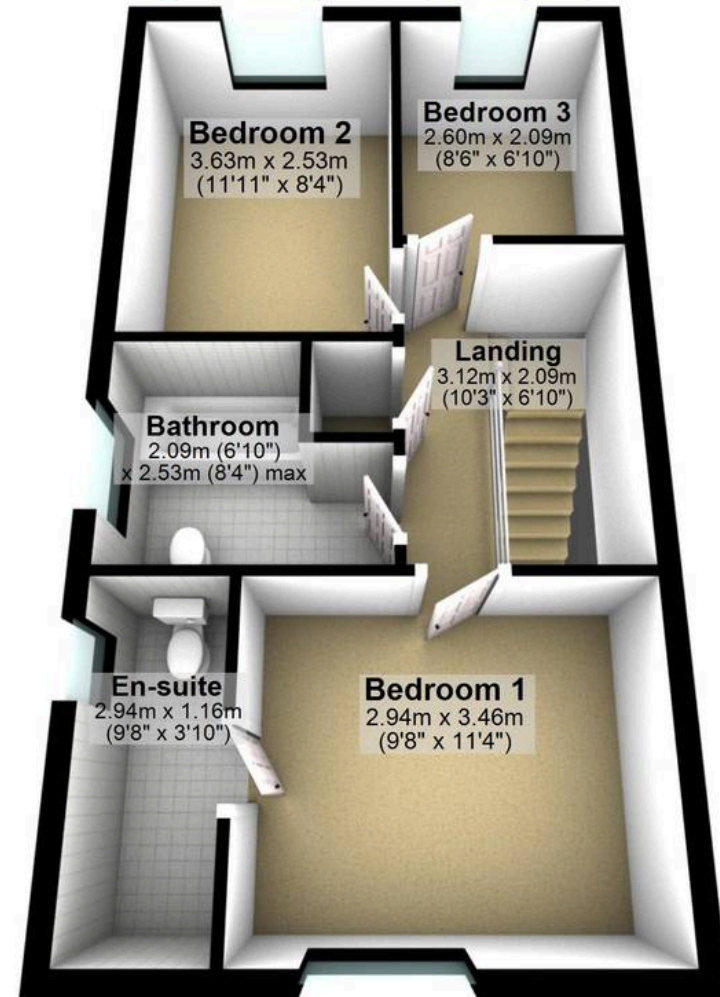

Total area: approx. 83.5 sq. metres (898.7 sq. feet)

All measurements are approximate  
Plan produced using PlanUp.