



WHITEHORNES

Buy. Sell. Let. Relax!

0114 268 8533
info@whitehorses.com
www.whitehorses.com

154 Oakbrook Road, Nether Green

Sheffield

Guide Price £475,000 - £495,000

154 Oakbrook Road

Nether Green, Sheffield

An absolutely stunning, immaculately presented and very deceptive four double bed roomed, bay windowed Victorian terraced property. Having been finished to a super high standard by the current vendors with absolutely no expense spared along with a sumptuous rear ground floor extension. The property has been careful to retain the original features, character and charm associated with a property from this era and blended them with a modern and fresh finish. With three impressive floors of accommodation that total 1,512 sq feet, number 154 enjoys a larger than expected rear private garden, on road parking and some tremendous views with its elevated position. Located on this well regarded residential road in the very heart of ultra popular Nether Green the property is within a short stroll of numerous independent cafes, eateries and shops. Ofsted rated excellent schooling catchments of Nether Green Juniors and High Storrs are available, Endcliffe park is close by

Council Tax band: C Tenure: Leasehold

- STUNNING FOUR DOUBLE BEDROOMED PERIOD VICTORIAN TERRACED
- INCREDIBLE REAR GROUND FLOOR EXTENSION THAT NEEDS TO BE VIEWED
- THREE IMPRESSIVE FLOORS OF ACCOMMODATION TOTALLING 1,512 SQ FT
- ELEVATED POSITION ENSURING PRIVACY AND SOME SPECTACULAR VIEWS
- EXCELLENT SCHOOLING CATCHMENTS INCLUDING NETHEEGREEN JUNIORS AND HIGH STORRS SECONDARY
- LARGER THAN EXPECTED REAR PRIVATE GARDEN
- HEART OF ULTRA POPULAR NETHERGREEN SUBURB





Ground Floor

Approx. 53.8 sq. metres (578.8 sq. feet)

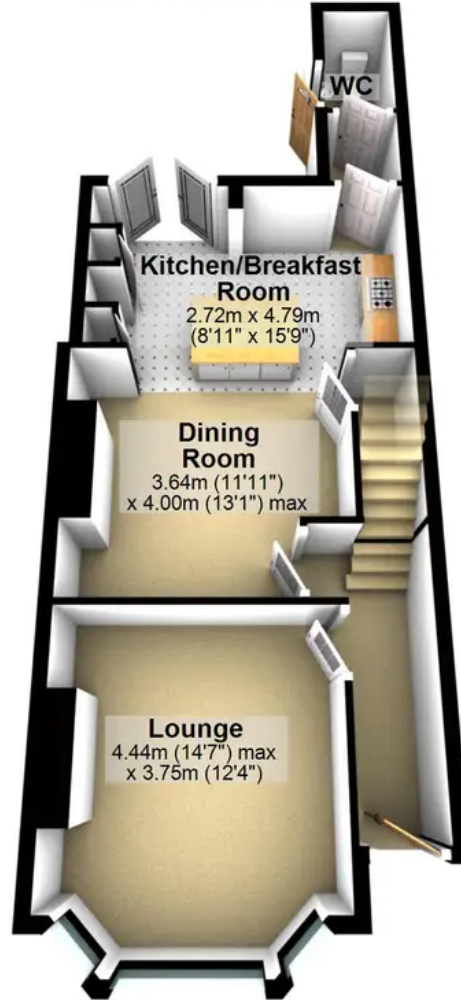

First Floor

Approx. 43.4 sq. metres (466.8 sq. feet)

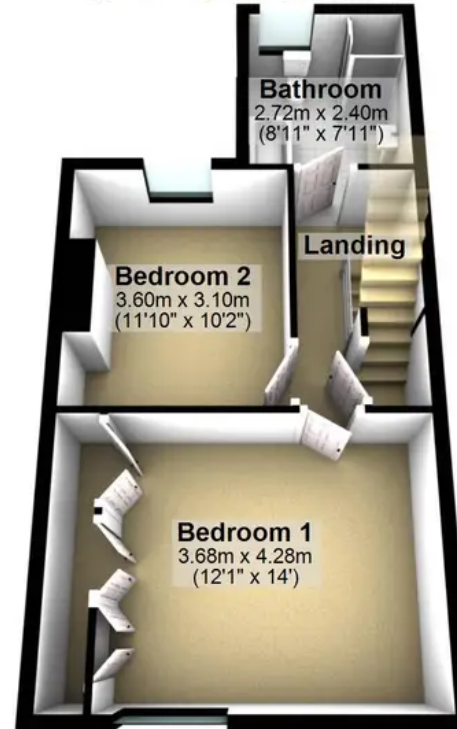

Second Floor

Approx. 24.0 sq. metres (258.4 sq. feet)

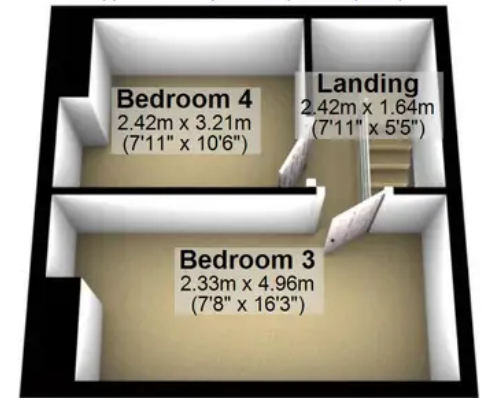

Cellar

Approx. 19.4 sq. metres (208.8 sq. feet)

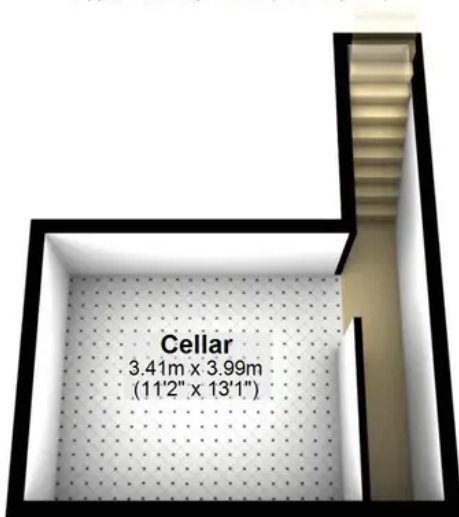

Total area: approx. 140.5 sq. metres (1512.8 sq. feet)

All measurements are approximate
Plan produced using PlanUp.