



WHITEHORNES

Buy. Sell. Let. Relax!

0114 268 8533
info@whitehorns.com
www.whitehorns.com



81 Mansfield Road, Sheffield

Sheffield

Guide Price **£160,000**

81 Mansfield Road

Sheffield, Sheffield

Offered for sale is this exceptional and unique two bedroomed period semi-detached family home. Nestled in the heart of this popular suburb with a wealth of local amenities within easy walking distance as well as superb transport links, green spaces and reputable local schools. Having been finished throughout to the very highest of standards throughout combining the wealth original features and modern touches. Property briefly comprises entrance hallway, lounge, dining room, off shot kitchen, two bedrooms family bathroom, cellar and loft. Outside is a private garden and ample on street parking to the front.

Council Tax band: A

Tenure: Leasehold

- TWO BEDROOMED SEMI DETACHED PERIOD PROPERTY
- LOCATED IN THE HEART OF INTAKE
- CLOSE TO LOCAL AMENITIES AND GREEN SPACES INCLUDING HOLLINSEND PARK
- AMPLE ON STREET PARKING
- PRIVATE AND ENCLOSED FAMILY GARDEN WITH DECKING AREA
- EPC RATING D
- LOCAL SCHOLING CATCHMENT INCLUDING INTAKE PRIMARY SCHOOL AND SHEFFIELD SPRINGS ACADEMY
- PERFECT FOR FIRST TIME BUYERS OR GROWING FAMILIES ALIKE
- VIEWING ESSENTIAL TO DO FULL JUSTICE
- LEASEHOLD PROPERTY AND COUNCIL TAX BAND A £1,516 P/A





Ground Floor
Approx. 39.4 sq. metres (423.6 sq. feet)

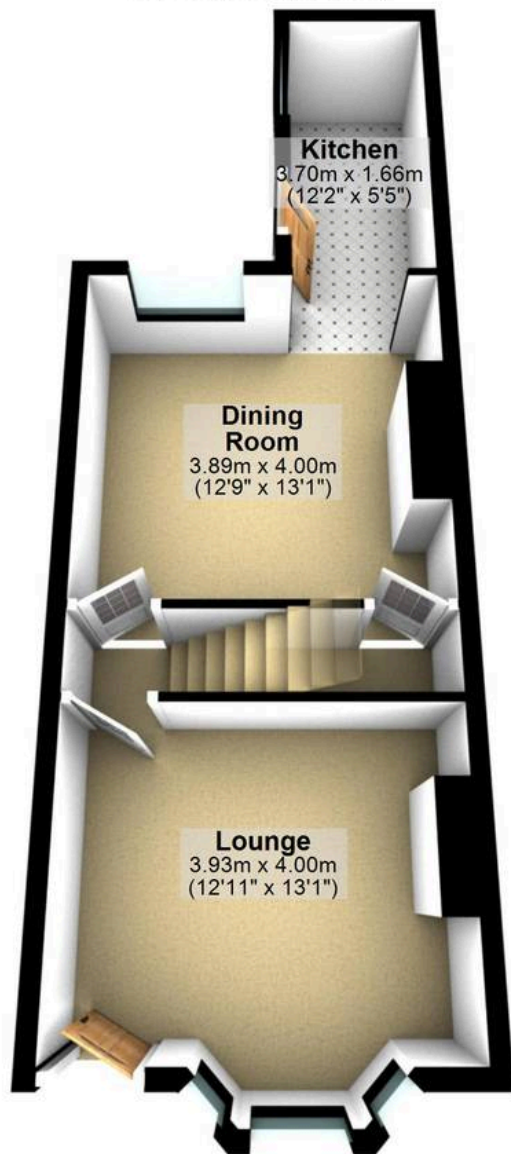

First Floor
Approx. 32.8 sq. metres (352.9 sq. feet)

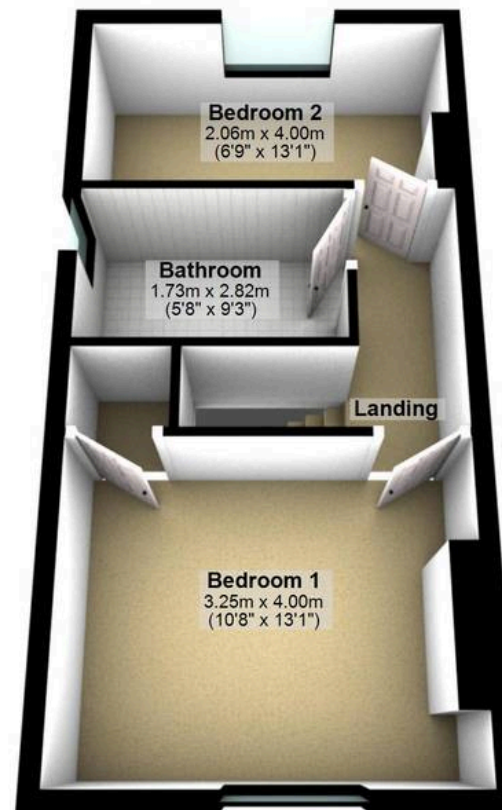

Total area: approx. 72.1 sq. metres (776.5 sq. feet)

All measurements are approximate
Plan produced using PlanUp.