



WHITEHORNES

Buy. Sell. Let. Relax!

0114 268 8533
info@whitehorses.com
www.whitehorses.com

44 Everton Road, Endcliffe

Sheffield

Offers in Region of £340,000

44 Everton Road

Endcliffe, Sheffield

An absolutely fabulous three bedroom, bay windowed, Victorian terraced property. Retaining a wealth of the original period features, character and charm associated with a property from this era and effortlessly blending them with a cool contemporary vibe that is sure to be popular with the professional couple and young family alike. Including a newly fitted bathroom, landscaped rear garden, log burner to the front sitting room and made to measure shutters to the principal bedroom and front room. This beautiful home enjoys three spacious and floors of accommodation that total an impressive 1,091 sq feet. With residents parking scheme to the front number 44 stands in this commanding position that ensures a huge degree of privacy and some excellent views.

Council Tax band: B Tenure: Leasehold

- FABULOUS THREE BEDROOM PERIOD VICTORIAN BAY WINDOW TERRACED HOME
- THREE INCREDIBLE FLOORS OF ACCOMMODATION THAT TOTAL AN IMPRESSIVE 1,091 SQ FEET
- BESPOKE SHUTTERS TO THE SITTING ROOM AND PRINCIPAL BEDROOM
- LOG BURNING STOVE RESIDENTS PARKING SCHEME AND LANDSCAPED REAR PRIVATE GARDEN
- PERFECT FOR THE PROFESSIONAL COUPLE FIRST BUY OR YOUNG FAMILY ALIKE
- EXCELLENT SCHOOLING CATCHMENTS INCLUDING HUNTERS BAR JUNIORS AND HIGH STORRS SECONDARY
- NEWLY FITTED BATHROOM



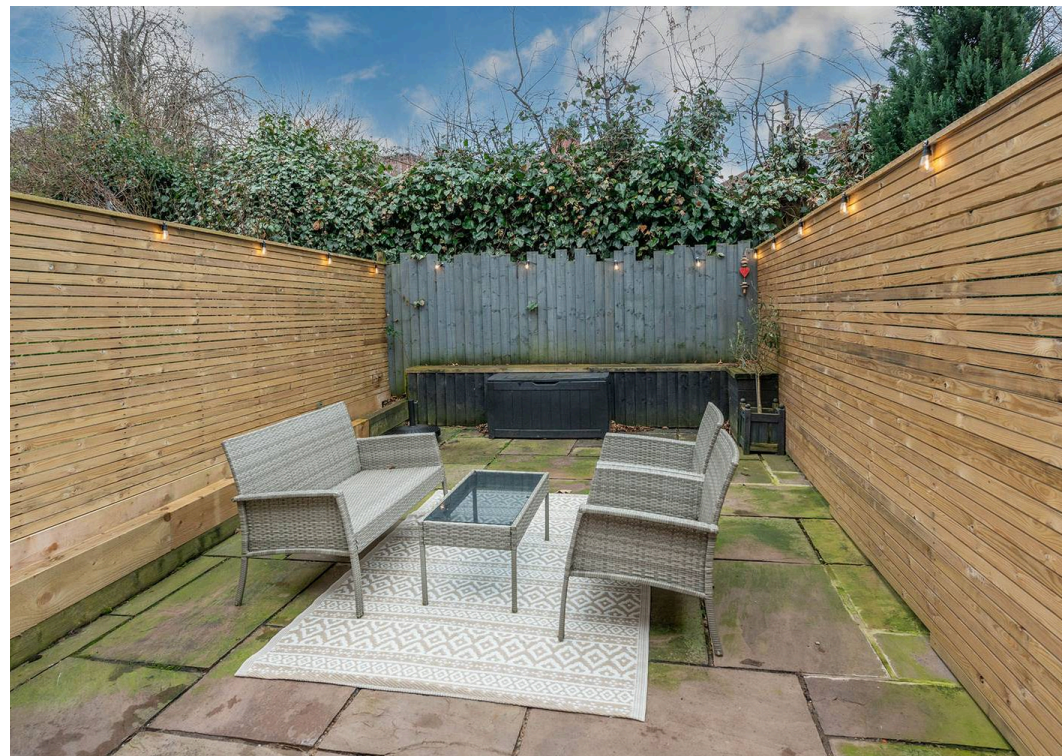
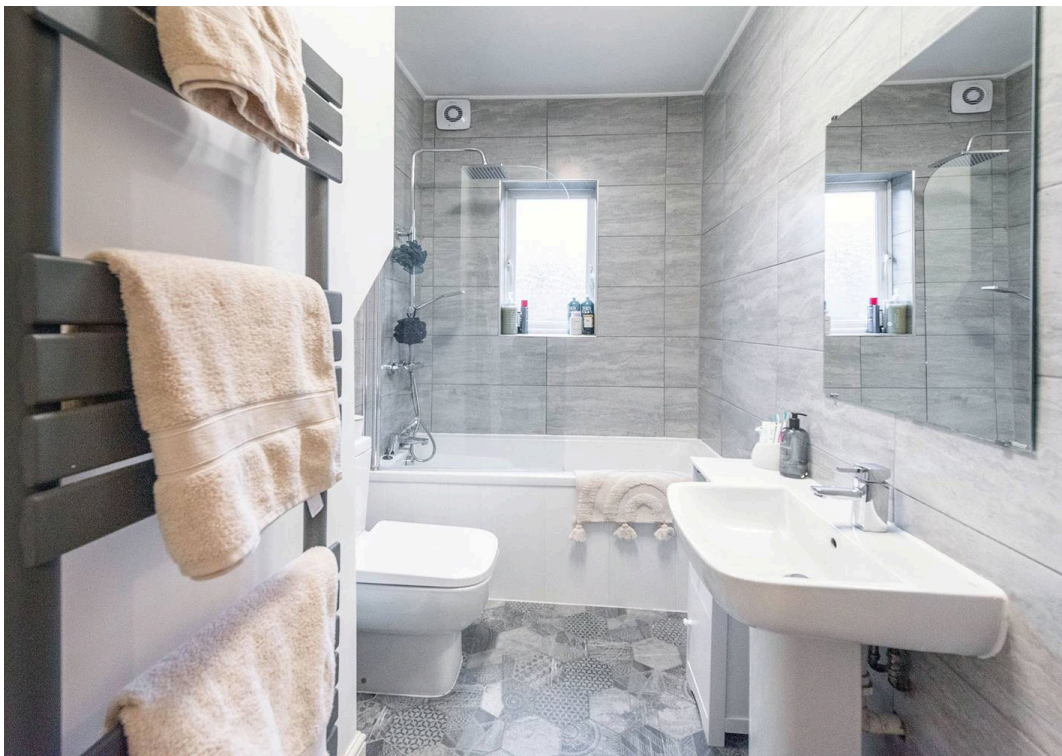

Ground Floor

Approx. 35.7 sq. metres (384.1 sq. feet)

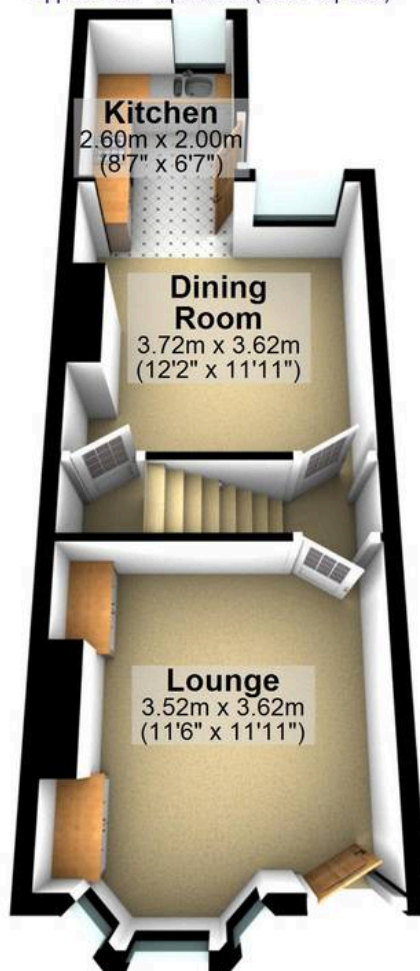

First Floor

Approx. 30.0 sq. metres (323.1 sq. feet)

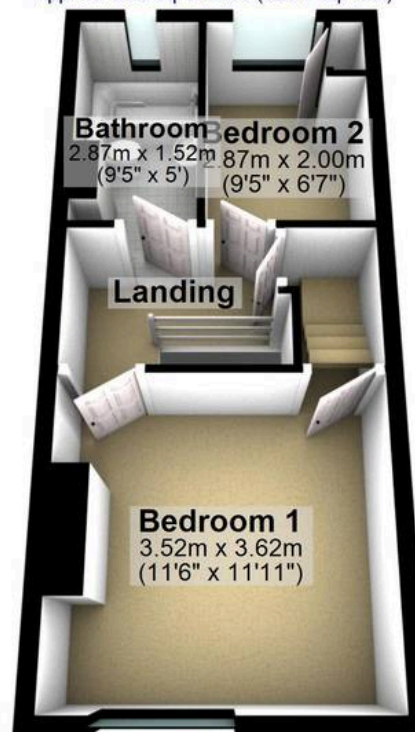

Second Floor

Approx. 19.5 sq. metres (209.5 sq. feet)

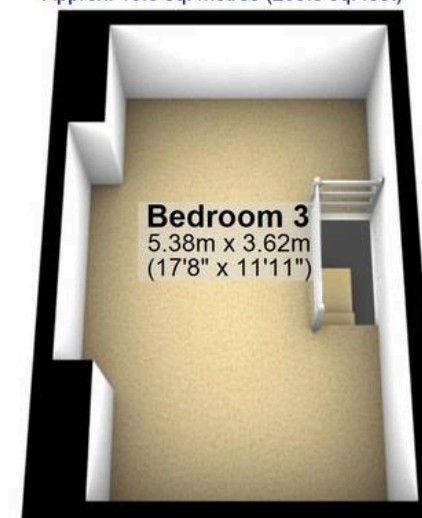

Cellar

Approx. 16.2 sq. metres (174.4 sq. feet)

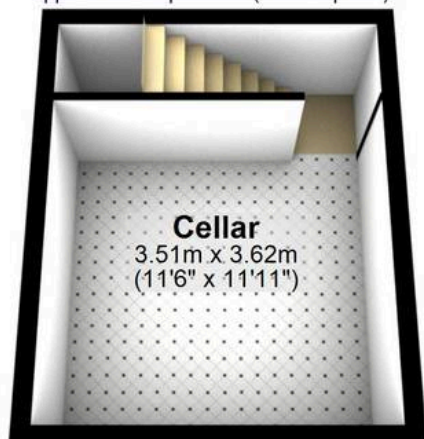

Total area: approx. 101.4 sq. metres (1091.0 sq. feet)

All measurements are approximate
Plan produced using PlanUp.