



WHITEHORNES

Buy. Sell. Let. Relax!

0114 268 8533
info@whitehornes.com
www.whitehornes.com

389 Gleadless Road, Gleadless

Sheffield

Offers in Region of £180,000

389 Gleadless Road

Gleadless, Sheffield

This lovely two double bedroom bay window semi-detached home offers fabulous views over the valley, providing a stunning backdrop. Situated in a sought-after area, this property is a perfectly ticking the boxes for those looking for their first home or for a young family. With no upward chain and vacant possession, this home is ready for its new owners to move right in. The property features an off-road driveway for two vehicles and a detached single garage, ensuring convenience and peace of mind for parking. The larger than expected rear private garden is a standout feature of this property, providing ample space and potential for further development subject to planning permission. This peaceful garden offers the opportunity to create additional accommodation, mirroring what neighbouring properties have done. The property's strategic location, set back from the main road yet close to numerous amenities, enhances its appeal within

Council Tax band: A Tenure: Leasehold

- LOVELY TWO DOUBLE BEDROOM BAY WINDOW SEMI DETACHED HOME
- FABULOUS VIEWS TO THE FRONT OVER THE VALLEY
- AVAILABLE TO MARKET WITH NO UPWARD CHAIN AND VACANT POSSESSION
- OFF ROAD DRIVEWAY FOR TWO VEHICLES AND DETACHED SINGLE GARAGE
- LARGER THAN EXPECTED REAR PRIVATE GARDEN
- OPPORTUNITY SUBJECT TO PLANNING TO CREATE ADDITIONAL ACCOMMODATION





Garage

Approx. 14.7 sq. metres (158.2 sq. feet)

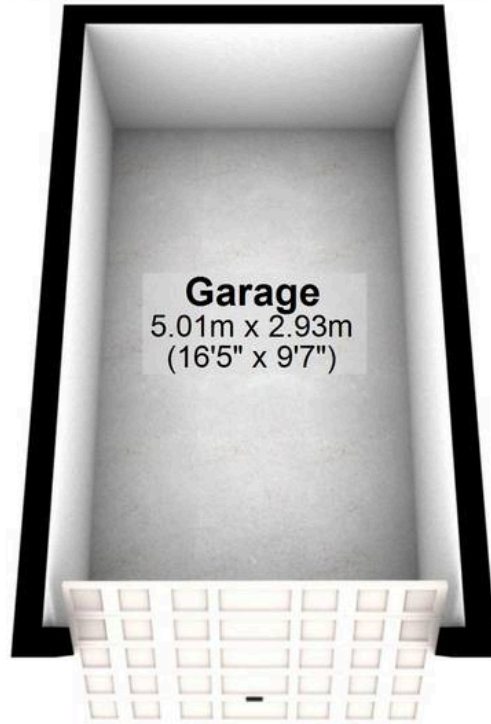

Ground Floor

Approx. 30.3 sq. metres (326.6 sq. feet)

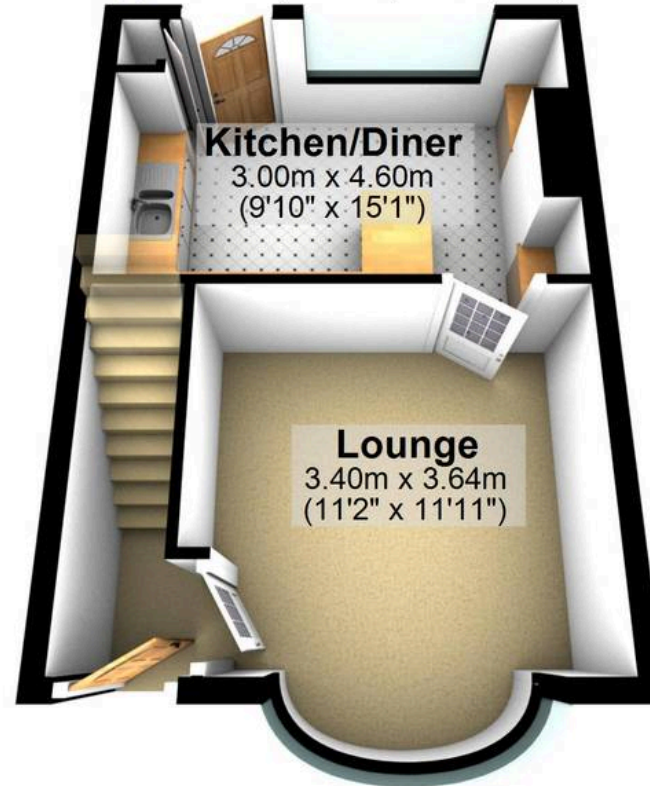

First Floor

Approx. 30.2 sq. metres (325.5 sq. feet)

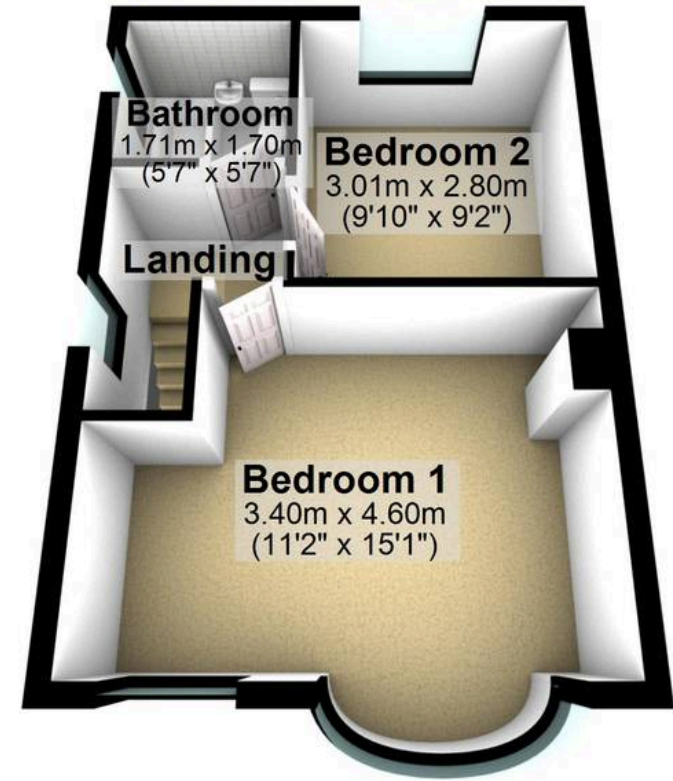

Total area: approx. 75.3 sq. metres (810.2 sq. feet)

All measurements are approximate
Plan produced using PlanUp.



WHITEHORNES

Buy. Sell. Let. Relax!

0114 268 8533
info@whitehorns.com
www.whitehorns.com