



**WHITEHORNES**

Buy. Sell. Let. Relax!

0114 268 8533  
info@whitehornes.com  
www.whitehornes.com

**2 The Glen, Endcliffe**

Sheffield

**Guide Price £325,000 - £335,000**



## 2 The Glen

### Endcliffe, Sheffield

An absolutely fabulous three double bedroomed, top floor apartment. Forming part of this highly sought after residential development in the very heart of ultra popular Endcliffe. The property enjoys a super light and spacious feel throughout and is one of the larger style properties that totals an impressive 1,050 sq feet. Enjoying a private balcony, accessed from the sitting room, with stunning views over the communal gardens and towards Endcliffe Park, private garage directly beneath the apartment and ample visitors parking bays. Offered to the open market with the benefit of no upward chain and vacant possession this apartment will be popular with the professional couple and those looking to downsize in equal measures. Located within a short stroll of fashionable Sharrow Vale and Ecclesall road that offer an array of independent cafes, eateries and shops. The Botanical Gardens, Endcliffe park and

Council Tax band: D Tenure: Leasehold

- FABULOUS THREE BEDROOM TOP FLOOR APARTMENT
- ONE OF THE LARGER STYLE APARTMENTS IN THIS SOUGHT AFTER DEVELOPMENT
- TOTAL NET INTERNAL SQUARE FOOTAGE OF 1,050 SQ FT EXCLUDING THE GARAGE
- INCREDIBLE FAR REACHING VIEWS OVER THE COMMUNAL GROUNDS AND ENDCLIFFE PARK
- INCREDIBLY SPACIOUS AND LIGHT THROUGHOUT WITH VIEWING ESSENTIAL
- HEART OF ULTRA POPULAR ENDCLIFFE WITH NUMEROUS AMENITIES HOSPITALS
- 









## Top Floor

Approx. 97.6 sq. metres (1050.2 sq. feet)

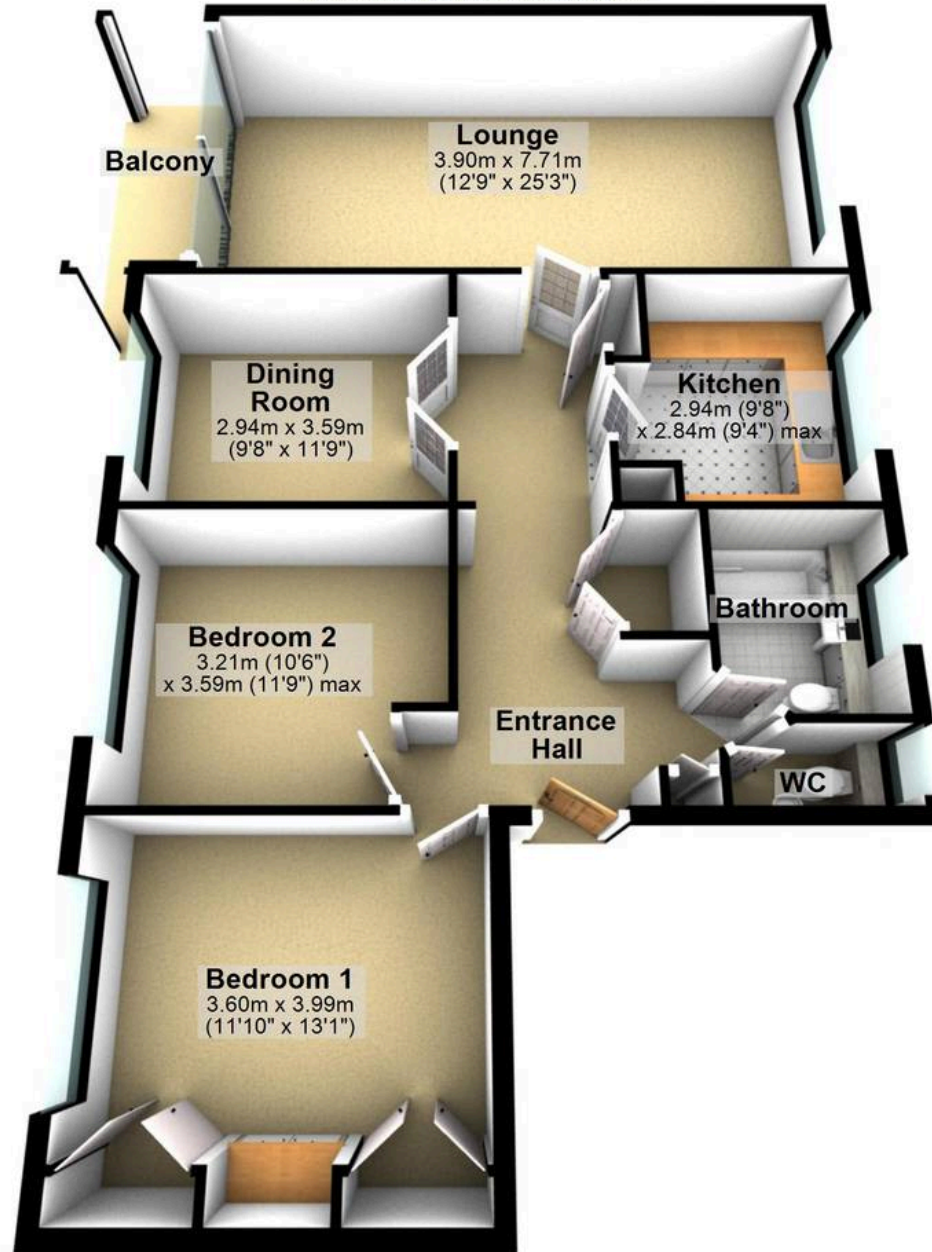

Total area: approx. 97.6 sq. metres (1050.2 sq. feet)

All measurements are approximate  
Plan produced using PlanUp.

  
**WHITEHORNES**  
Buy. Sell. Let. Relax!

0114 268 8533  
info@whitehornes.com  
www.whitehornes.com