



WHITEHORNES

Buy. Sell. Let. Relax!

0114 268 8533
info@whitehorns.com
www.whitehorns.com

17 Celandine Court, Bradway

Sheffield

Guide Price £200,000 - £210,000

17 Celandine Court

Bradway, Sheffield

An absolutely stunning one-bedroom semi-detached home, nestled in a quiet cul-de-sac at the heart of the highly sought-after Bradway. This unique property boasts a modern and stylish design that has been fully modernised and finished to an exceptional standard – truly a home where no expense has been spared. Upon entering, you are greeted by the unique internal layout that sets this property apart from the rest. The seamless flow between the living spaces creates a sense of openness and warmth. Ideal for a first-time buyer, professional couple, downsizer, or investor, this home offers versatile living. The property features a private rear garden parking to the front ensures convenience for residents and visitors alike. Boasting stunning views towards the golf course and beyond, this home offers a picturesque backdrop that enhances the overall appeal of the property. Council Tax band: B Tenure: Leasehold

- STUNNING ONE DOUBLE BEDROOM SEMI DETACHED HOME
- QUIET TUCKED AWAY POSITION ON THIS NO THROUGH CUL DE SAC
- OFFERING IN OUR OPINION THE BEST POSITION ON THE DEVELOPMENT WITH AN EXCEPTIONAL PRIVATE GARDEN
- ALLOCATED PARKING BAY TO THE FRONT
- HEART OF ULTRA POPULAR BRADWAY ON THE SOUTH WEST OF THE CITY
- PEAK DISTRICT LITERALLY ON THE DOORSTEP
- PERFECT FOR THE PROFESSIONAL COUPLE DOWNSIZE OR INVESTOR
- VIEWING ESSENTIAL TO DO FULL JUSTICE
- FINISHED INTERNALLY TO A VERY HIGH STANDARD BY THE CURRENT VENDORS





Ground Floor

Approx. 26.8 sq. metres (288.5 sq. feet)

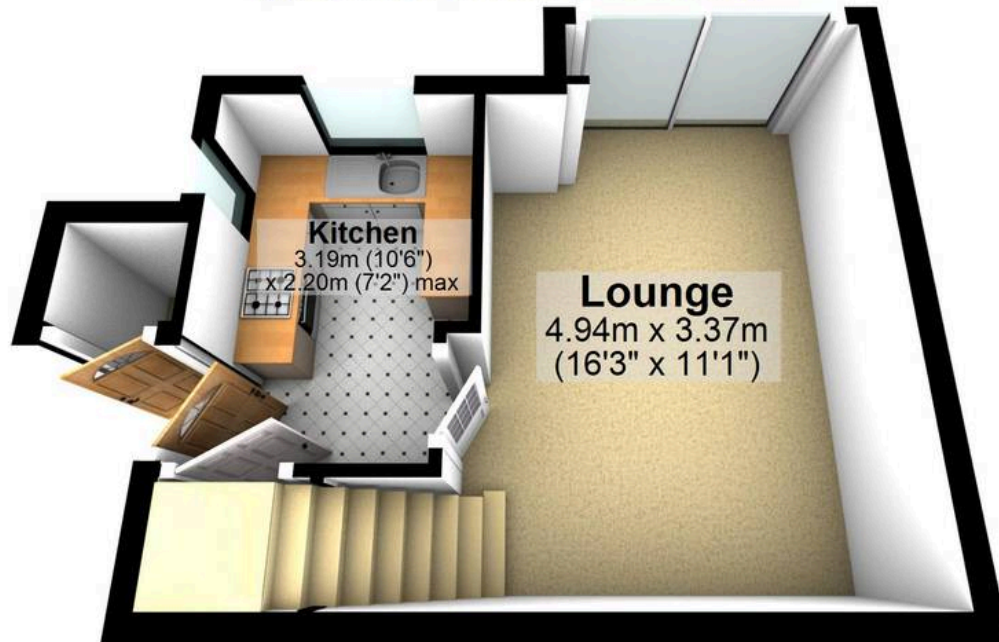

First Floor

Approx. 23.6 sq. metres (253.7 sq. feet)

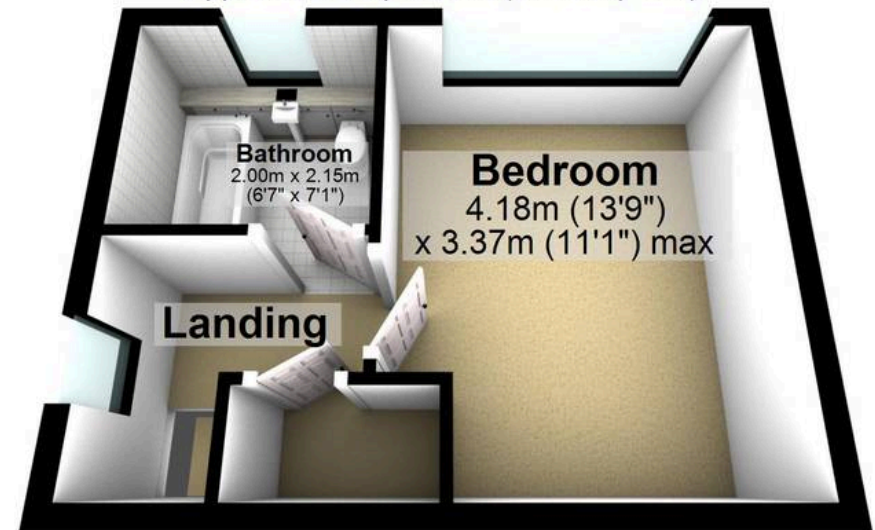

Total area: approx. 50.4 sq. metres (542.3 sq. feet)

All measurements are approximate
Plan produced using PlanUp.



WHITEHORNES

Buy. Sell. Let. Relax!

0114 268 8533
info@whitehorns.com
www.whitehorns.com