



WHITEHORNES

Buy. Sell. Let. Relax!

0114 268 8533
info@whitehorns.com
www.whitehorns.com

26 Osborne Mews, Nether Edge

Sheffield

Guide Price **£235,000**

26 Osborne Mews

Nether Edge, Sheffield

Presenting this superb two bedroomed, second floor, apartment totaling an impressive 715 sq ft of bright and light accommodation. In brief, this apartment consists of an entrance hall, open plan kitchen/diner/living room, two double bedrooms, a bathroom and en-suite. Quietly tucked away on this prestigious residential development in the very heart of ultra popular Nether Edge the property benefits from full use of the onsite swimming pool and gymnasium and use of the numerous communal garden spaces. With its own private allocated parking bay, this luxury apartment will be incredibly popular with the professional couple and those looking to downsize equally and simply must be viewed internally to be fully appreciated. Located within a short stroll of both fashionable Sharrow Vale and Nether Edge that offer an array of independent cafes, eateries and shops. Chelsea park is round the corner and not forgetting The Peak District is on the doorstep.

Council Tax band: C

Tenure: Leasehold

- STUNNING TWO DOUBLE BEDROOMED SECOND FLOOR APARTMENT
- SUPERB GATED RESIDENTIAL DEVELOPMENT IN THE HEART OF NETHER EDGE
- USE OF THE ON SITE SWIMMING POOL AND GYMNASIUM
- VIEWING ABSOLUTELY ESSENTIAL TO DO FULL JUSTICE TO THE SIZE AND STYLE ON OFFER
- CHELSEA PARK HOSPITALS AND UNIVERSITIES ALL CLOSE BY AS IS THE PEAK DISTRICT
- PERFECT FOR THE PROFESSIONAL COUPLE OR THOSE LOOKING TO DOWNSIZE





Second Floor

Approx. 66.5 sq. metres (715.9 sq. feet)

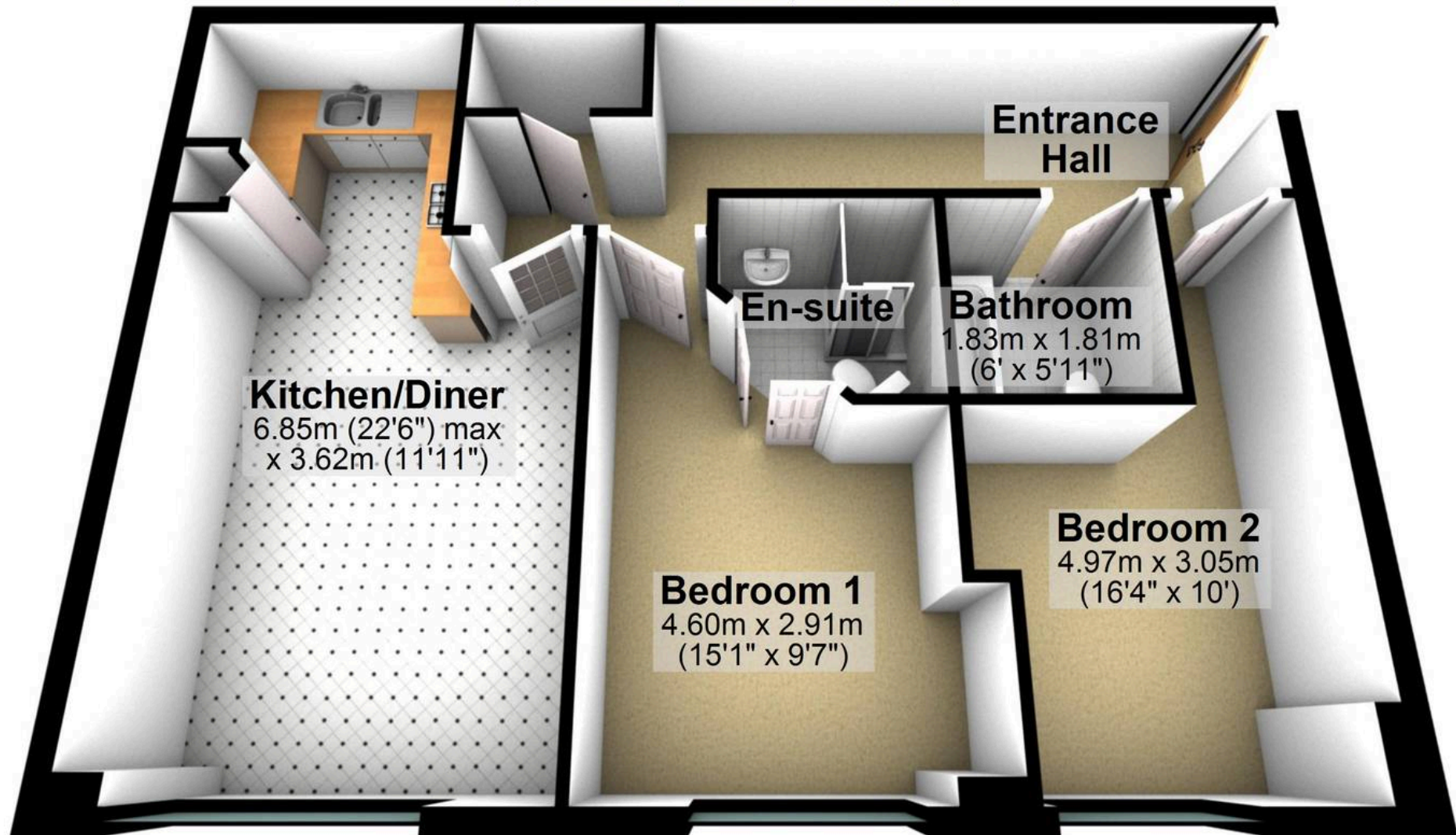

Total area: approx. 66.5 sq. metres (715.9 sq. feet)

All measurements are approximate
Plan produced using PlanUp.