



WHITEHORNS
Buy. Sell. Let. Relax!
0114 268 8533
info@whitehorns.com
www.whitehorns.com

Chestnut Court, 55 Union Road, Brincliffe
Sheffield

Guide Price £215,000 - £225,000

Chestnut Court, 55 Union Road

Brincliffe, Sheffield

Apartment fourteen is a wonderful ground floor two double bed roomed, two bathroomed apartment in this private and exclusive gated development. Located in the very heart of one of Sheffield's most sought after residential suburbs of Brincliffe on the south west of the city. With fashionable Nether Edge village feel center and Abbeydale road a short stroll that boast an array of independent, cafes, eateries and shops, central Sheffield is on the doorstep as is Chelsea park and don't forget The Peak District is up the road. Offered to the open market with the benefit of no upward chain and vacant possession this wonderful property is pitch perfect for the professional couple, those looking to downsize or the first time buyer. Briefly consists of entrance hallway, large and bright open plan living space with ample space for a dining table, fitted kitchen with a range of integrated appliances.

Council Tax band: C Tenure: Leasehold

- FABULOUS TWO DOUBLE BEDROOM TWO BATHROOM GROUND FLOOR APARTMENT
- SECURE ALLOCATED PARKING BAY AND VISITOR SPACES ALSO AVAILABLE
- HEART OF ULTRA POPULAR BRINCLIFFE ON THE SOUTH WEST OF THE CITY
- AVAILABLE TO MARKET WITH NO UPWARD CHAIN AND VACANT POSSESSION
- PERFECT FOR THE FIRST BUY PROFESSIONAL COUPLE OR THOSE LOOKING TO DOWN-SIZE
- VIEWING IS ABSOLUTELY ESSENTIAL







WHITEHORNES

Buy. Sell. Let. Relax!

0114 268 8533
info@whitehorns.com
www.whitehorns.com

Ground Floor

Approx. 71.3 sq. metres (767.2 sq. feet)

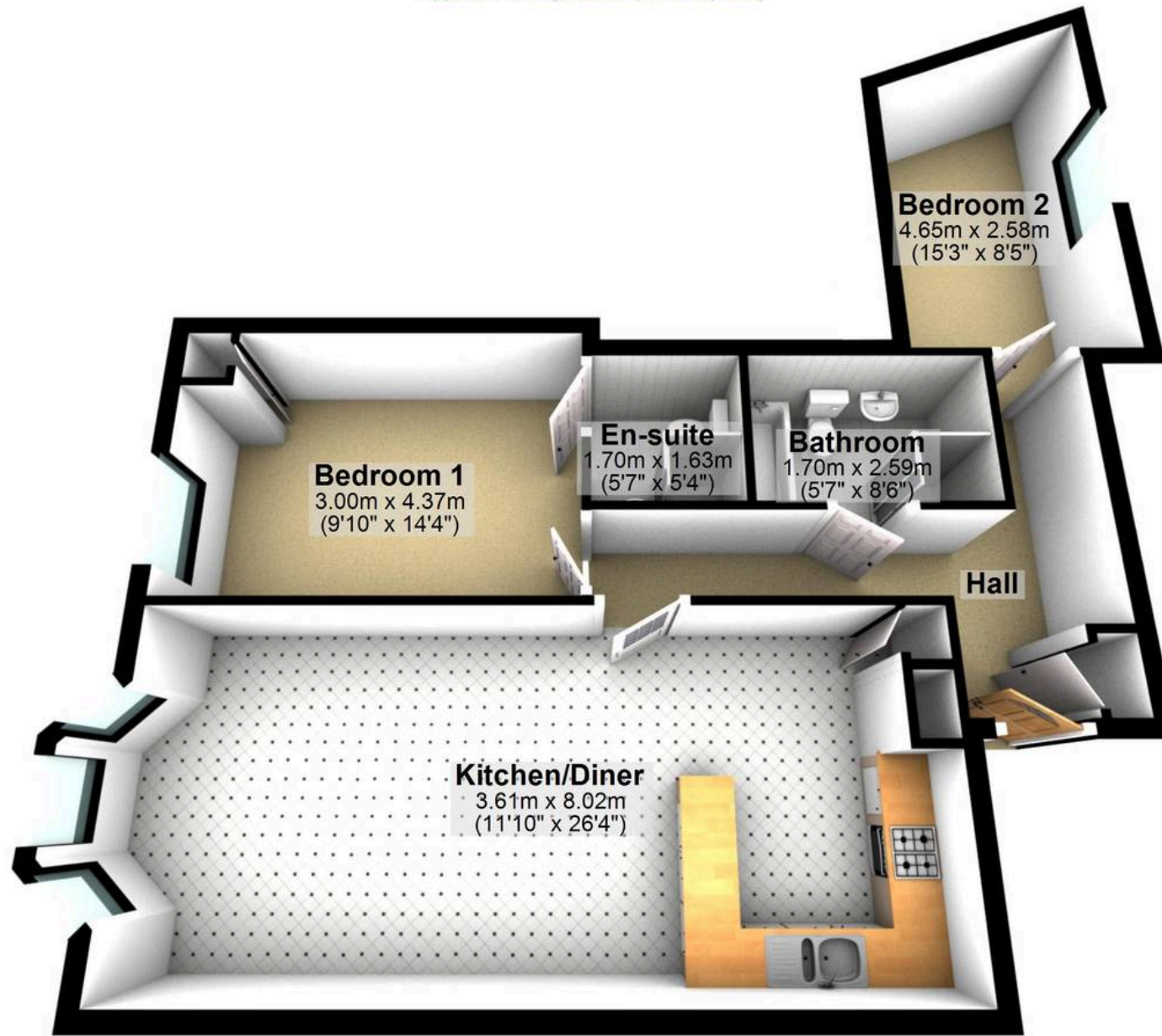

Total area: approx. 71.3 sq. metres (767.2 sq. feet)

All measurements are approximate
Plan produced using PlanUp.