



WHITEHORNES

Buy. Sell. Let. Relax!

0114 268 8533
info@whitehorns.com
www.whitehorns.com



Flat 6, Parkview Court, 145 Cobnar Road

Sheffield

Guide Price **£140,000**

Flat 6

Parkview Court, Sheffield

GUIDE PRICE £150,000-£160,000 A absolutely stunning, immaculately presented and very deceptive, fabulous one double bedroom ground floor apartment. Offering in our opinion one of the best positions with views over Graves park the apartment is perfect for the professional couple, first time buyers or those looking to downsize. Its easy to say that viewing is essential to fully appreciate style of this wonderful property. With ample visitor spaces in the communal car park. Quietly tucked away on this little known road and forming part of this well regarded residential development within the very heart of popular Norton. With a wealth of local amenities close by as well as great public transport links and Graves Park within easy walking distance. Offering spacious, light and well appointed accommodation that has undergone a full internal transformation by the current vendor since Council Tax band: A

Tenure: Leasehold

- EXCELLENT ONE DOUBLE BEDROOM GROUND FLOOR APARTMENT
- QUIETLY TUCKED AWAY ON THIS PRIVATE DEVELOPMENT WITH VIEWS ACROSS TO GRAVES PARK
- PERFECT FOR THOSE LOOKING TO DOWNSIZE OR THE PROFESSIONAL COUPLE
- AMPLE PARKING IN THE COMMUNAL CAR PARK
- EASY ACCESS TO NUMEROUS LOCAL AMENITIES AND GREAT PUBLIC TRANSPORT LINKS
- RECENTLY FINISHED INTERNALLY TO A SUPER HIGH STANDARD BY THE CURRENT VENDOR
- GRAVES PARK ENTRANCE LITERALLY A FES STRIDES FROM THE FRONT DOOR





Ground Floor

Approx. 47.4 sq. metres (510.6 sq. feet)

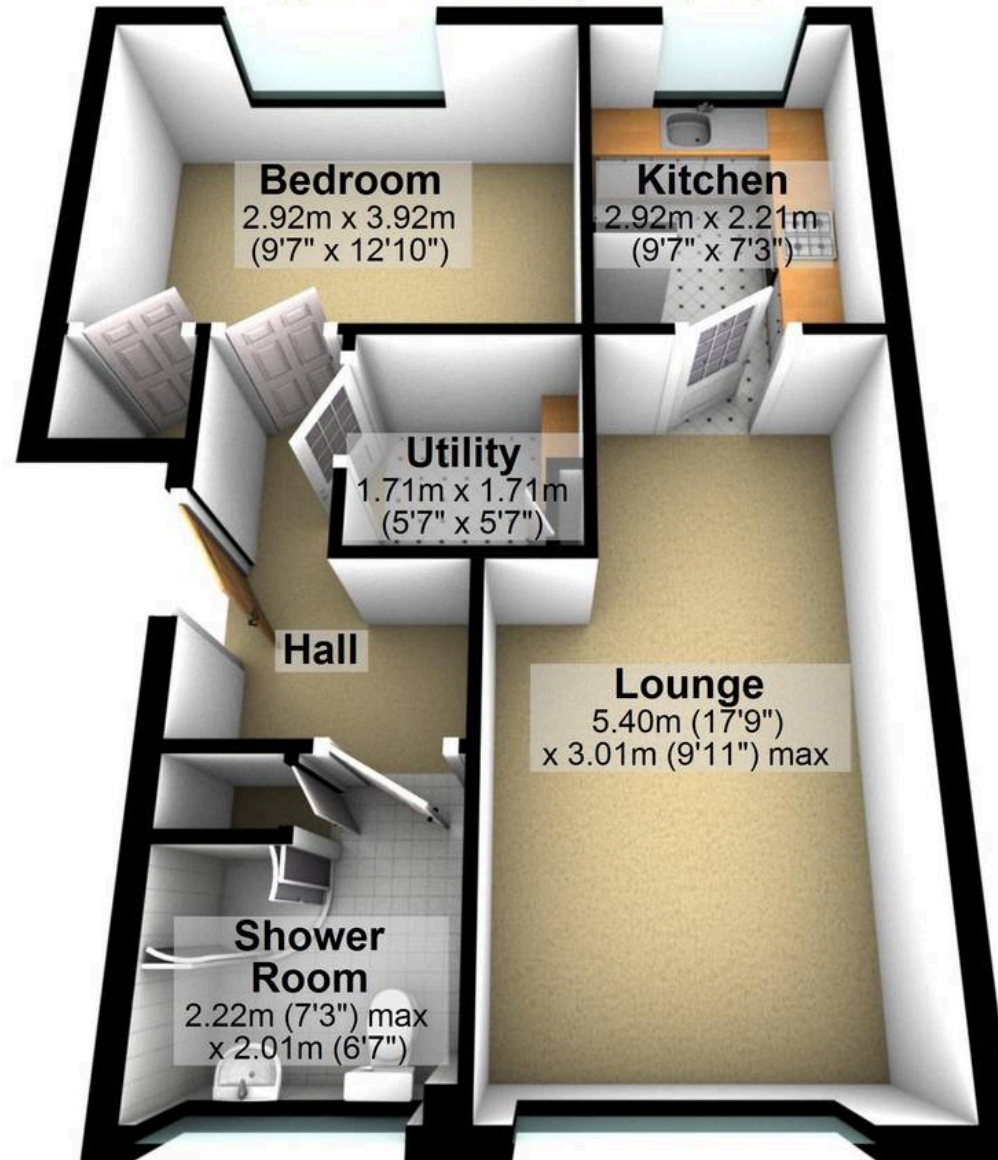

Total area: approx. 47.4 sq. metres (510.6 sq. feet)

All measurements are approximate
Plan produced using PlanUp.



WHITEHORNES

Buy. Sell. Let. Relax!

0114 268 8533
info@whitehorns.com
www.whitehorns.com