



**WHITEHORNES**  
Buy. Sell. Let. Relax!  
0114 268 8533  
info@whitehorns.com  
www.whitehorns.com



**9 School Lane, Stannington**  
Sheffield

Guide Price £250,000 - £260,000



# 9 School Lane

Stannington, Sheffield

An absolutely fabulous two bedroom picture postcard perfect, stone built cottage. Stopped in local history and dating back to the 1600's this beautiful property is pitch perfect for the young professionals, first time buyers or those looking to downsize in equal measures. Enjoying some truly spectacular views over the valley to the front, sizeable front garden and off road allocated parking space it's easy to say that viewing is absolutely essential to fully appreciate this stunning cottage. With a log burner to the front sitting room, dining rear fitted kitchen and porch to the ground floor. To the first floor are two spacious and light bedrooms together with a three piece bathroom suite. Quietly tucked away from the road in this peaceful setting within the very heart of ultra popular Stannington, close to numerous local amenities, the open countryside and The Peak District.

Council Tax band: B Tenure: Freehold

- STUNNING TWO BEDROOM PERIOD STONE BUILT CHARACTER COTTAGE
- DATING BACK TO THE 1600'S AND RETAINING AWEALTH THE ORIGONAL PERIOD CHARACTER AND CHARM
- FABULOUS VIEWS OVER THE VALLEY TO THE FRONT AND ALLOCATED PARKING SPACE FOR ONE VEHICLE
- PEREFCT FOR THE PROFESSIONAL COUPLE FIRST BUY OR THOSE LOOKING TO DOWN SIZE
- LOG BURNING STOVE TO THE FRONT SITTING ROOM AND DINING FITTED KITCHEN
- TWO GOOD SIZED BEDROOMS TO THE FIRST FLOOR









## Ground Floor

Approx. 25.4 sq. metres (273.9 sq. feet)

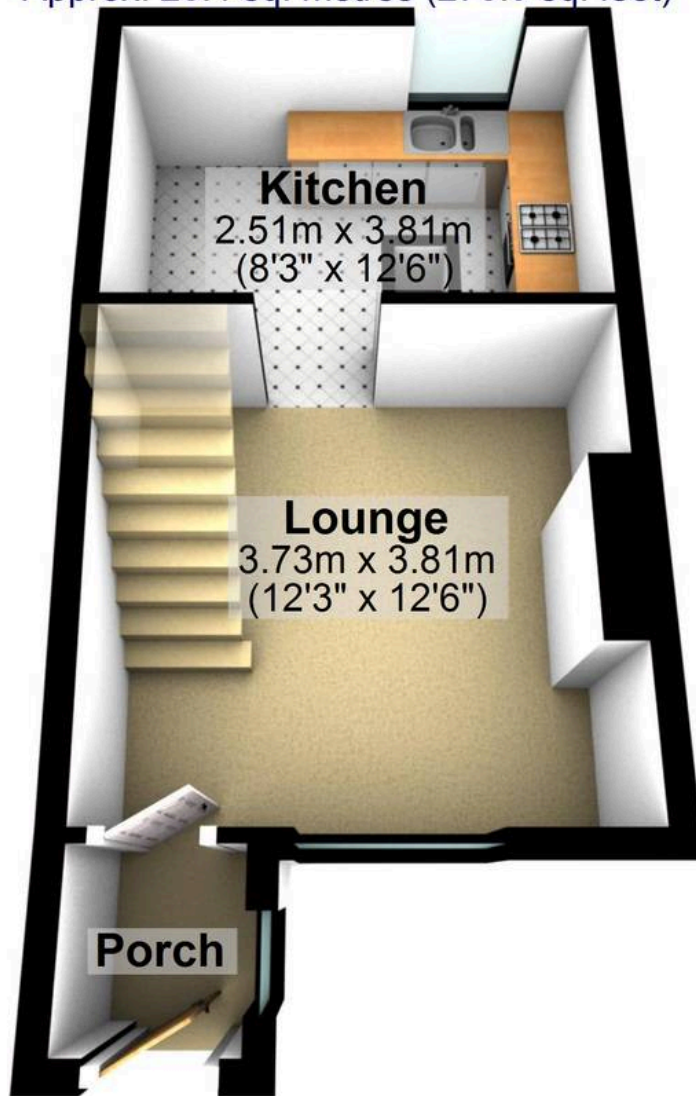

## First Floor

Approx. 24.1 sq. metres (259.9 sq. feet)

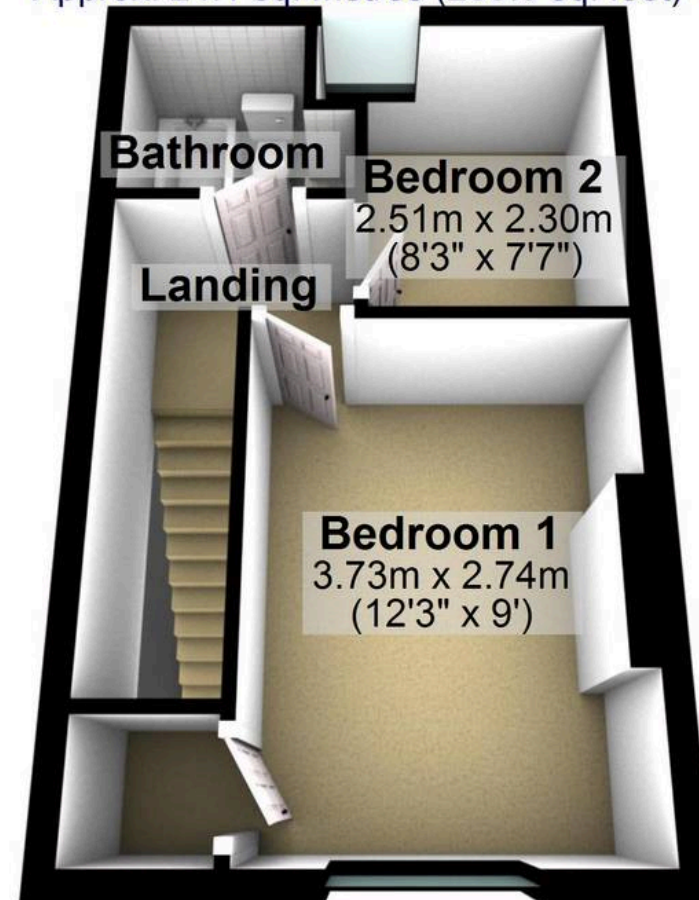

Total area: approx. 49.6 sq. metres (533.8 sq. feet)

All measurements are approximate  
Plan produced using PlanUp.



**WHITEHORNES**

Buy. Sell. Let. Relax!

0114 268 8533  
info@whitehorns.com  
www.whitehorns.com