



WHITEHORNES

Buy. Sell. Let. Relax!

0114 268 8533
info@whitehorses.com
www.whitehorses.com

99 South View Crescent, Nether Edge

Sheffield

Guide Price £240,000 - £250,000

99 South View Crescent

Nether Edge, Sheffield

An absolutely stunning, beautifully presented and very deceptive three bedroomed, bay windowed Victorian terraced. With an off shot kitchen that flows through to a dining room that not only incorporates a central island but has recently been upgraded with additional wall and base units to give a more open plan and contemporary vibe. There is a lovely private rear garden that benefits from no through fare from neighbouring properties this property will be incredibly popular with the professional couple, first time buyer and young family alike. Retaining numerous period features, character and charm associated with a property from this era and effortlessly combining a contemporary finish including a newly installed, white three piece bathroom suite. With 1,048 sq feet of accommodation across three light and spacious floors, it's easy to say that viewing is absolutely essential to do full justice.

Council Tax band: A Tenure: Leasehold

- STUNNING THREE BEDROOM BAY WINDOWED VICTORIAN TERRACED
- RECENTLY INSTALLED ADDITIONAL CUPBOARDS TO THE DINING ARE MAKING AN OPEN PLAN VIBE TO THE OFF SHOT KITCHEN
- NEWLY INSTALLED THREE PIECE WHITE BATHROOM SUITE TO THE FIRST FLOOR
- THREE FLOORS OF ACCOMMODATION THAT TOTAL AN IMPRESSIVE 1,048 SQ FEET
- QUIET HORSE SHOE ROAD IN THE HEART OF THIS INCREDIBLY POPULAR SUBURB OF S7
- CLOSE TO FASHIONABLE ABBEYDALE ROAD AND NETHER EDGE VILLAGE FEEL CENTRE
- AVAILABLE TO MARKET WITH NO UPWARD CHAIN AND VIEWING ESSENTIAL TO DO FULL JUSTICE





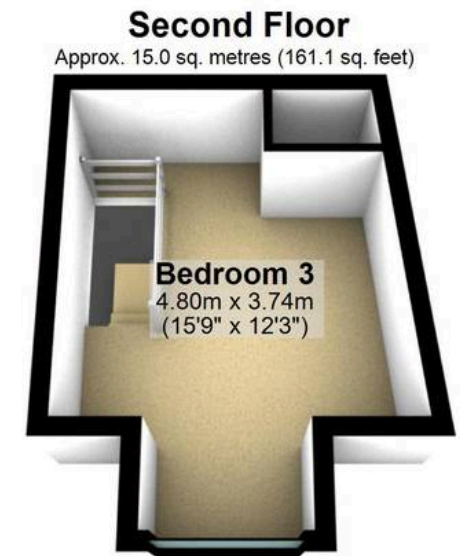
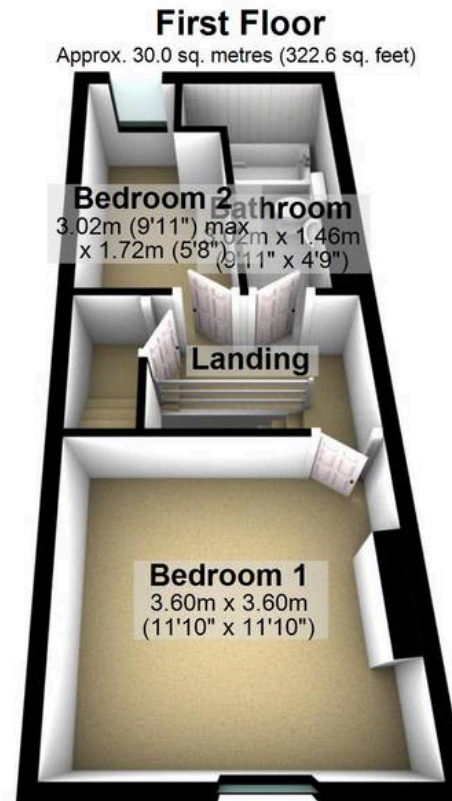
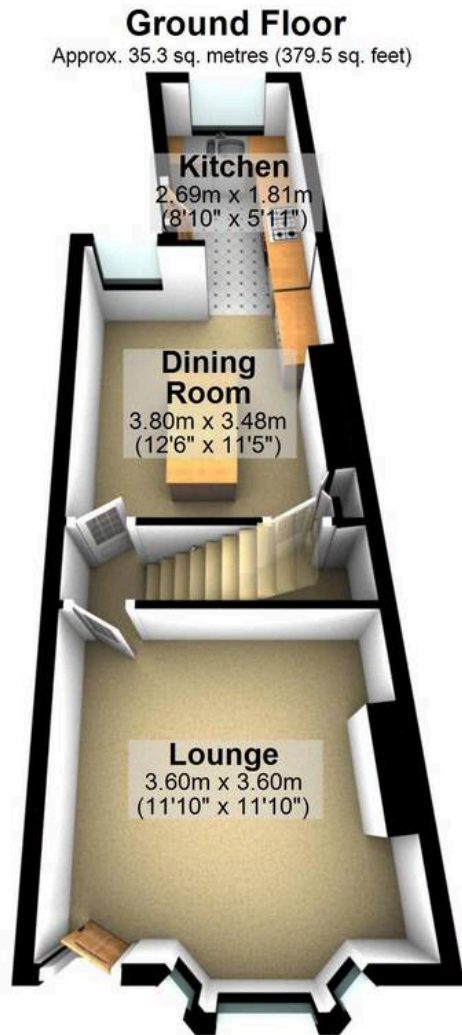
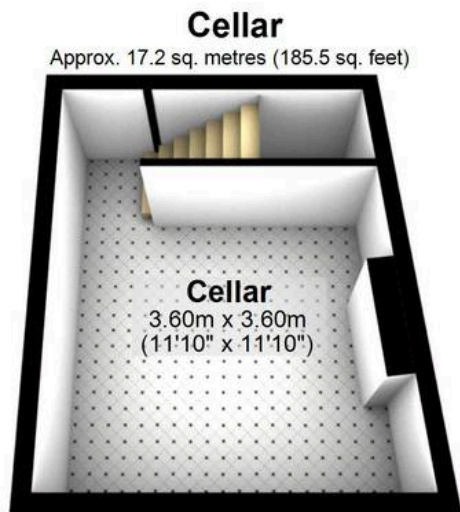

Total area: approx. 97.4 sq. metres (1048.7 sq. feet)

All measurements are approximate
Plan produced using PlanUp.