



WHITEHORNS
Buy. Sell. Let. Relax!
0114 268 8533
info@whitehorns.com
www.whitehorns.com

330 Carter Knowle Road, Ecclesall

Sheffield

Guide Price £465,000 - £475,000

330 Carter Knowle Road

Ecclesall, Sheffield

An incredibly rare opportunity has arisen to purchase this fabulous three good sized bedroom, bay window, semi-detached home. Enjoying an incredible backdrop over Brincliffe and beyond from an elevated position this beautiful family home has three spacious, light and versatile floors of accommodation, totalling 1,844 sq feet, with a converted basement. Offering one of the largest rear private gardens on the road together with a driveway and single garage to the front, this beautiful property will be popular with the growing family market looking for a forever home and simply must be viewed to be fully appreciated. Allowing future scope to further extend the existing property (subject to planning) as neighbouring properties have done so to the side and loft to create additional accommodation if required. Located towards the top of this well regarded residential road within the heart of Ecclesall.

Council Tax band: D Tenure: Leasehold

- FABULOUS THREE GOOD SIZED BEDROOM DOUBLE BAY WINDOW SEMI DETACHED HOME
- FRENCH DOOR ACCESS TO A WONDERFUL PRIVATE BALCONY THAT ENJOYS GREAT VIEWS
- HUGE OPPORTUNITY TO FULLY CONVERT THE EXISTING BASEMENT TO ADD FUTURE VALUE AND INCREASE INTERNAL SPACE
- STUNNING VIEWS TO THE REAR OVER BRINCLIFFE EDGE AND BEYOND
- OFF ROAD PARKING TO THE FRONT AND TRULY IMPRESSIVE REAR SIZEABLE PRIVATE FAMILY GARDEN





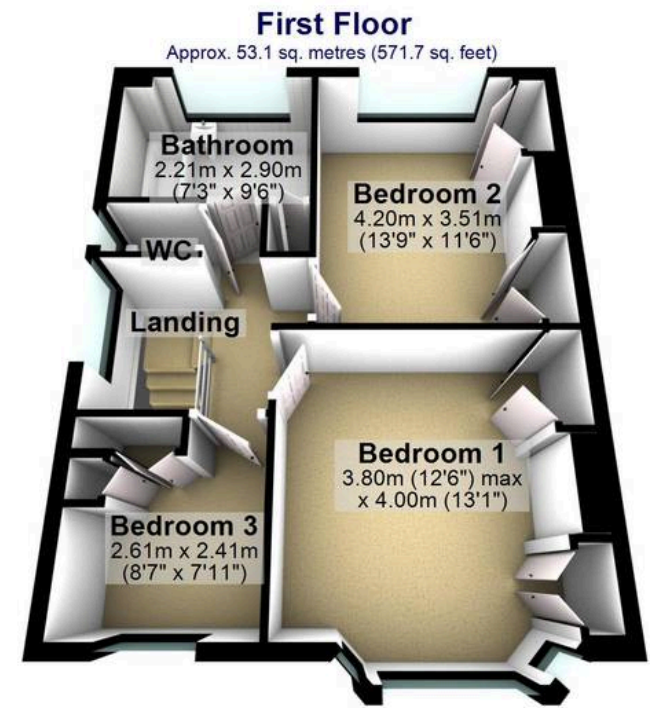
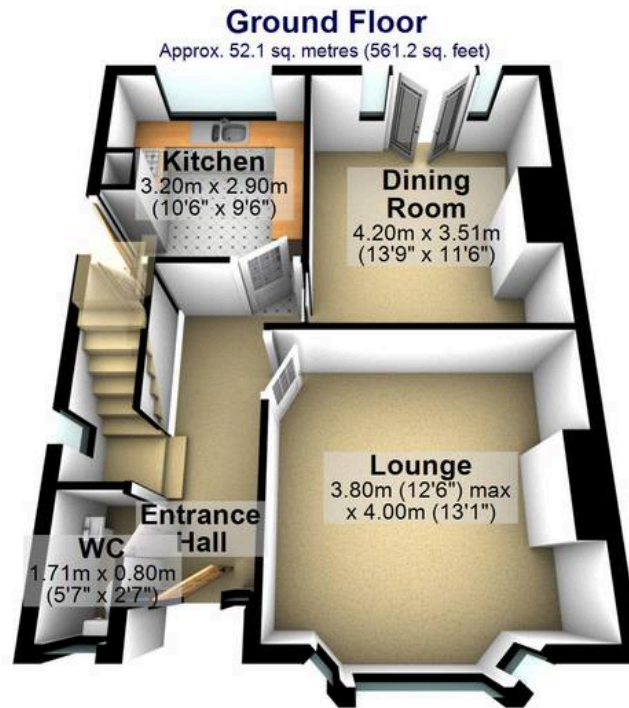
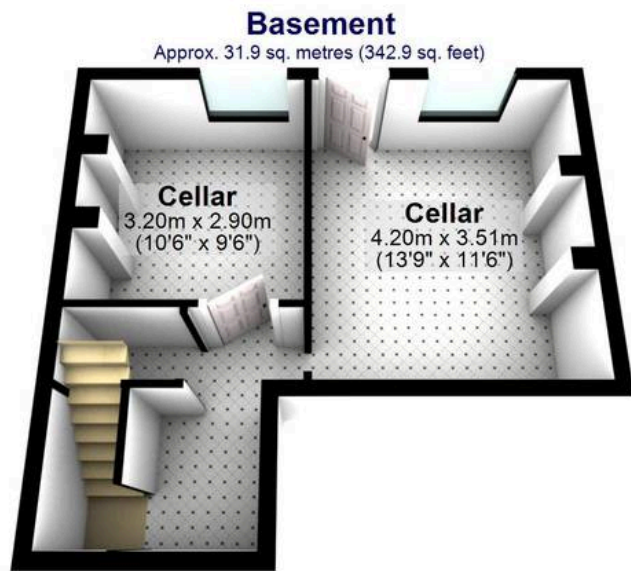

Total area: approx. 137.1 sq. metres (1475.8 sq. feet)

All measurements are approximate
Plan produced using PlanUp.