



**WHITEHORNES**

Buy. Sell. Let. Relax!

0114 268 8533  
info@whitehorses.com  
www.whitehorses.com

**78 Thorpe House Rise, Norton Lees**

Sheffield

Guide Price **£330,000**



# 78 Thorpe House Rise

Norton Lees, Sheffield

A great opportunity has arisen to purchase this fabulous, three bedroomed extended semi detached family home. Located on this incredibly well sought after, quiet residential road in the very heart of this ultra popular suburb of Norton Lees, number 78 falls within catchment of excellent local schools including Mundella Primary School and Newfield Secondary School, numerous amenities are on the doorstep and picturesque Graves park is a short stroll away. In brief this light and bright property consists of, an open plan kitchen and dining room, spacious living room, two double bedrooms, a single bedroom and family bathroom. To the outside is a fantastic, private south west facing rear garden and convenient off road parking via the driveway and garage located with gated access directly to Warminster Road, it's easy to say that viewing is essential to do full justice to this wonderful home.

Council Tax band: B

Tenure: Leasehold

- THREE BEDROOM ONE BEDROOM SEMI-DETACHED FAMILY HOME
- LARGE EXTENSION TO THE REAR
- OFF ROAD PARKING
- CLOSE TO GRAVES PARK
- PERFECT FAMILY HOME
- GREAT PUBLIC TRANSPORT LINKS
- REPUTABLE LOCAL SCHOOLS
- LARGE PRIVATE REAR GARDEN
- LIGHT AND BRIGHT ACCOMMODATION
- FREEHOLD PROPERTY AND COUNCIL TAX BAND B









### Garage

Approx. 14.1 sq. metres (151.5 sq. feet)

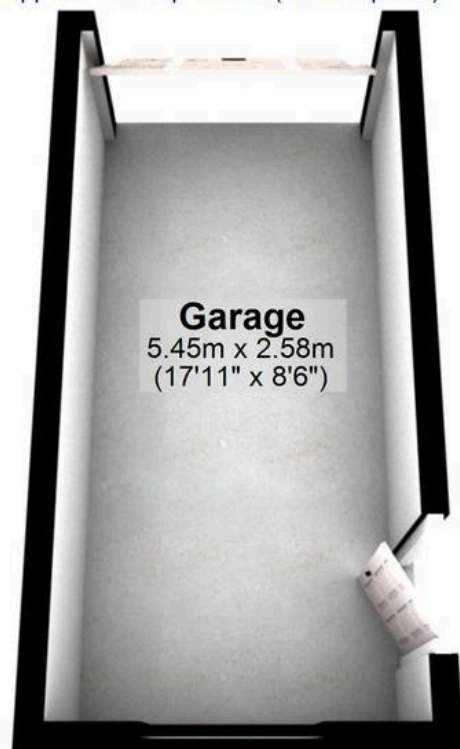

### Ground Floor

Approx. 44.0 sq. metres (473.6 sq. feet)

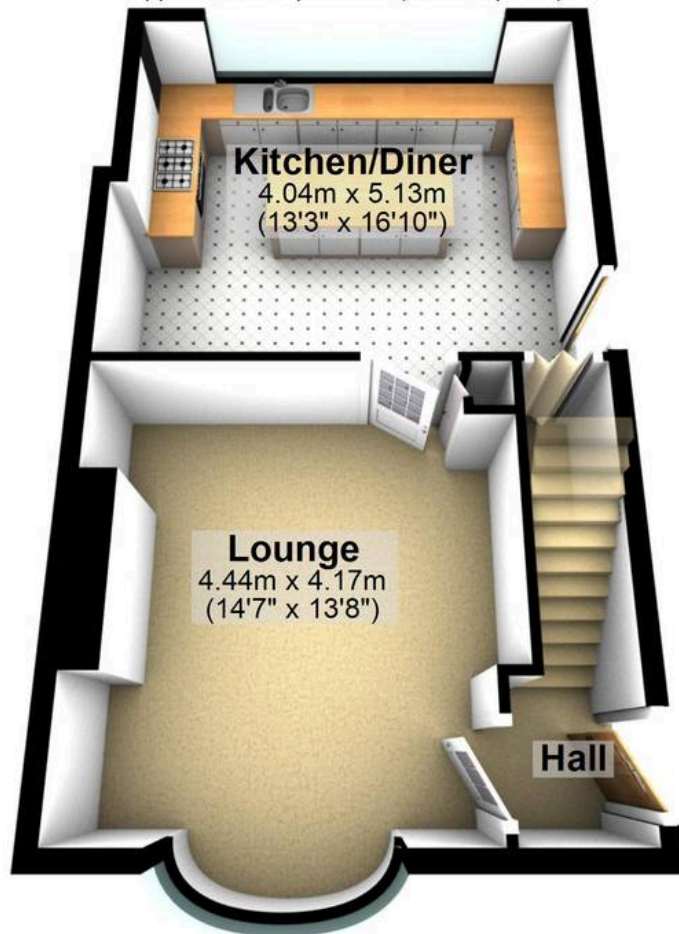

### First Floor

Approx. 43.7 sq. metres (470.4 sq. feet)

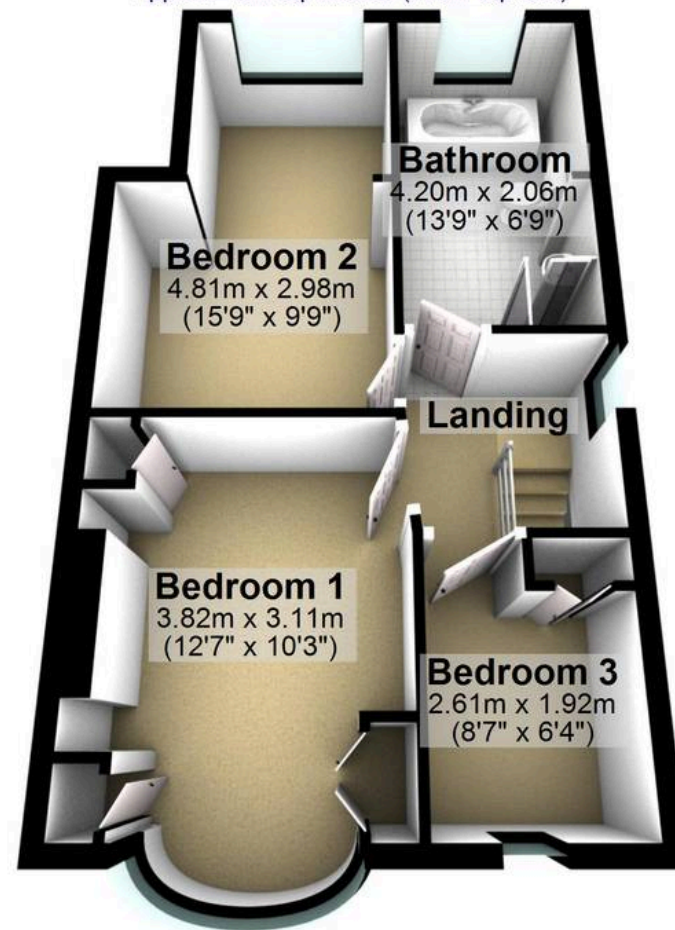

Total area: approx. 101.8 sq. metres (1095.5 sq. feet)

All measurements are approximate  
Plan produced using PlanUp.



**WHITEHORSES**

Buy. Sell. Let. Relax!

0114 268 8533  
info@whitehorses.com  
www.whitehorses.com