



76b, Osborne Road, Nether Edge
Sheffield

Guide Price £750,000-£775,000

76b, Osborne Road

Nether Edge, Sheffield

An absolutely outstanding, immaculately presented and very deceptive residence in the heart of Nether Edge/Brincliffe, this stunning four double bedroom, three bathroom detached stone-built property is a true masterpiece of architectural design and modern luxury. Constructed in 2020, this home exudes sophistication and stylish design throughout. Boasting an open-plan living and dining area with a bespoke fitted kitchen offering seamless access to the beautifully landscaped private garden. Designed to emulate the charm of a traditional Victorian residence while showcasing a contemporary finish, this property is a seamless blend of classic and modern aesthetics. With meticulous attention to detail evident throughout and no expense spared, the property offers a rare opportunity for the growing family looking for a high-spec, turnkey home in a prime location.

Council Tax band: E Tenure: Freehold

- STUNNING FOUR DOUBLE BEDROOM THREE BATHROOM DETACHED STONE BUILT PROPERTY
- ARCHITECT DESIGNED AND BUILT TO THE HIGHEST SPECIFICATION AND CONSTRUCTED IN 2020
- OPEN PLAN CONTEMPORARY LIVING DINING FITTED BESPOKE KITCHEN WITH GARDEN ACCESS
- DESIGNED TO MIMIC A TRADITIONAL VICTORIAN RESIDENCE BUT WITH THE BENEFIT OF A MODERN FINISH
- FINISHED THROUGHOUT WITH ATTENTION TO DETAIL AND WITH NO EXPENSE SPARED
- HEART OF ULTRA POPULAR NETHER EDGE





Ground Floor

Approx. 51.9 sq. metres (558.3 sq. feet)

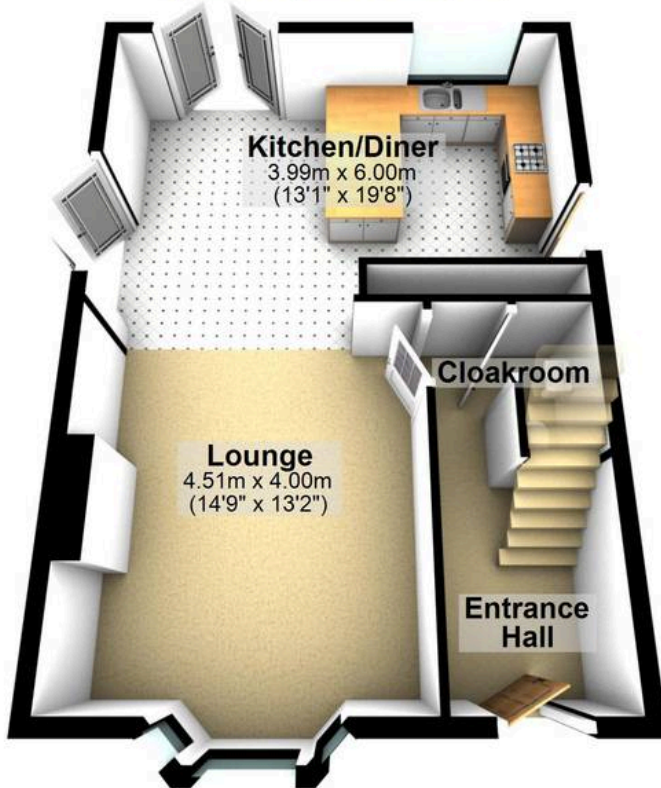

First Floor

Approx. 51.6 sq. metres (555.5 sq. feet)

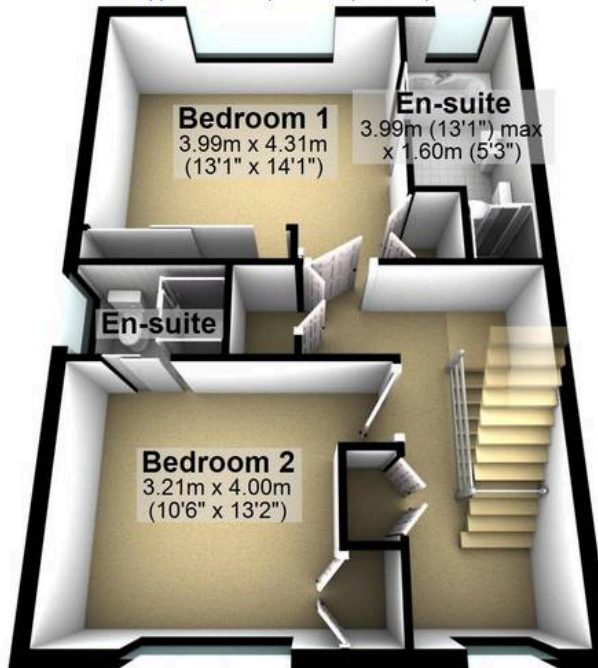

Second Floor

Approx. 52.3 sq. metres (562.9 sq. feet)

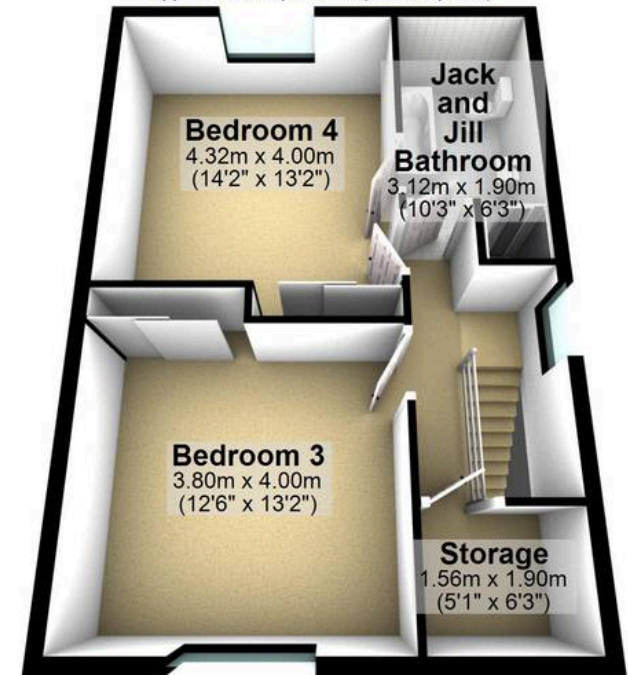

Total area: approx. 155.8 sq. metres (1676.7 sq. feet)

All measurements are approximate
Plan produced using PlanUp.



WHITEHORNES

Buy. Sell. Let. Relax!

0114 268 8533
info@whitehorses.com
www.whitehorses.com