

41 Fitzwilliam Court, Bartin Close, Ecclesall

Sheffield

Guide Price £115,000-£120,000



# 41 Fitzwilliam Court, Bartin Close

Ecclesall, Sheffield

Forming part of this superb retirement development in the very heart of Ecclesall is this fabulous, immaculately presented and very spacious one bedroomed first floor apartment. Tucked away on the rear side and shielded from Ecclesall road, it is within easy access of its many amenities, shops, public transport links and of course The Peak District is right next door. With lift access to all floors, a communal residents lounge, a pull cord assistance system, communal gardens, free laundry room, ample parking and available with no onward chain involved this apartment is specially set up to cater for the over 60's market and will be of particular interest to those looking to downsize.

Council Tax band: B

Tenure: Leasehold

- EXCELLENT ONE DOUBLE BEDROOMED FIFTH FLOOR APARTMENT
- LIFT ACCES TO ALL FLOORS AND SECURITY INTERCOM ENTRANCE
- COMMUNAL RESIDENTS LOUNGE
- FAMILY APARTMENT AVAILABLE TO BOOK FOR NIGHT OVER STAYS
- AMPLE VISITOR PARKING BAYS
- AVAILABLE WITH NO ONWARD CHAIN INVOLVED
- PERFECT FOR THE RETIRED COUPLE OR INDIVIDUAL
- COMMUNAL GARDENS FOR RESIDENTS USE
- SEMI ASSISTED LIVING OVER 60'S DEVELOPMENT
- LEASEHOLD PROPERTY AND COUNCIL TAX BAND B











**WHITEHORNES**

Buy. Sell. Let. Relax!

0114 268 8533  
info@whitehorses.com  
www.whitehorses.com

## Floor Plan

Approx. 45.2 sq. metres (486.4 sq. feet)

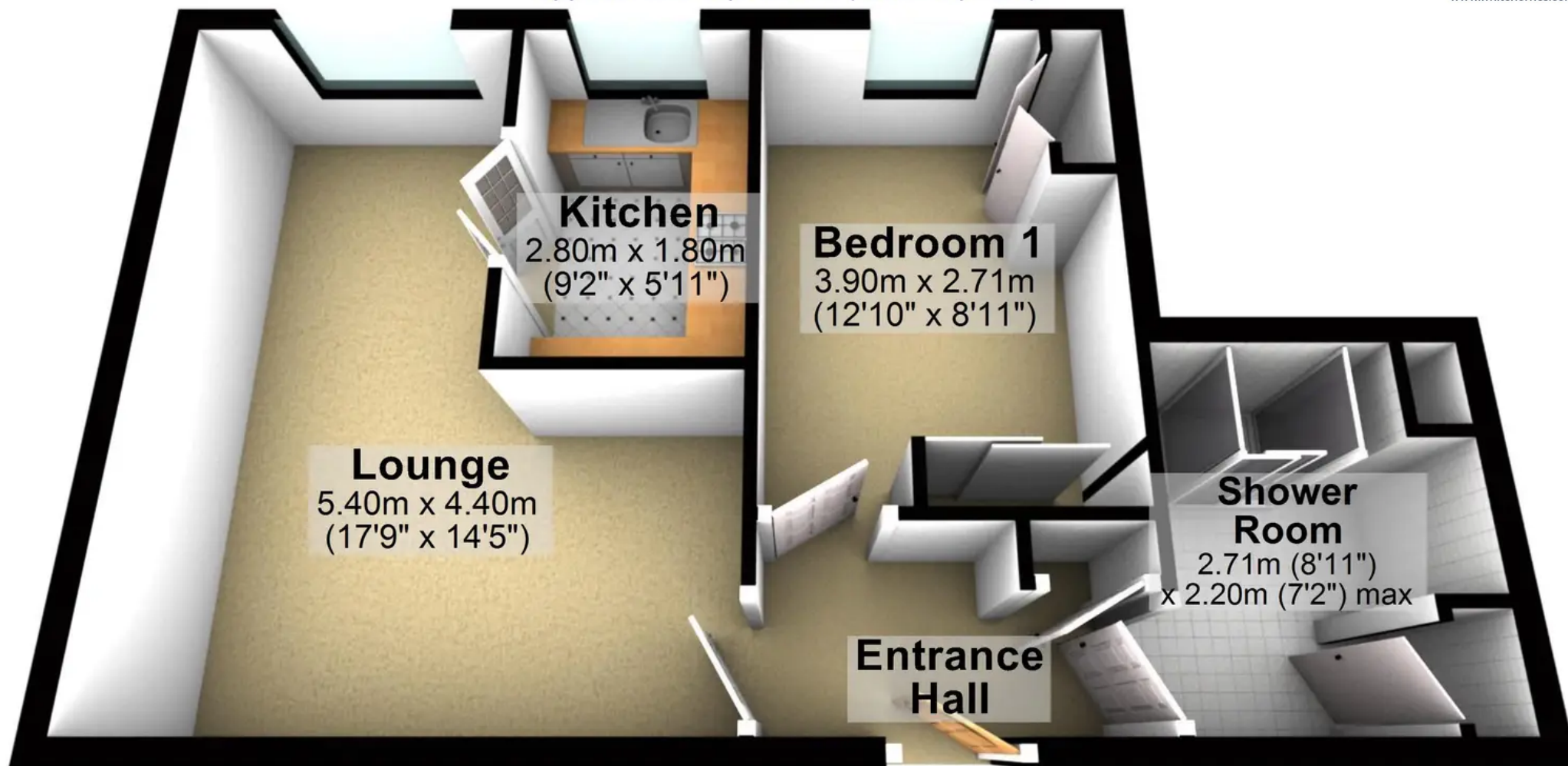

Total area: approx. 45.2 sq. metres (486.4 sq. feet)

All measurements are approximate  
Plan produced using PlanUp.