



WHITEHORSES

Buy. Sell. Let. Relax!

0114 268 8533
info@whitehorses.com
www.whitehorses.com

61 Murray Road., Ecclesall.

Sheffield

Guide Price £250,000 - £260,000

61 Murray Road.

Ecclesall., Sheffield

Offered for sale is this tasteful three bedroomed Victorian terraced property. With three floors of spacious and light accommodation totalling an impressive 1,115 sq feet that will be of particular interest to the professional couple and first time buyer alike along with the young family market. Located on this super popular residential road within the very heart of Ecclesall number 61 is within catchment for Ofsted rated excellent schools including Greystones juniors and High Storrs secondary. Numerous local independent amenities are within easy reach at Banner Cross that offer up an array of cafes, eateries and shops. The Peak District, Porter valley and Endcliffe park are all on the door step, principal hospitals and universities are within easy reach also. With a newly fitted roof and combi boiler there is plenty of potential to add a personalised finish.

Council Tax band: B Tenure: Leasehold

- THREE BEDROOMED VICTORIAN TERRACED PROPERTY WITH OFF SHOT KITCHEN
- PERFECT FOR THE FIRST TIME BUYER YOUNG FAMILY OR PROFESSIONAL COUPLE
- HEART OF ULTRA POPULAR ECCLESALL ON THE SOUTH WEST OF THE CITY
- OFSTED RATED EXCELLENT SCHOOLING CATCHMENTS INCLUDING GREYSTONES JUNIORS AND HIGH STORRS SECONDARY
- PRIVATE REAR GARDEN WITH NO THROUGH FARE FROM NEIGHBOURING PROPERTIES
- PEAK DISTRICT PORTER VALLEY AND ENDCLIFFE PARK ON THE DOOR STEP
- THREE FLOORS OF SPACIOUS AND LIGHT ACCOMMODATION TOTALLING AN IMPRESSIVE 1,115 SQ. FEET





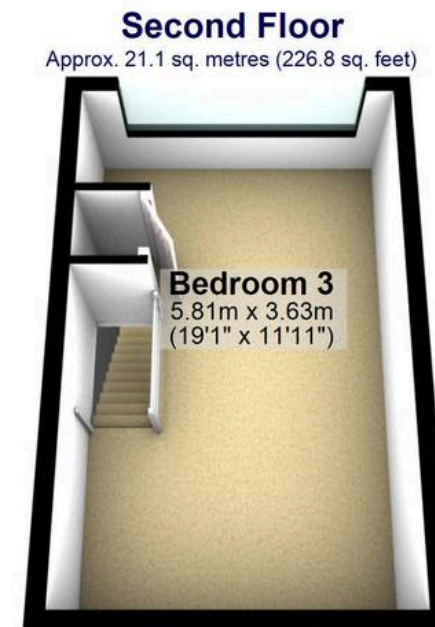
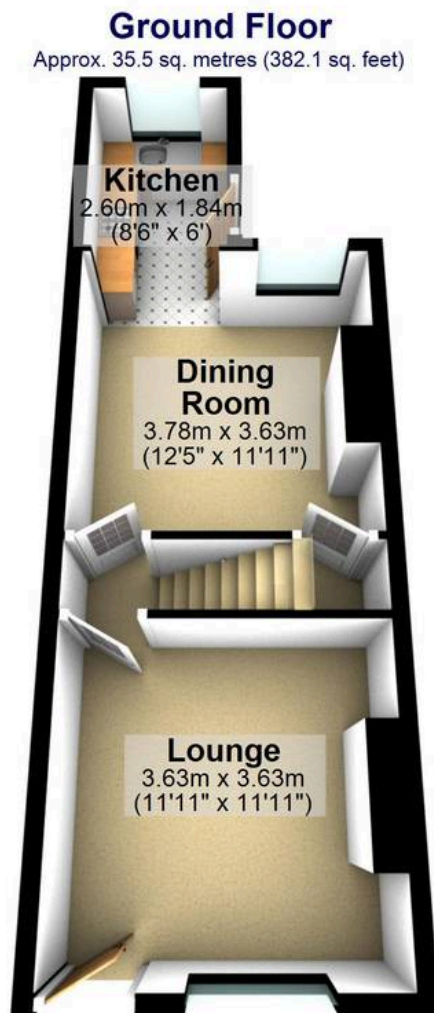
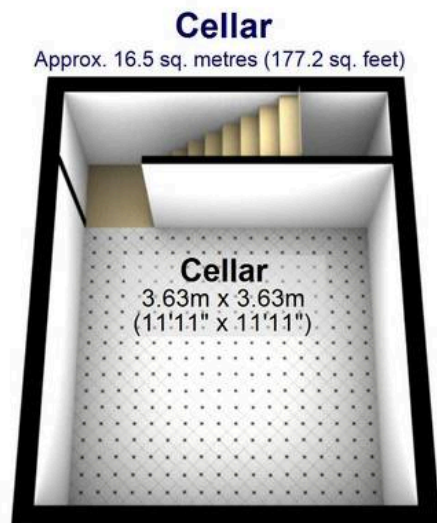

Total area: approx. 103.6 sq. metres (1114.9 sq. feet)

All measurements are approximate
Plan produced using PlanUp.