



74 Marriott Road, Millhouses
Sheffield

Guide Price £325,000 - £350,000

74 Marriott Road

Millhouses, Sheffield

An absolutely fabulous three bedroom, two bath/shower room, Victorian end of terrace property. Retaining a wealth of the original period character and charm associated with a property from this era and effortlessly combining a modern, fresh and contemporary vibe framed by the gorgeous rear, extended kitchen/dining room. With three beautiful floors of accommodation offering up a super spacious feel that total an impressive 1,378 sq feet. With newly fitted bespoke family bathroom and en-suite to the loft bedroom, log burning stove to the sitting room, private larger than expected rear garden, front courtyard terrace and easier than average front parking. Standing in this commanding position with no properties in front, number 74 is tucked away on this little known residential road that benefits from no through fare and really does provide a tranquil and peaceful feel set back from Abbeydale Road it's self.

Council Tax band: B Tenure: Leasehold

- STUNNING THREE BEDROOM TWO BATH/SHOWER ROOM END OF RUN VICTORIAN VILLA TERRACE PROPERTY
- TASTEFULLY EXTENDED TO TO THE REAR GROUND FLOOR TO PROVIDE A LARGER THAN EXPECTED KITCHEN
- TASTEFULLY FINISHED THROUGHOUT BY THE CURRENT VENDORS TO A SUPER HIGH STANDARD
- OPEN PLAN LIGHT AND CONTEMPORARY REAR DINING AREA FLOWING TO THE KITCHEN
- EXCELLENT SCHOOLING CATCHMENTS INCLUDING DOBCROFT JUNIOR AND BOTH SILVERDALE AND MERCIA SECONDARY
- QUIET SECLUDED LITTLE KNOW CUL DE SAC ROAD SET BACK AWAY FROM ABBEYDALE ROAD ENSURING A





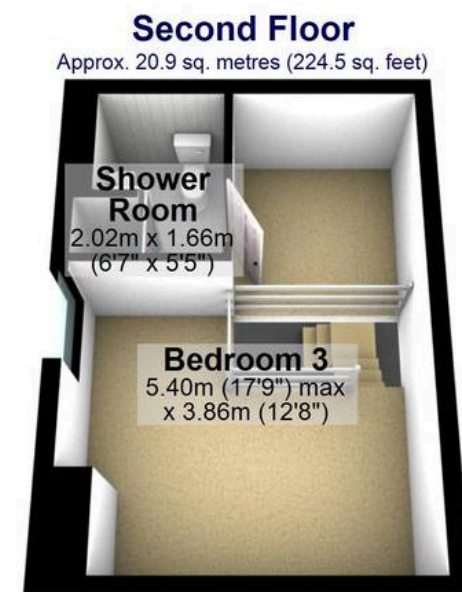
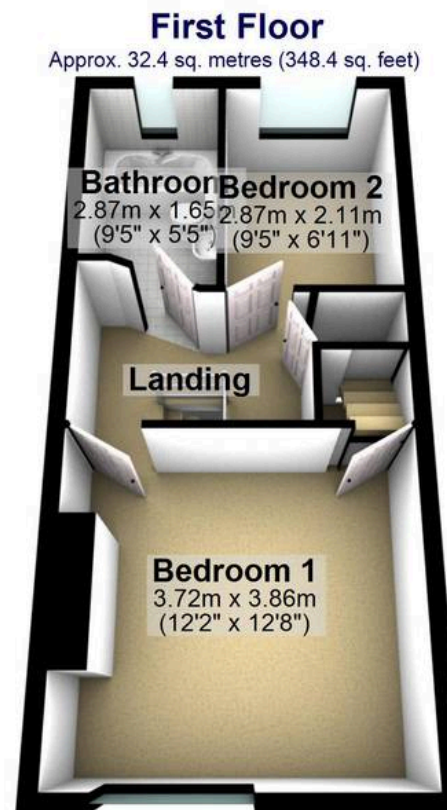
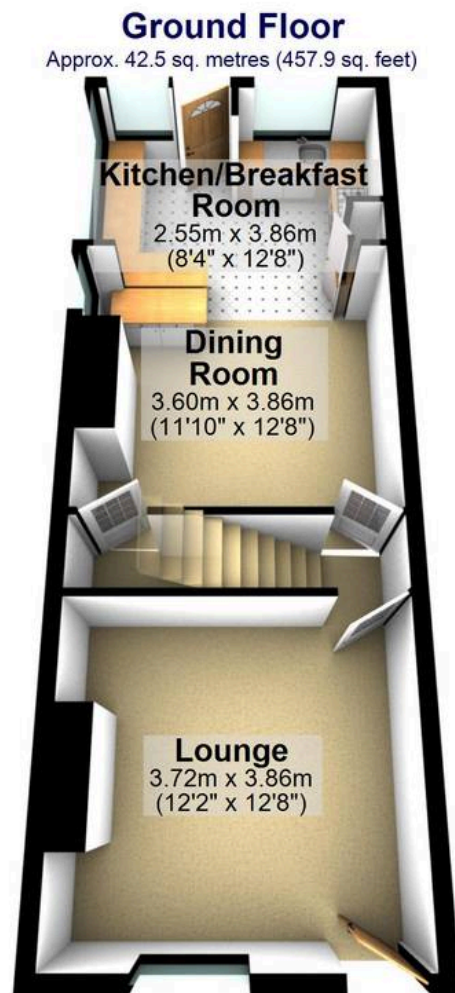
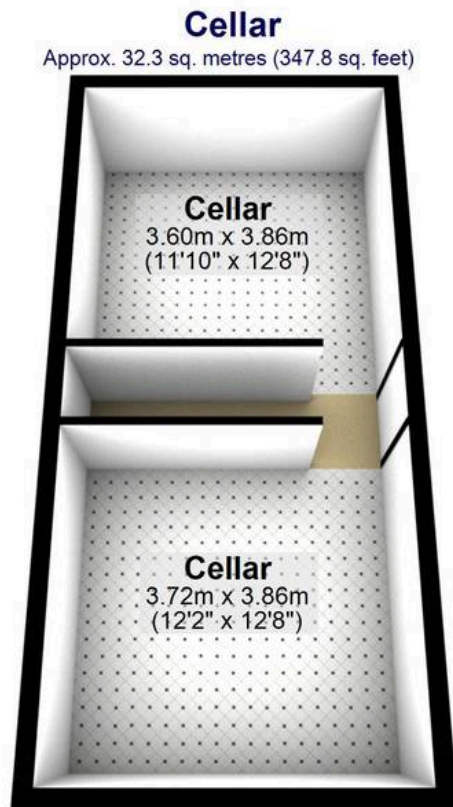

Total area: approx. 128.1 sq. metres (1378.7 sq. feet)

All measurements are approximate
Plan produced using PlanUp.