



301 Carter Knowle Road, Ecclesall

Sheffield

Guide Price £500,000 - £525,000

301 Carter Knowle Road

Ecclesall, Sheffield

An incredibly rare opportunity has arisen to purchase this absolutely stunning, immaculately presented and very deceptive four bedroom, two bath/shower roomed, bay windowed semi detached family home. With four impressive floors of light and spacious accommodation, totalling an eye watering 1,406 sq feet the property is set up perfectly to cater for the growing family market. With a super deceptive feel from the front, it's easy to say that viewing is absolutely essential to fully appreciate the size and style on offer by this gorgeous property. With a second floor loft bedroom, converted basement this fabulous offers up a huge degree of flexibility for the new buyers.

Council Tax band: D Tenure: Leasehold

- FABULOUS FOUR BEDROOM TWO BATH/SHOWER ROOMED BAY WINDOWED SEMI DETACHED HOME
- INCREDIBLY DECEPTIVE FROM THE FROM WITH AN INTERNAL VIEWING ABSOLUTELY ESSENTIAL
- FOUR FLOORS OF INCREDIBLY LIGHT AND SPACIOUS ACCOMMODATION TOTALLING AN IMPRESSIVE 1,604 SQ FEET
- PERFECT FOR THE GROWING FAMILY MARKET LOOKING FOR A FOREVER HOME
- OFSTED RATED EXCELLENT SCHOOLING CATCHMENTS INCLUDING ECCLESALL JUNIORS DOBCROFT PRIMARY HIGH STORRS AND SILVERDALE SECONDARY
- EXTREMELY RARE OPPORTUNITY TO MARKET WITH VIEWING ESSENTIAL TO DO FULL JUSTICE
- LARGE REAR PRIVATE SUNNY SOUTH FACING GARDEN AND OFF ROAD DRIVEWAY TO THE FRONT
- FABULOUS FAR REACHING VIEWS TO THE REAR OVER THE TENNIS COURTS AND BEYOND
- HEART OF ULTRA POPULAR ECCLESALL ON THE SOUTH WEST OF THE CITY





Basement

Approx. 15.7 sq. metres (168.9 sq. feet)

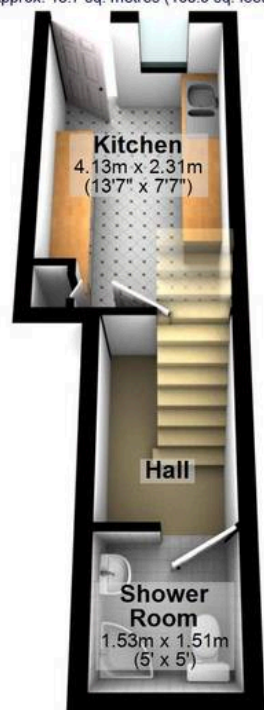

Ground Floor

Approx. 51.6 sq. metres (555.3 sq. feet)

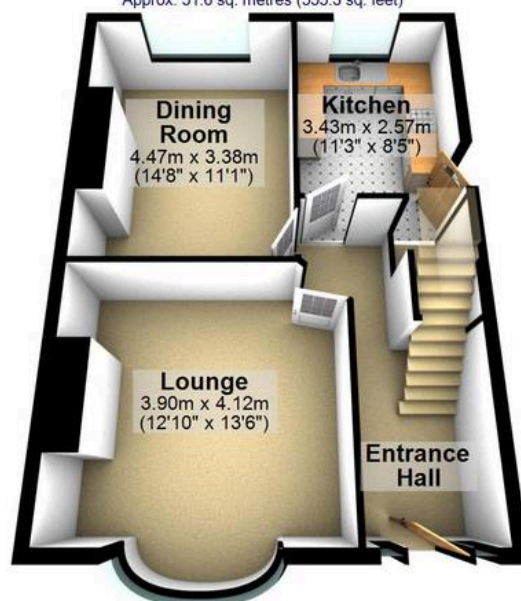

First Floor

Approx. 51.2 sq. metres (551.6 sq. feet)



Second Floor

Approx. 30.5 sq. metres (328.8 sq. feet)

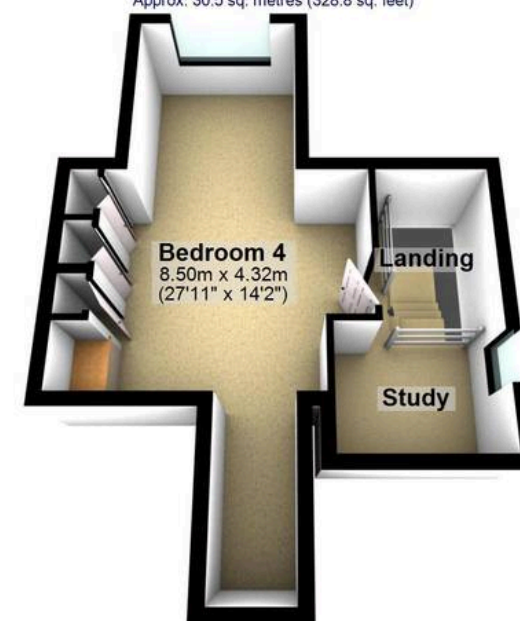

Total area: approx. 149.1 sq. metres (1604.7 sq. feet)

All measurements are approximate
 Plan produced using PlanUp.