



Apt 5, 6 Cutlers Gardens, Sheffield

Sheffield

Guide Price £385,000 - £400,000

Apartment 5

6 Cutlers Gardens, Sheffield

Setting the standard in contemporary urban living is this truly outstanding, immaculately presented and very deceptive three double bedroom, two bath/shower penthouse, duplex apartment. Nestled in the heart of the fashionable Kelham neighbourhood the apartment enjoys one of the largest footprints on the development with an impressive 1,135 sq feet across two floors. Boasting a spacious and contemporary design, this property showcases the largest roof garden within its architecturally designed building, providing a serene retreat within the vibrant urban setting. The open-plan layout effortlessly combines a sleek, fitted kitchen with a living-dining area, offering direct access to the expansive roof terrace.

Council Tax band: TBD Tenure: Leasehold

- STUNNING THREE DOUBLE BEDROOM TWO BATHROOM PENTHOUSE DUPLEX LUXURY APARTMENT
- LARGEST PRIVATE ROOF TERRACE IN THIS ARCHITECT DESIGNED DEVELOPMENT
- URBAN LIVING IN THE VERY HEART OF FASHIONABLE KELHAM ISLAND YET SET IN A QUIET AND TRANQUIL SETTING
- 1,135 SQUARE FEET OF IMMACULATLY PRESENTED ACCOMMODATION ACROSS TWO IMPRESSIVE FLOORS
- BESPOKE HIGH END FINISH THAT NEEDS TO BE BIEWED INTERNALLY TO BE FULLY APPRECIATED
- PERFECT FOR THE PROFESSIONAL COUPLE LOOKING FOR A CHIC URBAN ADDRESS IN THE HEART OF THE CITY
- INCREDIBLY SPACIOUS AND LIGHT THROUGHOUT WITH NATURAL LIGHT FLOODING IN FROM FLOOR TO CEILING WINDOWS





First Floor

Approx. 66.5 sq. metres (715.6 sq. feet)

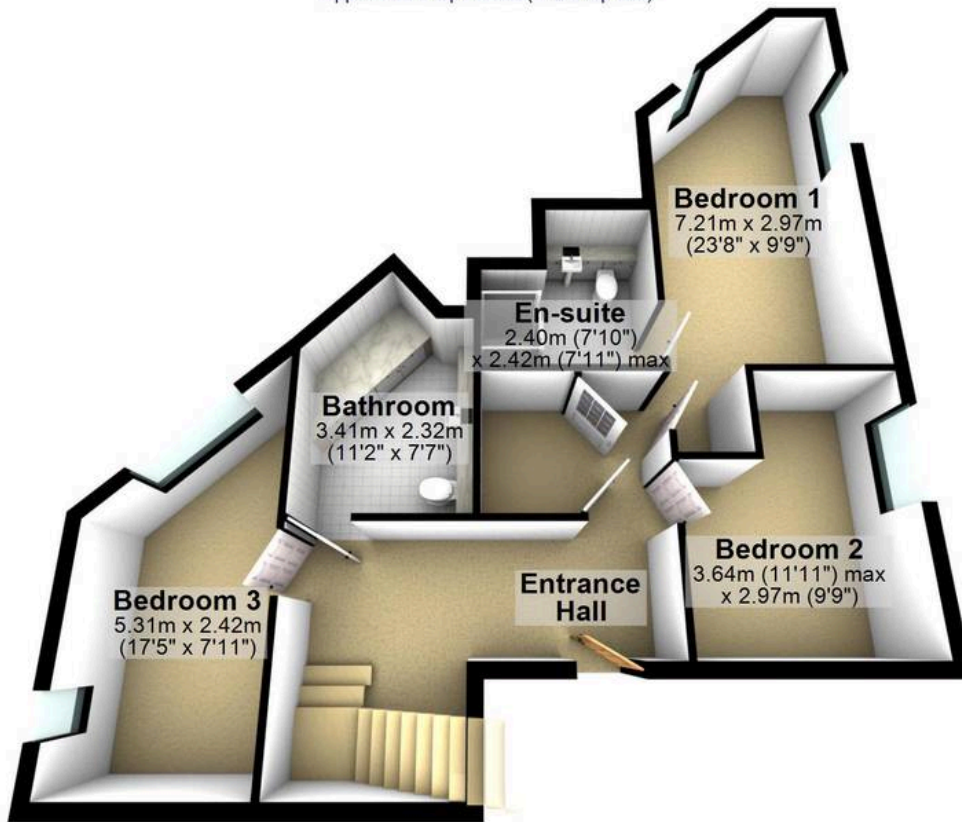

First Floor

Approx. 39.0 sq. metres (419.8 sq. feet)

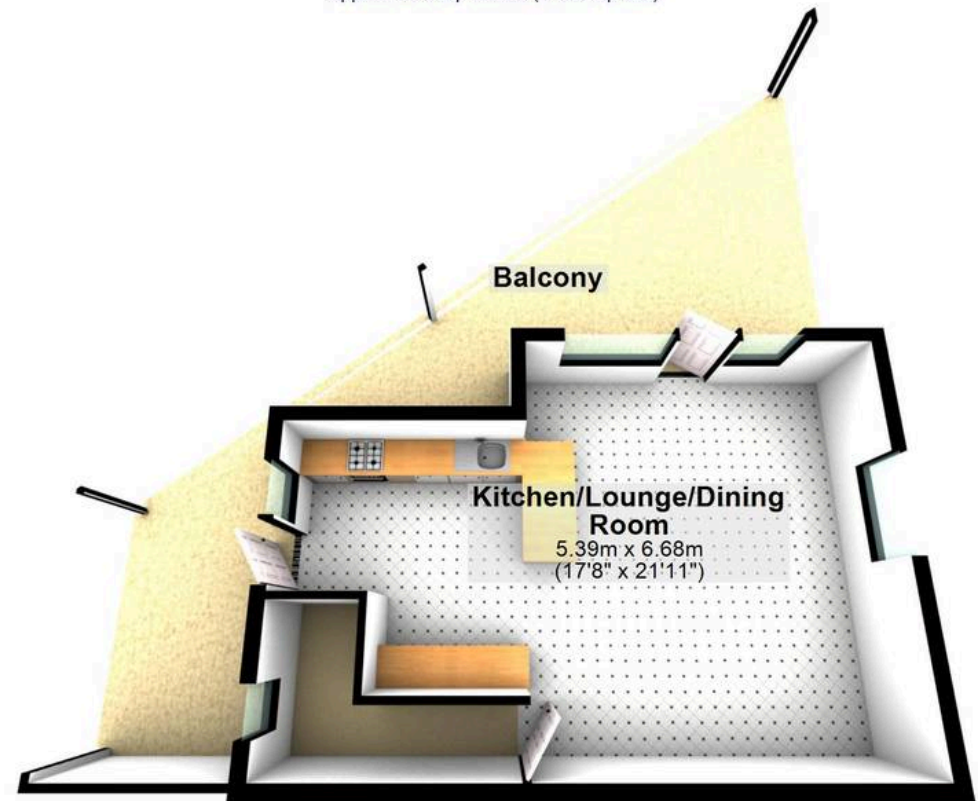

Total area: approx. 105.5 sq. metres (1135.4 sq. feet)

All measurements are approximate
Plan produced using PlanUp.



WHITEHORNES

Buy. Sell. Let. Relax!

0114 268 8533
info@whitehornes.com
www.whitehornes.com