



**WHITEHORNES**

Buy. Sell. Let. Relax!

0114 268 8533  
info@whitehorns.com  
www.whitehorns.com

**21 Wisewood Road, Sheffield**

Sheffield

In Excess of **£350,000**



# 21 Wisewood Road

Sheffield, Sheffield

A truly stunning three bedroomed detached property located in this much sought after and high regarded residential suburb. Benefitting from numerous local amenities and transport links a short stroll away, as well as falling into catchment area for reputable local schools including OFSTED rated 'Outstanding' Malin Bridge Primary School. Spread across three floors of spacious and modern accommodation totaling an impressive 1651 Sq Ft. The ground floor briefly consists of a light and bright family living room and open plan kitchen/diner opening out on the superb garden decking which leads down to the large rear garden which is perfect for young families and those alike. To the upstairs is three doubled bedrooms, the largest boasting an en-suite, and a fantastic family bathroom. To the front is easy and ample on-street parking. Viewing is essential to do full justice to this deceptively superb property.

Council Tax band: C

Tenure: Freehold

- THREE BEDROOMED DETACHED FAMILY HOME
- PERFECT FOR FIRST TIME BUYERS OR YOUNG FAMILIES ALIKE
- LOCATED CLOSE BY TO NUMEROUS LOCAL AMENITIES
- FANTASTIC NEARBY SCHOOLS INCLUDING OFSTED RATING 'OUTSTANDING' MALIN BRIDGE PRIMARY SCHOOL
- LIGHT AND BRIGHT ACCOMMODATION THROUGHOUT AND LARGE BASEMENT WITH SCOPE TO TANK/CONVERT
- FANTASTIC REAR GARDEN WITH DECKING AREA AND BEAUTIFUL VIEWS OVER RIVELIN VALLEY
- EASY AMPLE ON ROAD PARKING TO THE FRONT









### Basement

Approx. 29.6 sq. metres (318.5 sq. feet)

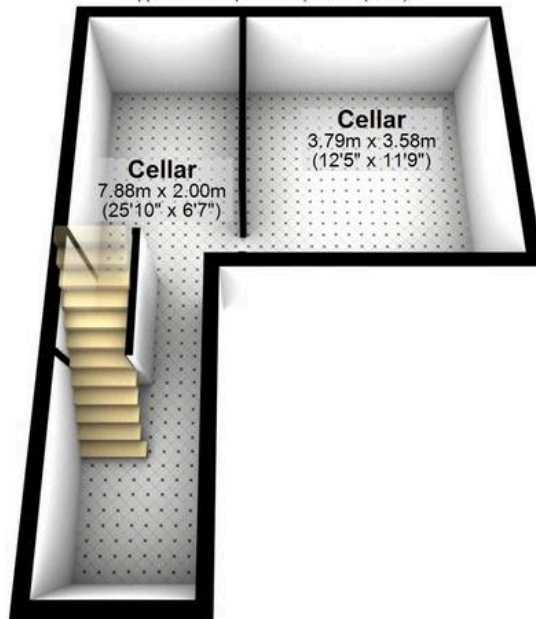

### Ground Floor

Approx. 47.0 sq. metres (506.4 sq. feet)

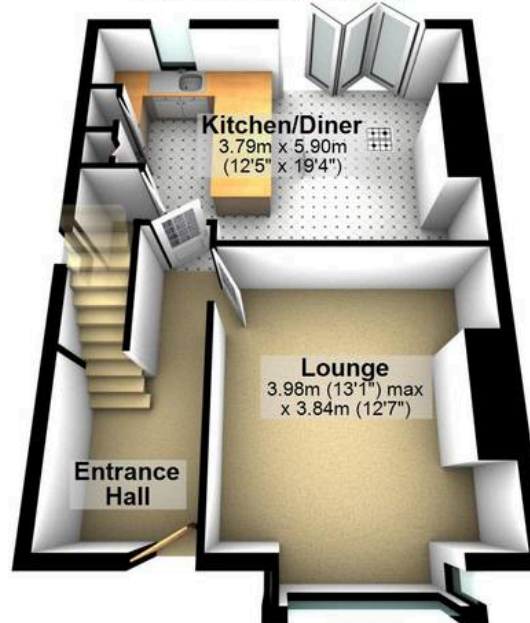

### First Floor

Approx. 46.4 sq. metres (499.7 sq. feet)



### Second Floor

Approx. 30.3 sq. metres (326.6 sq. feet)

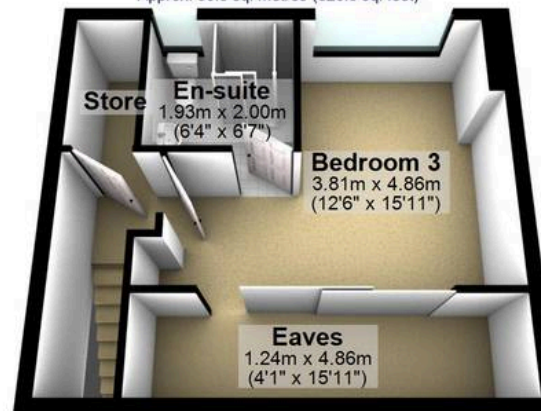

Total area: approx. 153.4 sq. metres (1651.2 sq. feet)

All measurements are approximate  
Plan produced using PlanUp.