



WHITEHORNES

Buy. Sell. Let. Relax!

0114 268 8533
info@whitehorns.com
www.whitehorns.com

46 Victoria Court, Brincliffe

Sheffield

Guide Price £295,000

46 Victoria Court

Brincliffe, Sheffield

With sweeping elegance and modern charm, this stunning two-bedroom apartment presents a rare opportunity to own a luxurious living space in the heart of the vibrant Brincliffe neighbourhood. The property, a part of the historic stone-built original hospital building, boasts a unique internal layout that accentuates a master bedroom complete with a dressing room and en-suite, ideal for a professional couple or a savvy first-time buyer. This first-floor apartment is located in a secure gated development with allocated parking, offering exclusive access to on-site leisure facilities that include a pool, gymnasium, and incredible communal grounds. A true gem, the property features a spacious open-plan lounge dining room with double-height ceilings and exposed beams, creating a sense of grandeur and sophistication. Spread across a total of 1,094 square feet. Council Tax band: E Tenure: Leasehold

- STUNNING TWO DOUBLE BEDROOM TWO BATHROOM FIRST FLOOR LUXURY APARTMENT
- FORMING PART OF THIS INCREDIBLE STONE BUILT ORIGINAL HOSPITAL BUILDING
- SECURE GATED DEVELOPMENT IN THE VERY HEART OF ULTRA POPULAR BRINCLIFFE ON THE SOUTH WEST OF THE CITY
- OFFERING A UNIQUE INTERNAL LAYOUT FRAMED BY A MASTER BEDROOM THAT ENJOYS A DRESSING ROOM AND EN-SUITE
- SHORT STROLL TO FASHIONABLE NETHER EDGE AND SHARROW VALE





First Floor

Approx. 101.6 sq. metres (1094.0 sq. feet)

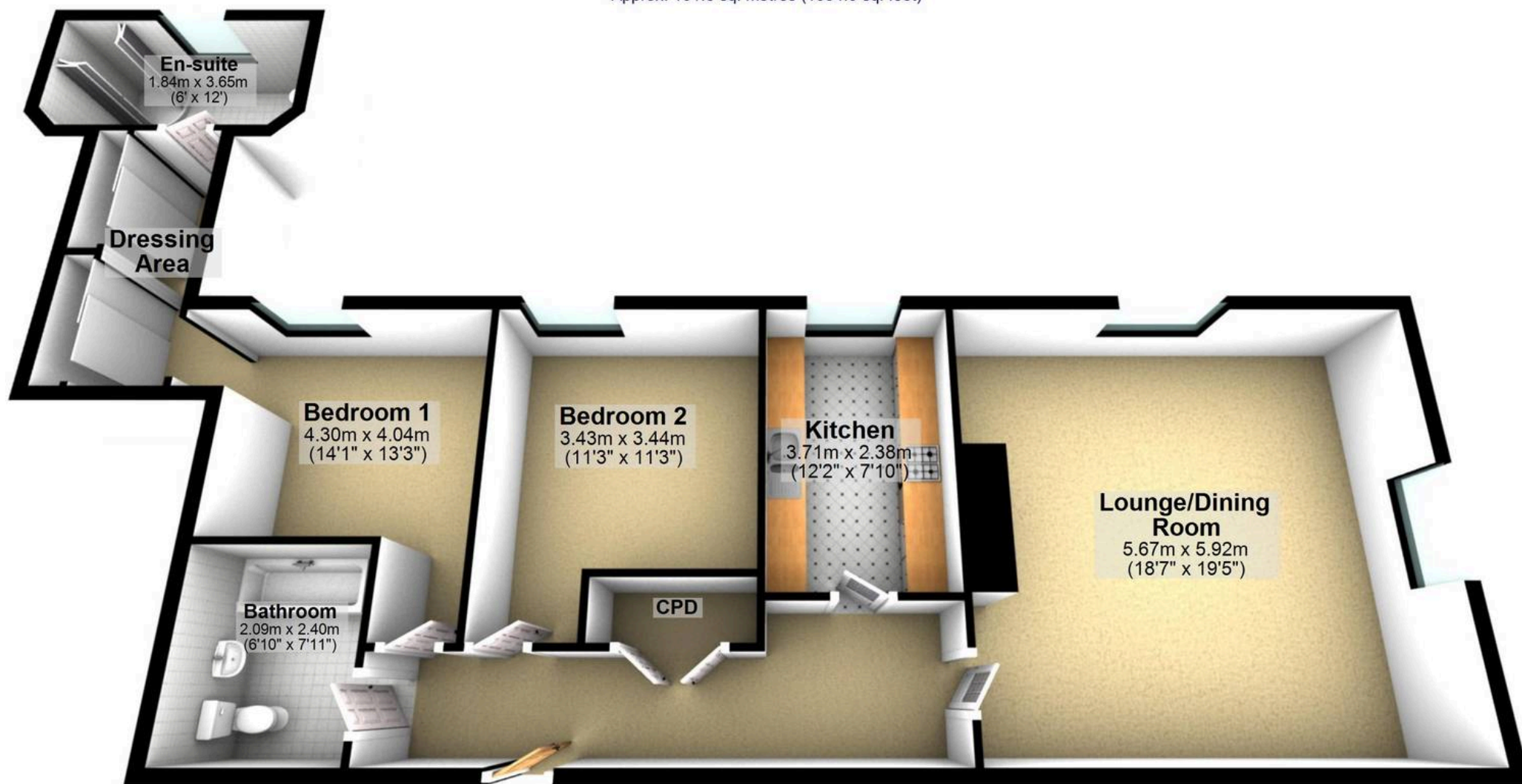

Total area: approx. 101.6 sq. metres (1094.0 sq. feet)

All measurements are approximate
Plan produced using PlanUp.