



WHITEHORNS

Buy. Sell. Let. Relax!

0114 268 8533
info@whitehorns.com
www.whitehorns.com

94 Louth Road, Ecclesall

Sheffield

Guide Price £390,000 - £400,000

94 Louth Road

Ecclesall, Sheffield

Beautifully presented, this three-bedroom semi-detached stone fronted home exudes charm and character, making it a perfect choice for the discerning family market. Boasting an inviting open plan sitting and dining room that seamlessly flows into the garden, this property offers a living space that is both functional and welcoming. Situated in the heart of Greystones, a sought-after residential suburb in the southwest of the city, this residence enjoys an elevated position at the front, guaranteeing privacy and breathtaking views. Its proximity to the highly esteemed Greystones Juniors and High Storrs Secondary schools only adds to its appeal, making it ideal for families seeking top-tier education for their children.

Council Tax band: C Tenure: Leasehold

- BEAUTIFUL THREE BEDROOM STONE FRONTED BAY WINDOWED SEMI-DETACHED HOME
- PERFECT FOR THE FAMILY MARKET AND VIEWING ADVISED TO SEE THE FINISH ON OFFER
- OPEN PLAN THROUGH SITTING AND DINING ROOM WITH DIRECT GARDEN ACCESS
- ELEVATED POSITION TO THE FRONT ENSURING PRIVACY AND SOME LOVELY VIEWS
- OFSTED RATED EXCELLENT SCHOOLING CATCHMENTS INCLUDING GREYSTONES JUNIORS AND HIGH STORRS SECONDARY
- HEART OF THIS INCREDIBLY POPULAR RESIDENTIAL SUBURB OF GREYSTONES ON THE SOUTH WEST OF THE CITY
- SHORT STROLL TO BINGHAM AND ENDCLIFFE PARKS AND THE PEAK DISTRICT UP THE ROAD
- FASHIONABLE SHARROW VALE AND ECCLESALL ROAD INDEPENDENT AMENITIES ON THE DOORSTEP
- PLENTY OF FURTHER COOPES TO EXTEND TO THE REAR





Ground Floor

Approx. 41.6 sq. metres (447.3 sq. feet)

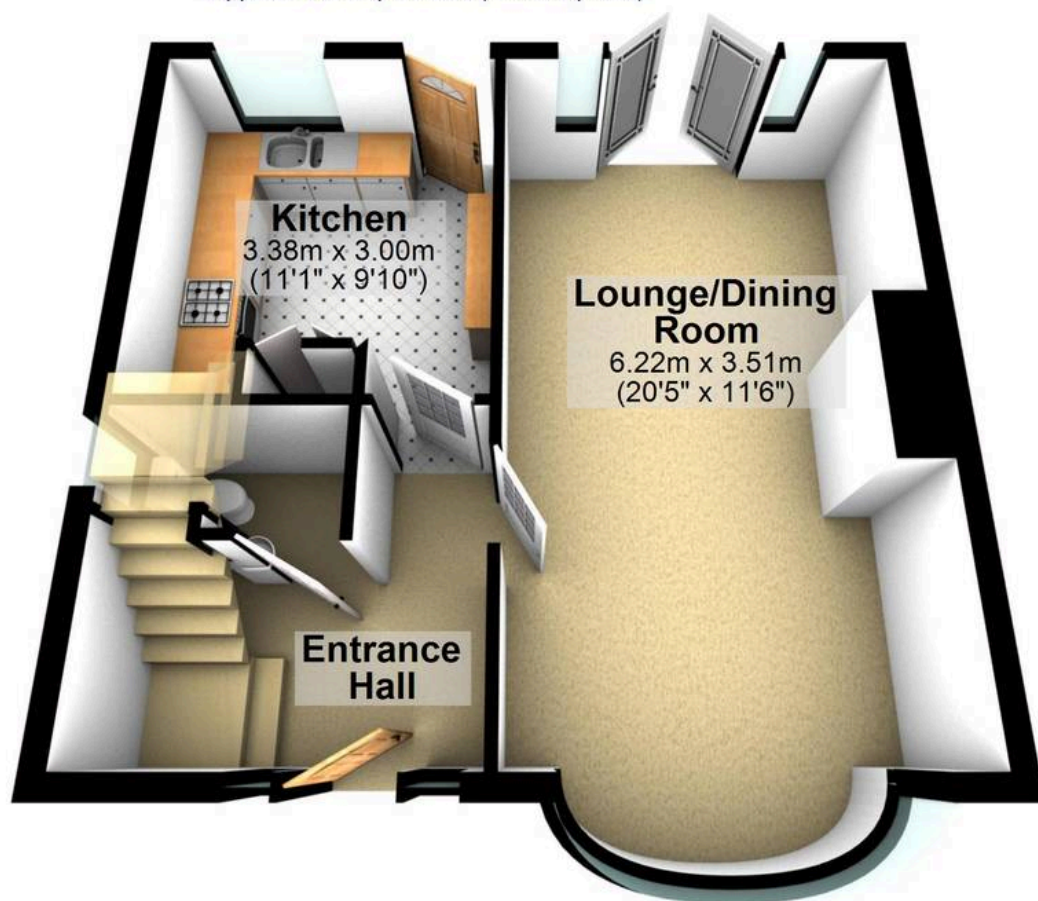

First Floor

Approx. 41.5 sq. metres (446.5 sq. feet)

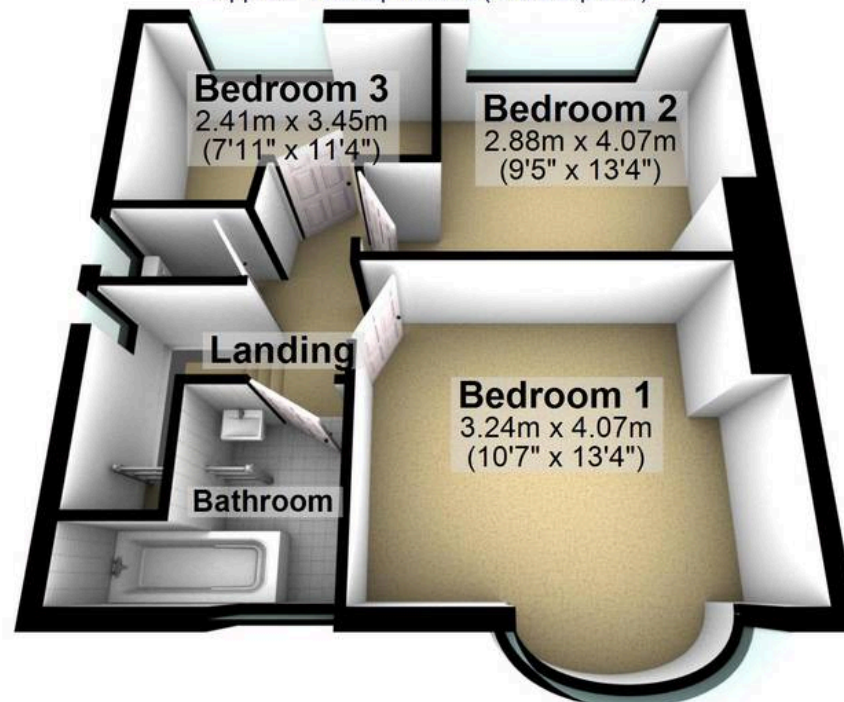

Total area: approx. 83.0 sq. metres (893.8 sq. feet)

All measurements are approximate
Plan produced using PlanUp.



WHITEHORNES

Buy. Sell. Let. Relax!

0114 268 8533
info@whitehornes.com
www.whitehornes.com