



WHITEHORNS

Buy. Sell. Let. Relax!

0114 268 8533
info@whitehorns.com
www.whitehorns.com

2 Carriage Drive, Darley Dale

Matlock

Guide Price **£420,000**

2 Carriage Drive

Darley Dale, Matlock

This superb four bedroomed detached family home is located in the heart of highly sought after residential suburb of Darley Dale. Totalling 1,334 sq ft of light accommodation this property briefly compromises of a front lounge, family room, open plan kitchen/diner, downstairs w/c, four bedrooms, the master boasting an en-suite bathroom, and a family bathroom. To the rear is an enclosed, private family garden and to the front is the garage and driveway providing off road parking. Close to numerous local amenities including Whitworth Park and Darley Dale station all within walking distance. Viewing is essential to do full justice.

Council Tax band: E

Tenure: Freehold

- FOUR BEDROOMED DETACHED FAMILY HOME
- PERFECT FOR THE GROWING FAMILY MARKET
- DRIVEWAY AND GARAGE PROVIDING OFF ROAD PARKING
- REAR, ENCLOSED FAMILY GARDEN
- TWO RECEPTION ROOMS AND TWO BATHROOMS
- WALKING DISTANCE TO LOCAL AMENITIES
- WHITWORTH PARK ON THE DOORSTEP
- FANTASTIC TRANSPORT LINKS
- 1,334 SQ FT OF ACCOMMODATION ACROSS TWO FLOORS
- FREEHOLD PROPERTY AND COUNCIL TAX BAND E





Ground Floor

Approx. 64.8 sq. metres (697.5 sq. feet)

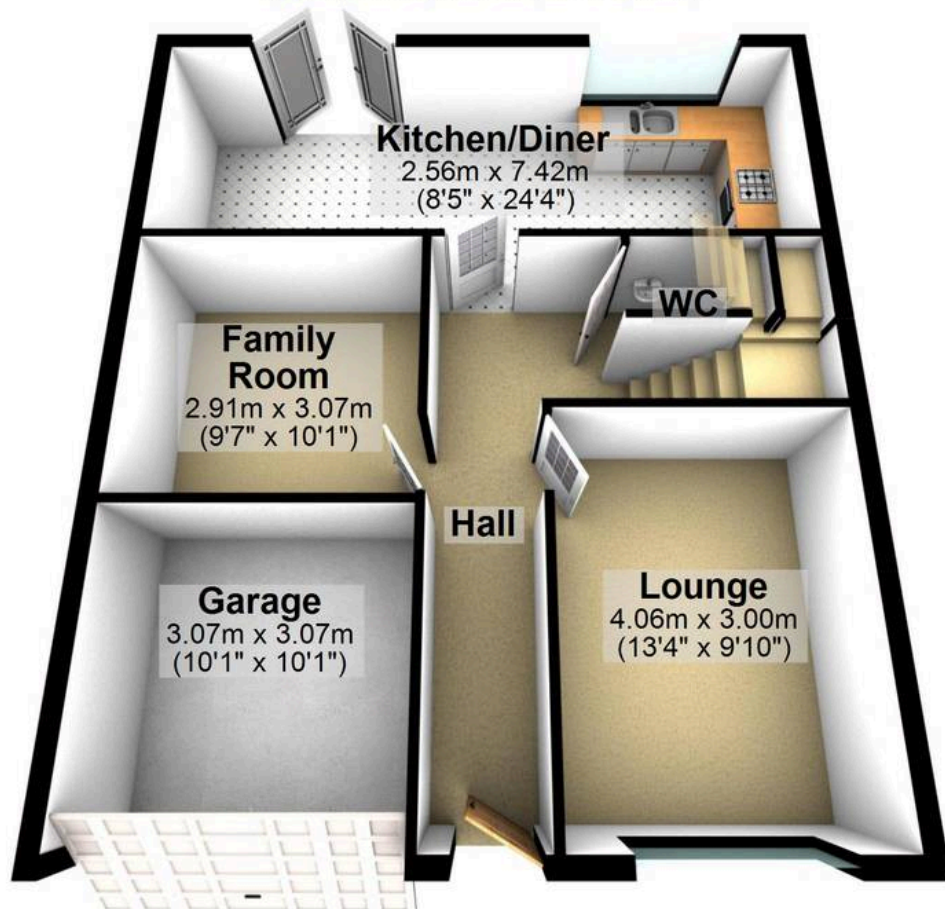

First Floor

Approx. 59.2 sq. metres (637.3 sq. feet)

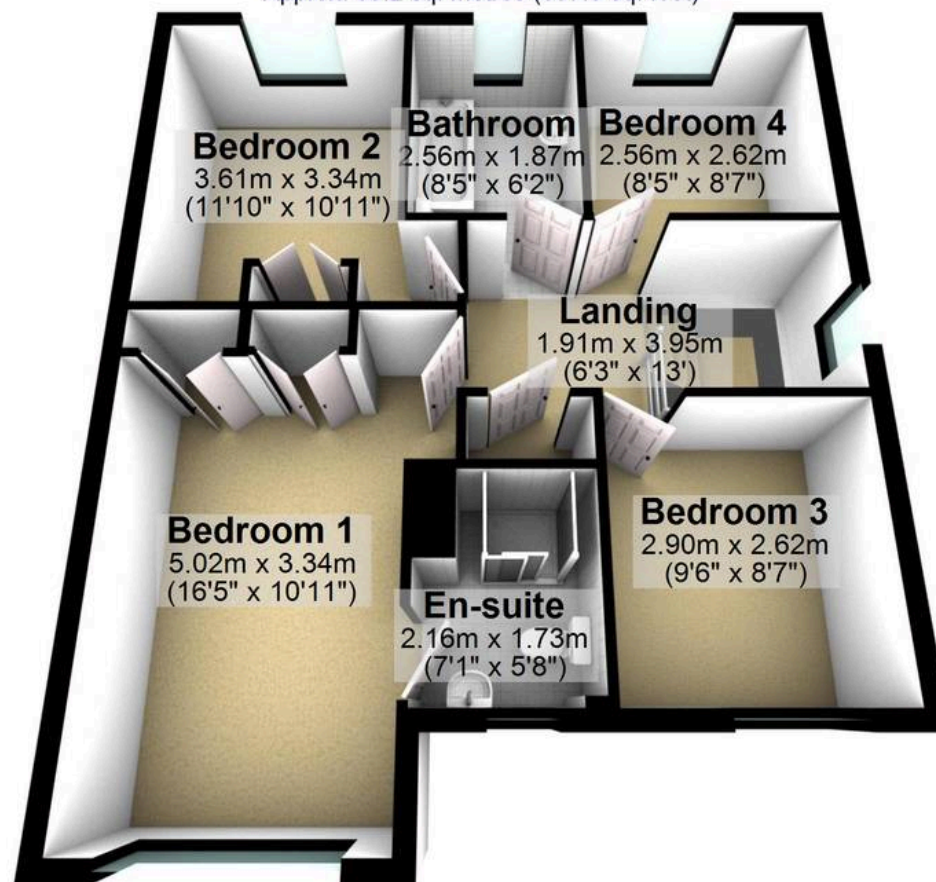

Total area: approx. 124.0 sq. metres (1334.8 sq. feet)

All measurements are approximate
Plan produced using PlanUp.



WHITEHORNS

Buy. Sell. Let. Relax!

0114 268 8533
info@whitehorns.com
www.whitehorns.com