

102 Doveholes Drive, Sheffield
Sheffield

102 Doveholes Drive

SHEFFIELD, Sheffield

A great opportunity for first time buyers and investors is this spacious two bedroomed, two bathroomed pent house apartment. Situated in this much sought after residential suburb and having all of Handsworths wealth of local amenities right on the door step, this property offers a versatile range of accommodation that would suit any buyer. Benefits from not only excellent transport links but also has a designated parking space. The property consists of entrance hallway, lounge, breakfasting kitchen, two double bedrooms, one with ensuite, and family bathroom. Outside are communal grounds. Council Tax band: B

Tenure: Leasehold

- Penthouse Apartment
- Two Bedrooms – One En-Suite
- Great Location for Commuting
- Great Investor Opportunity
- Designated Parking Bay
- Energy Rating D





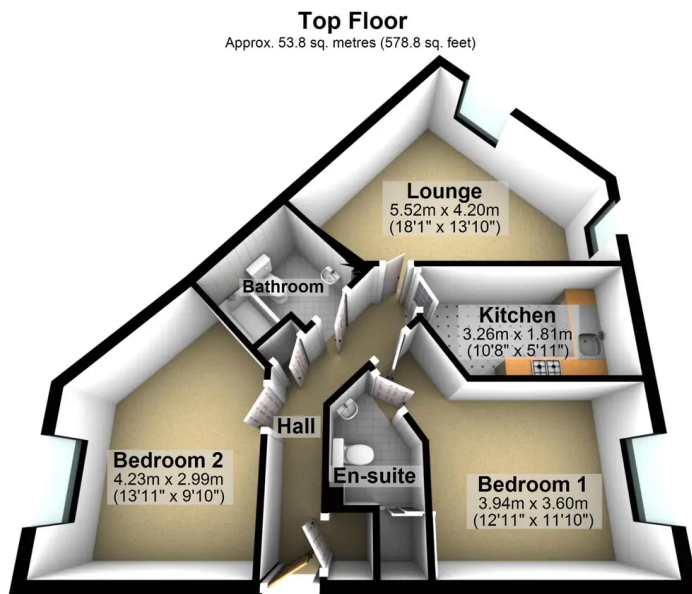

Total area: approx. 53.8 sq. metres (578.8 sq. feet)

All measurements are approximate
Plan produced using PlanUp.