



WHITEHORNES

Buy. Sell. Let. Relax!

0114 268 8533
info@whitehorns.com
www.whitehorns.com

203 West One City, 10 Fitzwilliam Street

Sheffield

Guide Price **£120,000**

203 West One City

Sheffield

A fabulous one bed roomed, second floor apartment perfect for first time buyers or investors alike. Forming part of this superb residential development in the very heart of ultra fashionable Devonshire quarter and enjoying some fabulous views. With secure entrance and lift access. With the city centre laid out on the door step, universities, hospitals and urban green spaces are all close by together with the train station and of course The Peak District is right up the road. With a super light and bright, spacious feel the accommodation in brief comprises entrance hall with storage, open plan sitting and dining room that flows to an integrated kitchen, double bedroom and contemporary bathroom. Outside are full use of communal gardens and contract parking is also available within close proximity.

Council Tax band: B

- IDEAL FOR FIRST TIME BUYERS OR INVESTORS ALIKE
- FANTASTIC ONE BEDROOM APARTMENT
- SPACIOUS THROUGHOUT
- SUPERB TRANSPORT LINKS
- SECOND FLOOR
- FABULOUS VIEWS OVER DEVONSHIRE GREEN
- HEART OF THE CITY LIVING
- CLOSE TO UNIVERSITIES AND HOSPITALS
- LIFT ACCESS AND SECURE INTERCOM ENTRANCE
- 447 SQ FT OF LIGHT AND BRIGHT LIVING





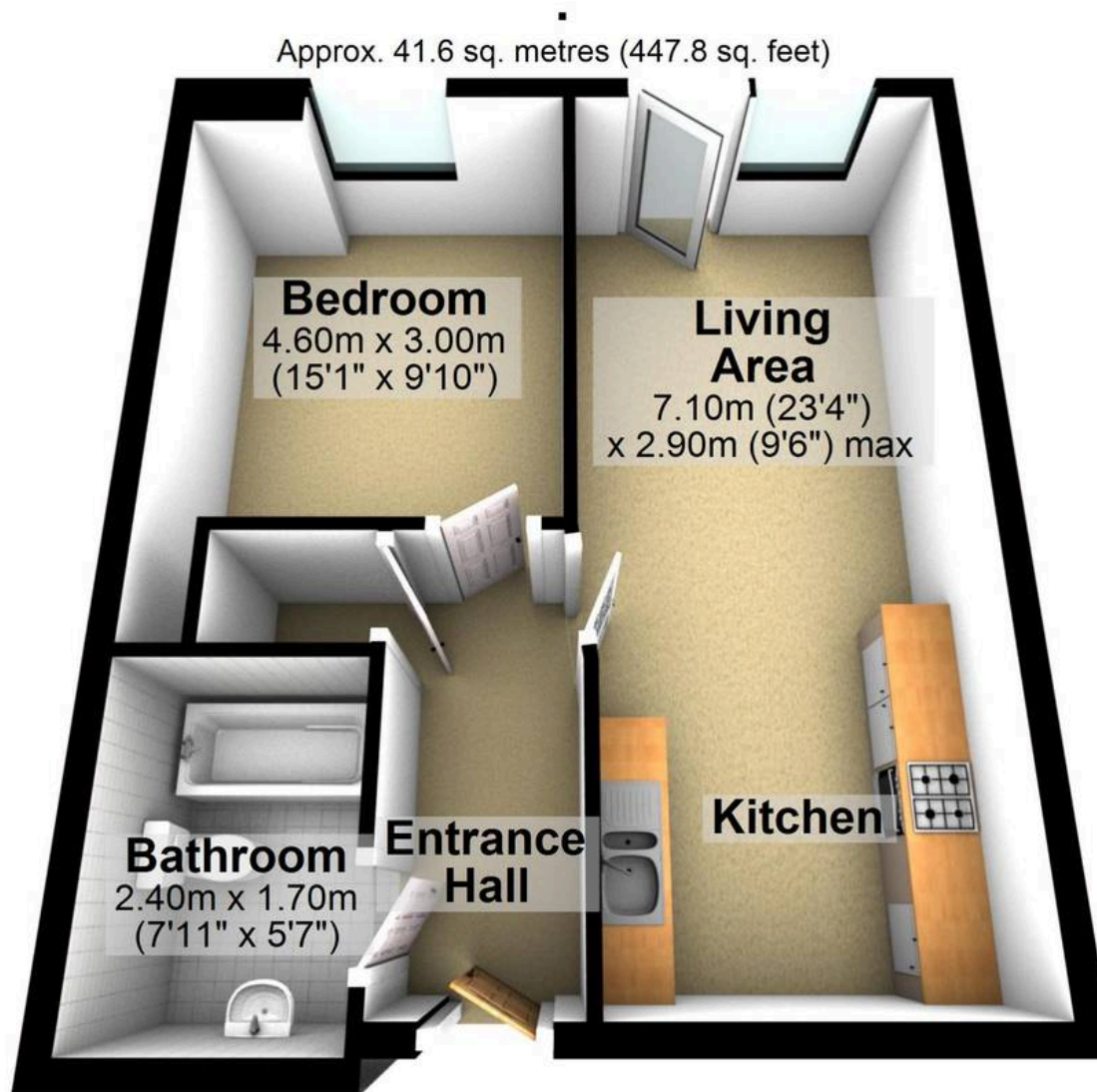

Total area: approx. 41.6 sq. metres (447.8 sq. feet)

All measurements are approximate
Plan produced using PlanUp.