



WHITEHORNS

Buy. Sell. Let. Relax!

0114 268 8533
info@whitehorns.com
www.whitehorns.com



177a Abbey Lane, Sheffield

Sheffield

Guide Price **£435,000**

177a Abbey Lane

Sheffield, Sheffield

An internal inspection is essential to truly appreciate this luxurious three double bedroomed semi-detached property, recently fully renovated to the highest standard, boasting a rear and attic extension for added space and comfort. This residence flaunts a blend of contemporary elegance and practicality. The property has two driveways, providing access from both the front and rear of the property, ample space for multiple vehicles, including electric car charging infrastructure. In addition to this, a detached garage the rear of the property. Nestled in the sought-after location of Beauchief Woods and set in the catchment area for reputable local schools and offering excellent public transport links for seamless commuting. The property briefly consists of entrance hallway, large front facing lounge, extended open plan kitchen/dining room, downstairs WC with underfloor heating throughout. Upstairs, there are three generous double bedrooms, two with en-suites, and family bathroom with underfloor heating. Outside is a private and well enclosed south east facing rear garden, ideal for families and pets.

Council Tax band: C

Tenure: Leasehold

- THREE DOUBLE BEDROOMED SEMI-DETACHED PROPERTY
- PERFECT HOME FOR THE GROWING FAMILY MARKET
- BOASTING UNDERFLOOR HEATING THROUGHOUT THE GROUND FLOOR
- IN THE CATCHMENT AREA FOR LOCAL REPUTABLE SCHOOLS INCLUDING ABBEY LANE PRIMARY SCHOOL
- BENEFITTING FROM TWO DRIVEWAYS, DETACHED GARAGE AND EV CHARGING PORT





Garage

Approx. 12.9 sq. metres (139.1 sq. feet)

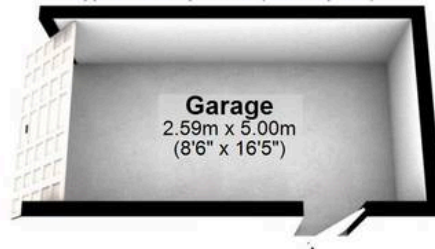

Ground Floor

Approx. 55.6 sq. metres (598.1 sq. feet)

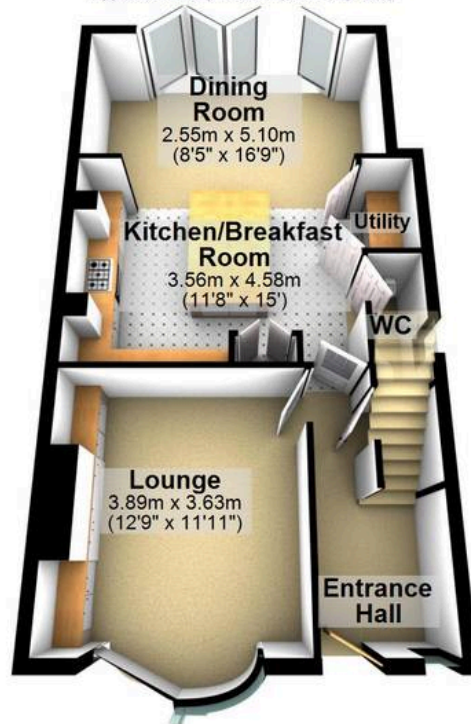

First Floor

Approx. 42.1 sq. metres (452.7 sq. feet)

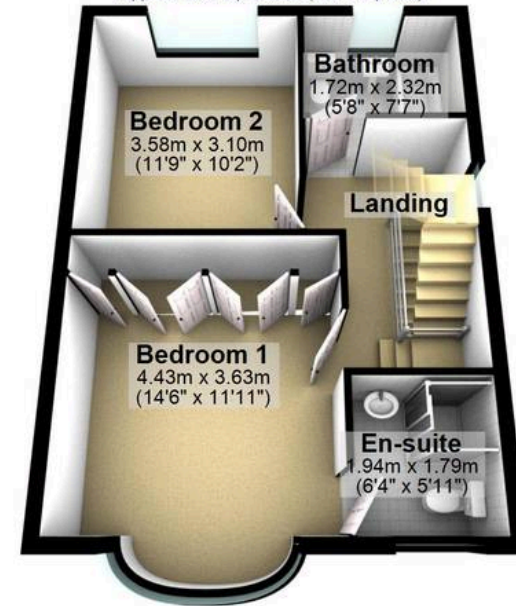

Second Floor

Approx. 27.1 sq. metres (292.1 sq. feet)

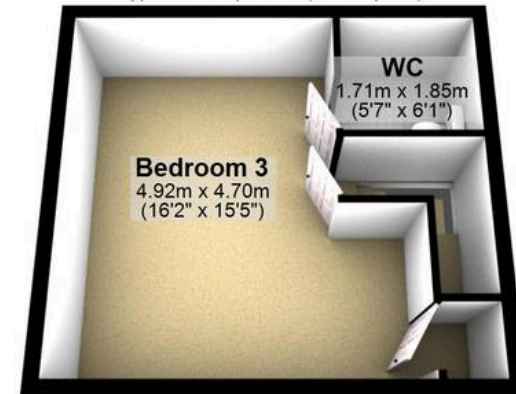

Total area: approx. 137.7 sq. metres (1482.1 sq. feet)

All measurements are approximate
Plan produced using PlanUp.