



**WHITEHORNES**

Buy. Sell. Let. Relax!

0114 268 8533  
info@whitehornes.com  
www.whitehornes.com

**52 Murray Road, Ecclesall**

Sheffield

**Guide Price £335,000 - £335,000**



# 52 Murray Road

Ecclesall, Sheffield

Only upon a detailed internal inspection will the true style and size of this outstanding, immaculately presented and very deceptive three double bedroomed, Victorian terraced be fully revealed. Oozing contemporary cool and style throughout the three floors of stunning accommodation this sensational property has been finished to the very highest of standards with absolutely no expense spared by the current vendors to create this perfect finished home. Ideally suited to the professional couple or young family the property is located within a short walk from Endcliffe park, Porter valley, buzzing Sharrow Vale with its array of independent cafes, shops and eateries and don't forget The Peak District is on the doorstep.

Council Tax band: B Tenure: Leasehold

- STUNNING CONTEMPORARY DESIGN THROUGHOUT RETAINING THE ORIGINAL PERIOD FEATURES CHARACTER AND CHARM
- THREE DOUBLE BEDROOMED PERIOD VICTORIAN TERRACED PROPERTY
- SUPERB LOCATION WITH ENDCLIFFE A SHORT STROLL AWAY
- GREYSTONES AND HIGH STORRS SCHOOLING CATCHMENTS
- IDEALLY SUITED TO THE PROFESSIONAL COUPLE AND YOUNG FAMILY MARKET
- BUZZING SHARROWVALE WITHIN EASY DISTANCE
- VIEWING IS ESSENTIAL TO APPRECIATE THE SIZE AND STYLE ON OFFER
- FULLY REFURBISHED TO THE HIGHEST OF STANDARDS WITH NO EXPENSE SPARED
- THREE FLOORS OF SPACIOUS AND VERSATILE ACCOMMODATION TOTTALLING AN IMPRESSIVE 1,396 SQ. FEET









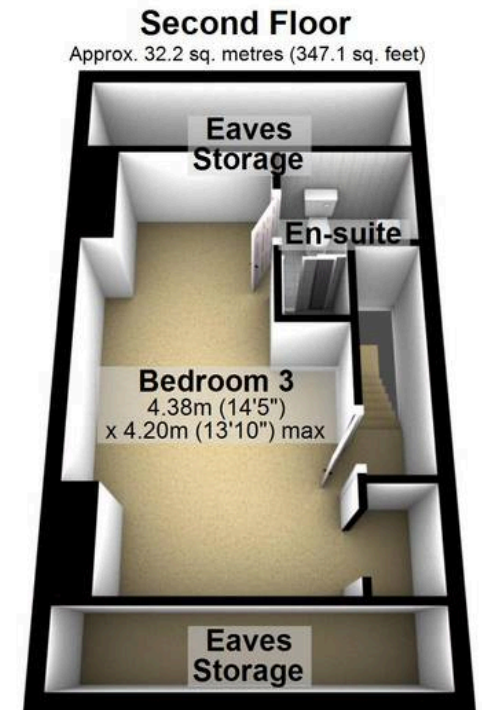
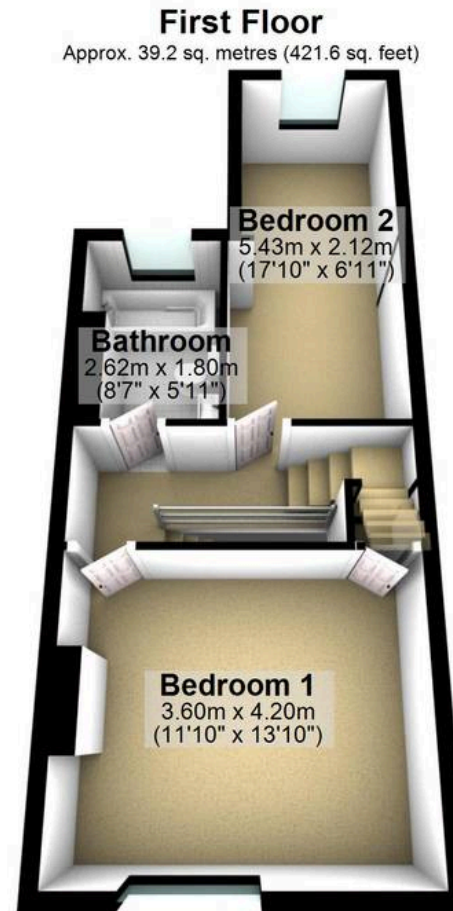
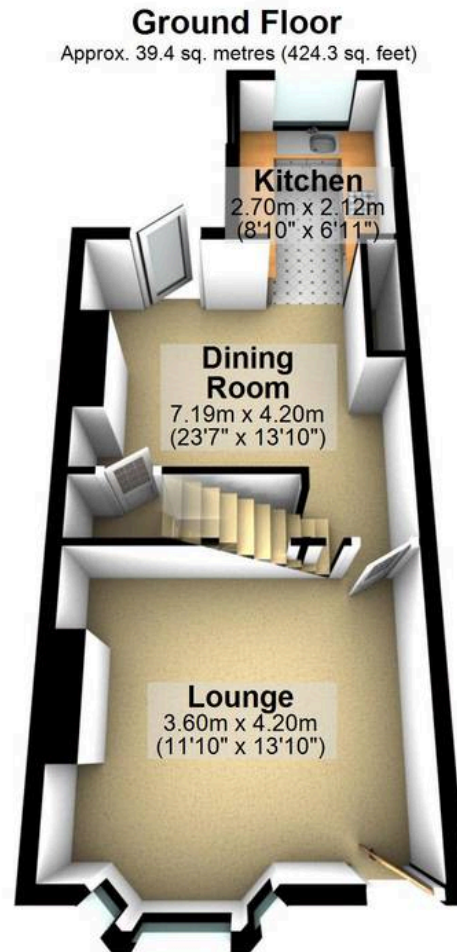
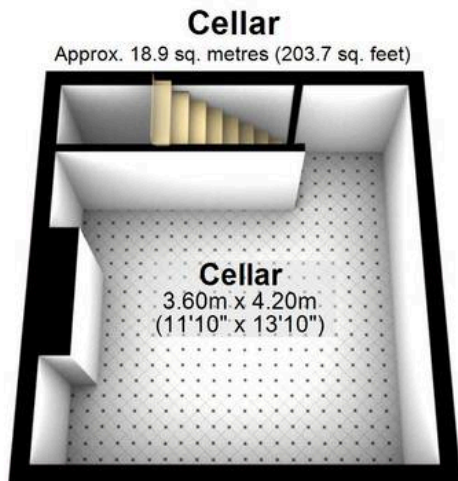

Total area: approx. 129.8 sq. metres (1396.6 sq. feet)

All measurements are approximate  
Plan produced using PlanUp.