



WHITEHORNES

Buy. Sell. Let. Relax!

0114 268 8533
info@whitehorses.com
www.whitehorses.com

25 Strathtay Road, Greystones

Sheffield

Guide Price **£399,950**

25 Strathtay Road

Greystones, Sheffield

Situated on this residential road in the heart of well sought after Greystones this four bedroomed Victorian mid-terraced family home boasts an elevated position ensuring privacy. Totalling an impressive 1,291 sq ft of superb accommodation this property is ideal for young families and those alike. Briefly consisting of a front bay windowed lounge, dining room, off shot rear kitchen, four bedrooms, family bathroom, shower room, walk in wardrobe and cellar. To the rear is a private and enclosed garden. Benefitting from being in walking distance to fashionable Ecclesall Road/Sharroavale, the peak district and fantastic green spaces. Not to forget the numerous fantastic schools nearby including Greystones Primary School and High Storrs Secondary School. Viewing essential to do full justice. VALUER BEN WHITEHORNE
Council Tax band: B

Tenure: Freehold

- FOUR BEDROOMED VICTORIAN VILLA MID-TERRACED PROPERTY
- ELEVATED POSITION TO THE FRONT ENSURING PRIVACY
- POSITIONED ON THIS WELL SOUGHT AFTER ROAD
- IDEAL FOR THE GROWING FAMILY MARKET
- LOCAL SCHOOLING CATCHMENTS INCLUDING GREYSTONES PRIMARY SCHOOL
- CLOSE BY TO NUMEROUS LOCAL AMENITIES
- ENDCLIFFE PARK A SHORT STROLL AWAY
- PRIVATE REAR GARDEN AND AMPLE ON-STREET PARKING
- FREEHOLD PROPERTY AND COUNCIL TAX BAND B
- VIEWING ESSENTIAL TO DO FULL JUSTICE





Ground Floor

Approx. 35.8 sq. metres (385.7 sq. feet)

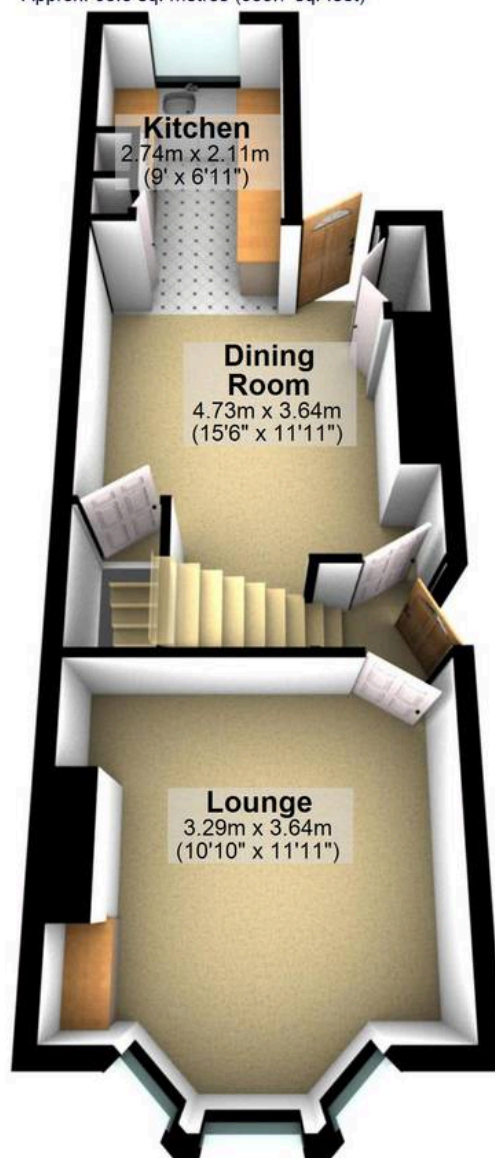

Basement

Approx. 13.3 sq. metres (143.3 sq. feet)

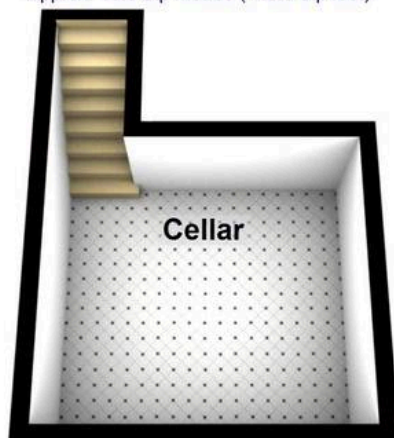

First Floor

Approx. 41.3 sq. metres (444.8 sq. feet)

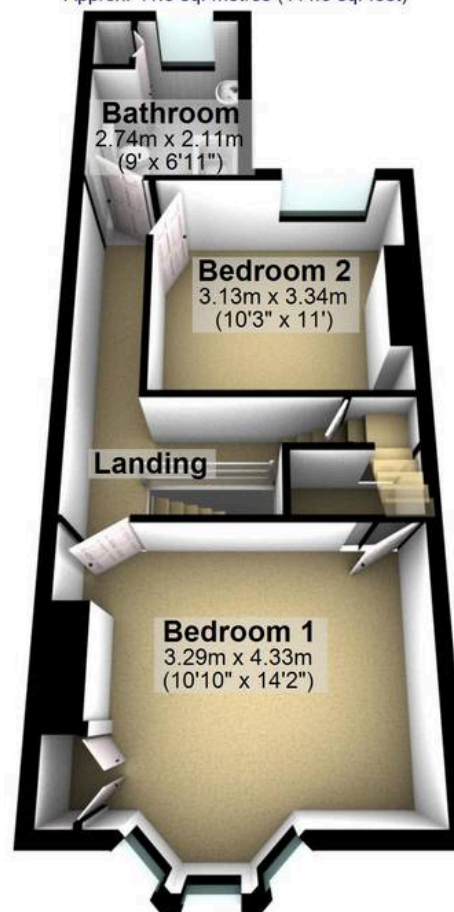

Second Floor

Approx. 29.5 sq. metres (317.4 sq. feet)



Total area: approx. 120.0 sq. metres (1291.2 sq. feet)

All measurements are approximate
Plan produced using PlanUp.



WHITEHORSES

Buy. Sell. Let. Relax!

0114 268 8533
info@whitehorses.com
www.whitehorses.com