



WHITEHORSES

Buy. Sell. Let. Relax!

0114 268 8533

info@whitehorses.com

www.whitehorses.com

33 Twentywell Road, Bradway

Sheffield

Guide Price £450,000 - £475,000

33 Twentywell Road

Bradway, Sheffield

A fabulous five-bedroom detached family home awaits in the heart of the ultra-popular Bradway within S17, nestled on the cusp of the Peak District. Ideal for the growing family market, this property offers an impressive total of 1,402 sq ft spread across two spacious floors, inviting you to explore the generous living space it provides. Situated within excellent local schooling catchments, including Bradway Primary, this residence boasts a sunny rear private garden, ideal for outdoor gatherings, alongside convenient off-road parking and a garage for additional storage. Enjoy superb views to the front, stretching towards the golf course and beyond, creating a picturesque backdrop. With easy access to numerous amenities and the Peak District on its doorstep.

Council Tax band: E Tenure: Leasehold

- FABULOUS FIVE GOOD SIZED BEDROOM DETACHED FAMILY HOME
- HEART OF ULTRA POPULAR BRADWAY WITHIN S17 ON THE CUSP OF THE PEAK DISTRICT
- PITCH PERFECT FOR THE GROWING FAMILY MARKET WITH VIEWING ESSENTIAL TO SEE THE SIZE ON OFFER
- TWO SPACIOUS AND FLOORS OF ACCOMMODATION TOTALLING AN IMPRESSIVE 1,402 SQ FT
- EXCELLENT LOCAL SCHOOLING CATCHMENTS AVAILABLE INCLUDING BRADWAY PRIMARY
- SUNNY REAR PRIVATE SIZEABLE GARDEN OFF ROAD PARKING AND GARAGE STORE
- SUPERB VIEWS TO THE FRONT OVER TOWARDS THE GOLF COURSE AND BEYOND
- EASY ACCESS TO NUMEROUS AMENITIES AND THE PEAK DISTRICT ON THE DOORSTEP
- TASTEFULLY EXTENDED WITH A DOUBLE STORY SUDE





Ground Floor

Approx. 67.1 sq. metres (722.1 sq. feet)

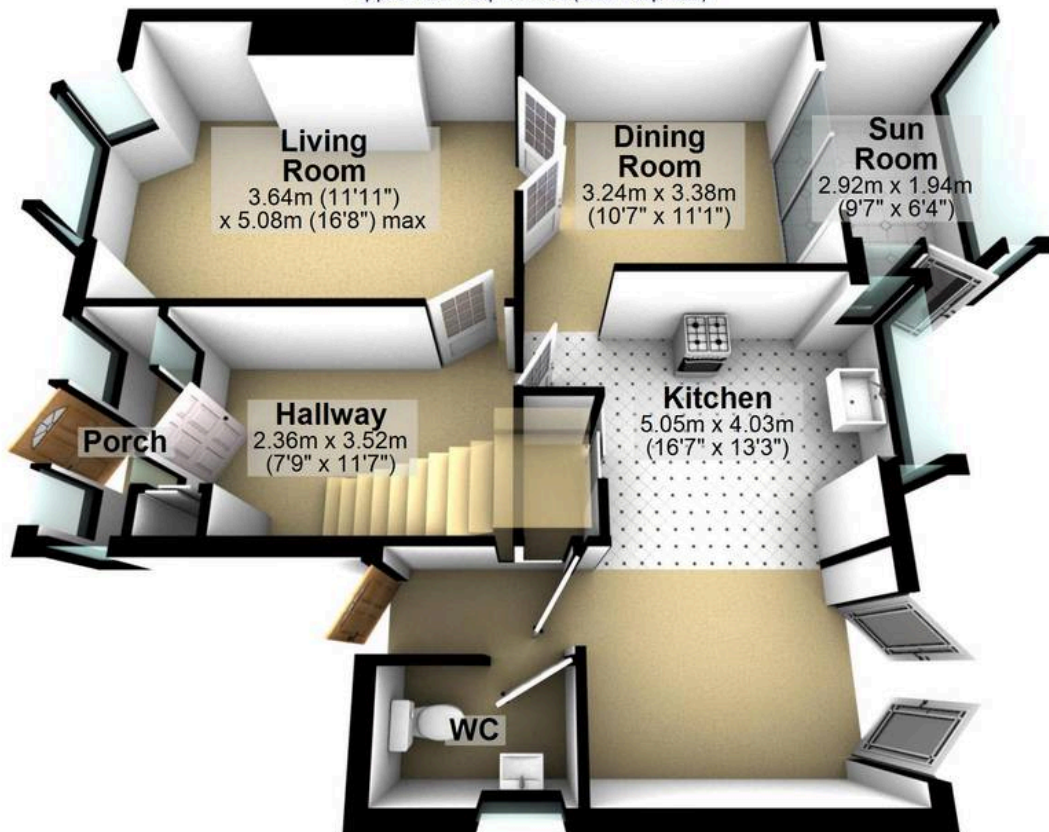

First Floor

Approx. 63.1 sq. metres (679.0 sq. feet)



Total area: approx. 130.2 sq. metres (1401.1 sq. feet)

All measurements are approximate
 Plan produced using PlanUp.

Twentywell Road