



WHITEHORSES

Buy. Sell. Let. Relax!

0114 268 8533
info@whitehorses.com
www.whitehorses.com

6 Cotleigh Way, Sheffield

Sheffield

Guide Price **£189,950**

6 Cotleigh Way

Sheffield, Sheffield

Perfect for first time buyers and families alike is this spacious and well presented three bedroomed, semi-detached family home. Being located in one of Sheffield's most popular suburbs with easy access to not only a wealth of local amenities but also the nearby Tram network and local reputable schools. The property has been finished throughout to a great standard and boasts a superb rear garden. Briefly consists of entrance hallway, cloakroom, spacious lounge, well appointed kitchen/dining room, walk-in pantry, two double bedrooms, single bedroom and a family bathroom. Outside is a stunning and large rear garden which is perfect for families and pets.

Council Tax band: A

Tenure: Freehold

- THREE BEDROOM SEMI-DEATCHED PROPERTY
- PERFECT FOR FIRST TIME BUYERS AND FAMILIES ALIKE
- WELL FINISHED THROUGHOUT
- CLOSE TO A WEALTH OF LOCAL AMENITIES
- FANTASTIC TRANSPORT LINKS
- REPUTABLE LOCAL SCHOOLS
- CLOSE TO TRAM NETWORK
- LARGE PRIVATE REAR GARDEN
- AMPLE ON STREET PARKING
- FREEHOLD AND COUNCIL TAX BAND A





Outbuilding

Approx. 5.7 sq. metres (60.9 sq. feet)



Ground Floor

Approx. 38.9 sq. metres (418.8 sq. feet)

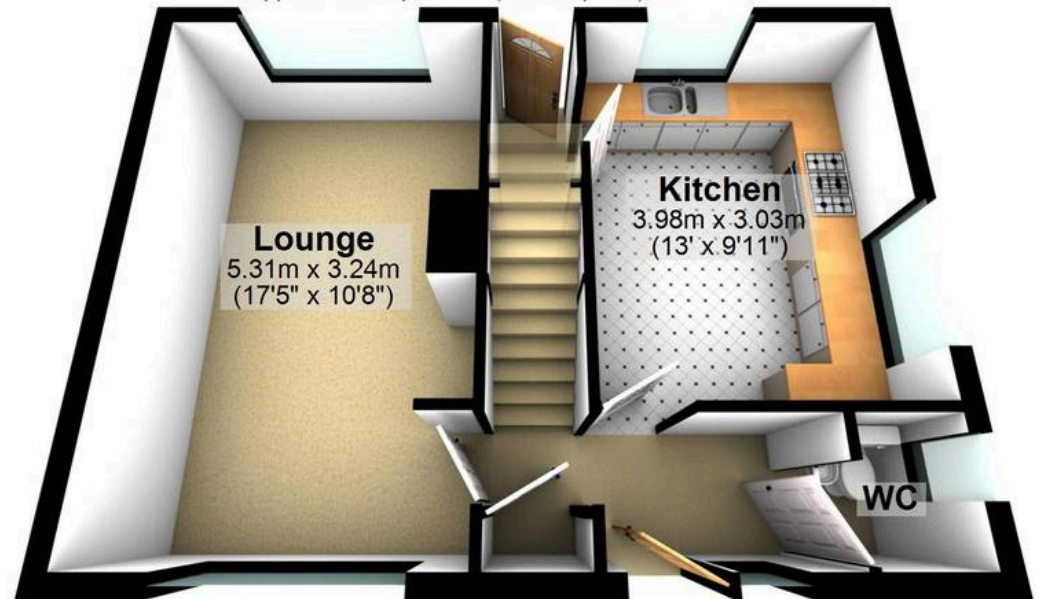

First Floor

Approx. 38.9 sq. metres (418.8 sq. feet)



Second Floor

Approx. 16.8 sq. metres (181.3 sq. feet)

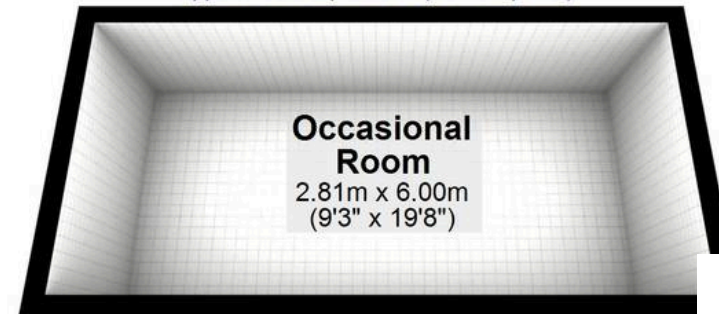

Total area: approx. 100.3 sq. metres (1079.9 sq. feet)

All measurements are approximate
Plan produced using PlanUp.