



WHITEHORNES

Buy. Sell. Let. Relax!

0114 268 8533
info@whitehorses.com
www.whitehorses.com

27 Strelley Avenue, Beauchief

Sheffield

Guide Price **£325,000**

27 Strelley Avenue

Beauchief, Sheffield

A great opportunity has arisen to take possession of this fantastic three bedroomed semi-detached family home, ideally located in the heart of this much sought after and quiet residential suburb with an abundance of green spaces as well as a wealth of local amenities and reputable local schools all within easy walking distance. The property has been tastefully finished throughout and has scope for expansion to both the rear and side (pending planning permission). Briefly consists of entrance hallway, lounge, dining room, kitchen, two double bedrooms, single bedroom and family bathroom. Outside is a stunning garden with excellent views. Council Tax band: C

Tenure: Leasehold

- THREE BEDROOMED SENI-DETACHED PROPERTY
- PERFECT FOR GROWING FAMILIES
- TONS OF POTENTIAL TO EXPAND
- CLOSE TO BEAUCHIEF WOODS
- WEALTH OF LOCAL AMENITIES WITHIN EASY WALKING DISTANCE
- REPUTABLE LOCAL SCHOOLS
- STUNNING VIEWS OUT TOWARDS THE PEAK DISTRICT
- PRIVATE AND WELL ENCLOSED GARDEN TO THE REAR
- TWO RECEPTION ROOMS
- FANTASTIC QUIET LOCATION

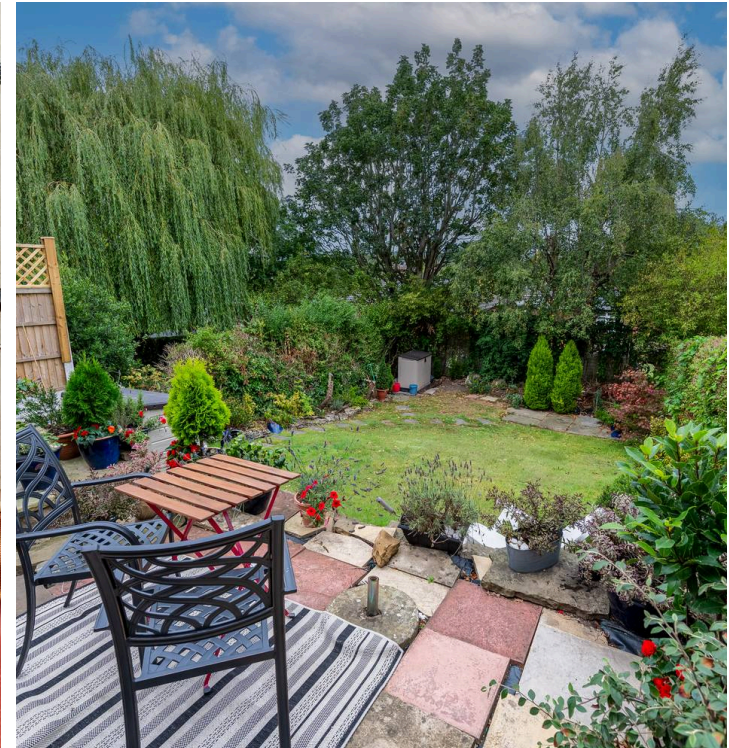



Ground Floor

Approx. 47.5 sq. metres (511.2 sq. feet)

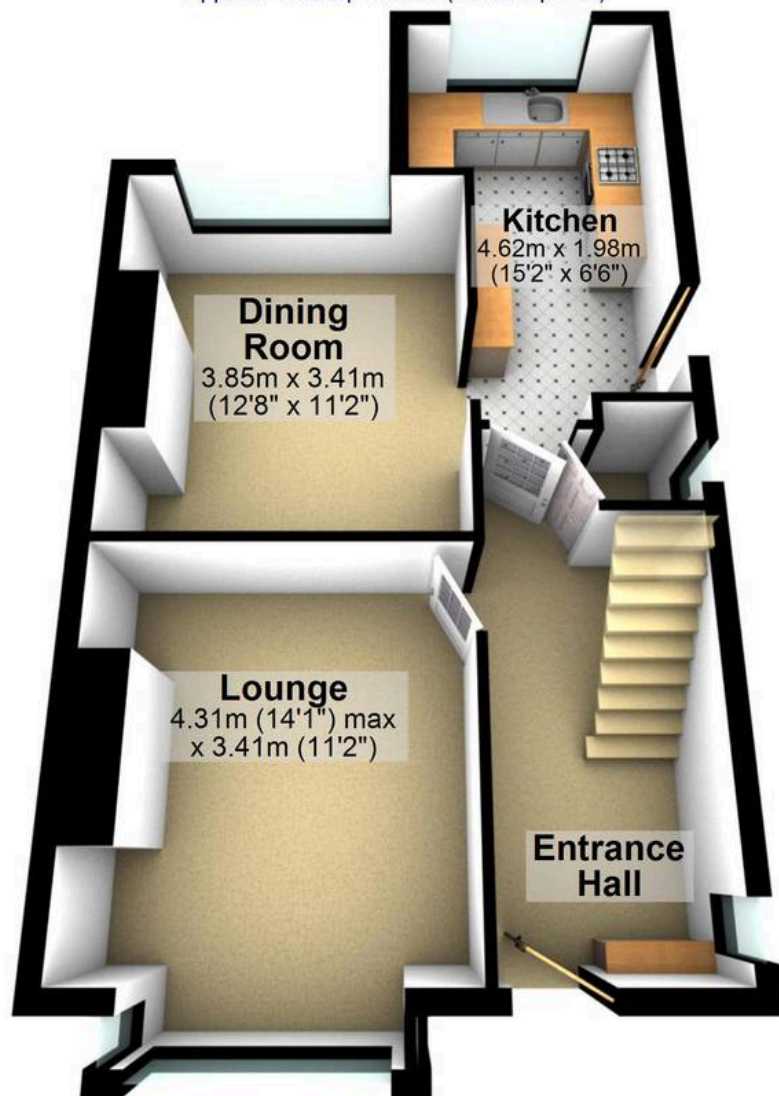

First Floor

Approx. 42.2 sq. metres (453.8 sq. feet)

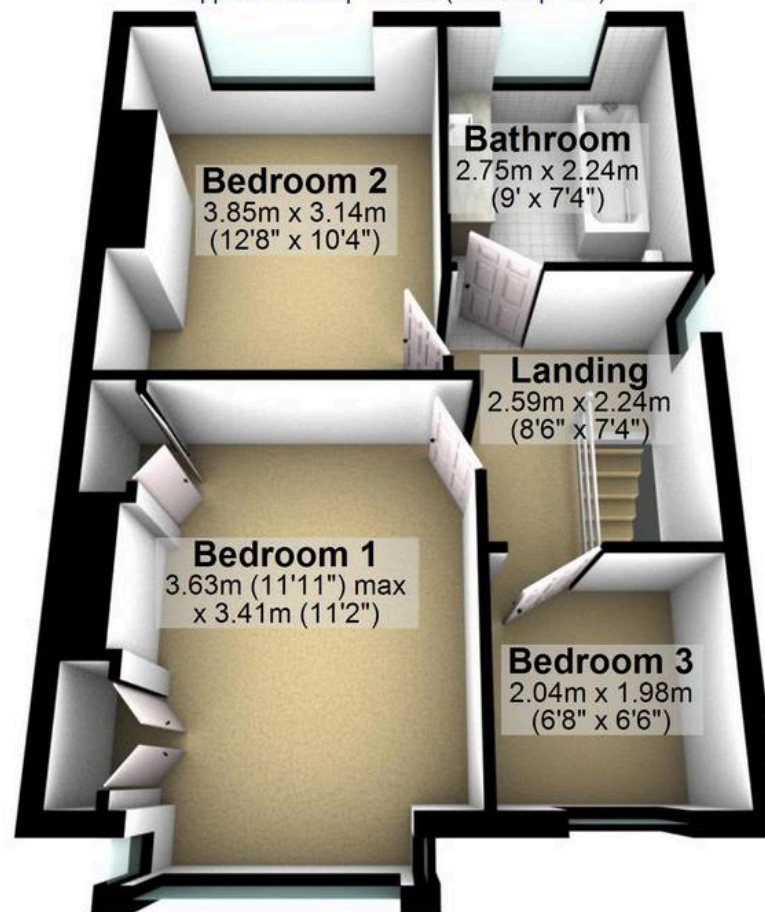

Total area: approx. 89.6 sq. metres (964.9 sq. feet)

All measurements are approximate
Plan produced using PlanUp.

27 Stroller Avenue