



35 Chelsea Road, Brincliffe

Sheffield

Guide Price £625,000 - £650,000

35 Chelsea Road

Brincliffe, Sheffield

Presenting an unparalleled opportunity to acquire a property of remarkable size and style, this stunning five-bedroom semi-detached house stands as a testament to quality craftsmanship. Situated in the heart of Brincliffe on a prestigious Sheffield road, this exquisite period bay-windowed home boasts grandeur and elegance. Boasting an impressive five double bedrooms, this residence provides ample space and comfort for a growing family, encompassed within three floors of this period quality accommodation spanning an impressive 2,083 sq feet. The property's elevated position not only guarantees privacy but also offers captivating far-reaching views from the front elevation. For families seeking excellent educational opportunities, this property falls within the catchment area of Ofsted rated excellent schools such as Greystones Juniors, alongside both High Storrs and Mercia secondary

Council Tax band: D Tenure: Leasehold

- ONCE IN A LIFETIME OPPORTUNITY TO PURCHASE OF THIS SIZE AND STYLE IN RECENT YEARS
- INCREDIBLE FIVE DOUBLE BEDROOMED PERIOD BAY WINDOWED SEMI DETACHED FAMILY HOME
- LOCATED ON THIS ICONIC SHEFFIELD ROAD IN THE HEART OF BRINCLIFFE TOWARDS THE SOUTH WEST OF THE CITY
- STANDING IN THIS ELEVATED POSITION ENSURING PRIVACY AND SOME FAR REACHING VIEWS TO THE FRONT
- OFSTED RATED EXCELLENT SCHOOLING CATCHMENTS INCLUDING GREYSTONES JUNIORS AND BOTH HIGH STORRS/MERCIA SECONDARY
- PERFECT FOR THE GROWING FAMILY MARKET LOOKING TO CREATE A FOREVER HOME





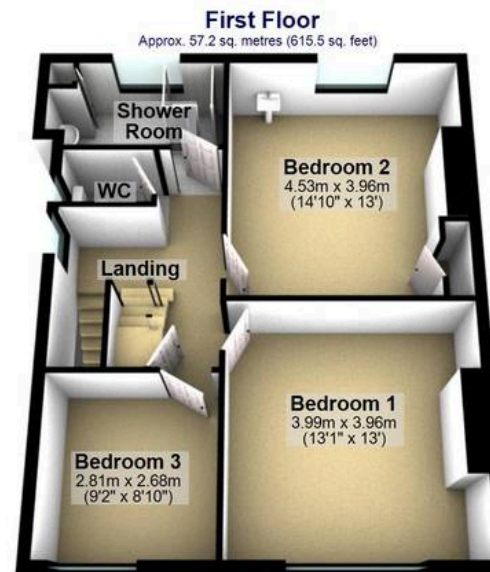
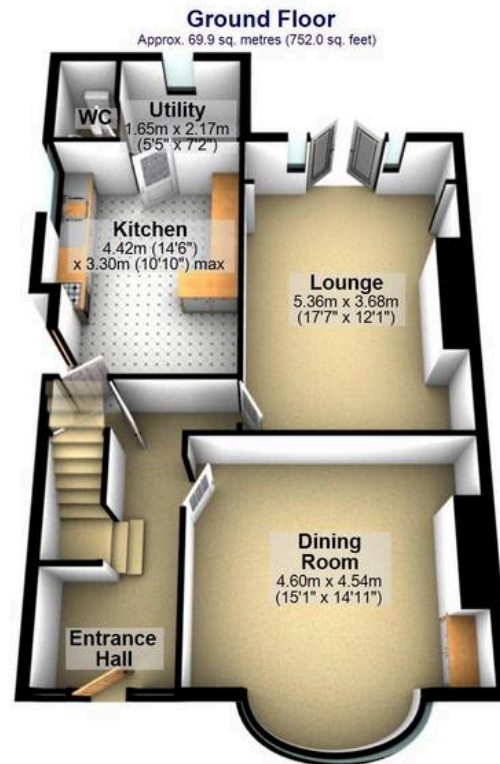
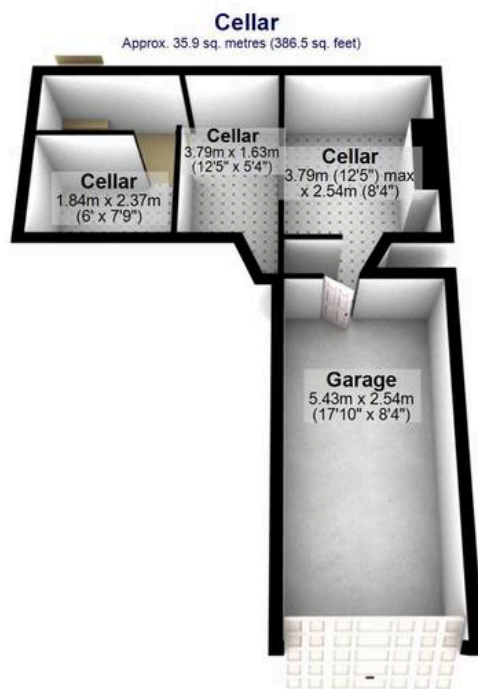

Total area: approx. 193.6 sq. metres (2083.6 sq. feet)

All measurements are approximate
Plan produced using PlanUp.

35 Chelsea Road

WHITEHORNES
Buy. Sell. Let. Relax!

0114 268 8533
info@whitehorses.com
www.whitehorses.com