



WHITEHORNS

Buy. Sell. Let. Relax!

0114 268 8533
info@whitehorns.com
www.whitehorns.com

204 Bradway Road, Sheffield

Sheffield

Guide Price £550,000 – £575,000

204 Bradway Road

Sheffield, Sheffield

Nestled in the heart of the ultra-popular Bradway suburb towards the south-west of the city and in close proximity to the enchanting Peak District, this substantial three-bedroom detached house presents an incredibly rare opportunity. Boasting a double-fronted bay window design, this 1,582 square feet home is spread over two impressive floors, perfectly curated to cater to the needs of a growing family market seeking their forever home. This exceptional property offers a large gated driveway, tandem garage, and a fabulous rear private sunny garden, providing a harmonious blend of convenience and tranquillity. With no onward chain and immediate vacant possession upon completion, the opportunity to shape a bespoke finish to the new buyer's taste and style awaits, striking the perfect balance between contemporary living and timeless charm.

Council Tax band: E Tenure: Leasehold

- SUBSTANTIAL THREE DOUBLE DOUBLE FRONTED BAY WINDOWED DETACHED HOME
- INCREDIBLY RARE OPPORTUNITY TO MAR7FOR A PROPERTY OF THIS SIZE AND CALIBRE
- 1,582 SQ FEET OF ACCOMMODATION ARRANGED OVER TWO IMPRESSIVE FLOORS
- LARGE GATED DRIVEWAY TANDEM GARAGE AND FABULOUS REAR PRIVATE SUNNY GARDEN
- PITCH PERFECT FOR THE GROWING FAMILY MARKET LOOKING FOR A FOREVER HOME
- HIGE OPPORTUNITY TO CREATE A BESPOKE FINISH TO THE NEW BUYERS TASTE AND STYLE
- HEART OF ULTRA POPULAR BRADWAY TOWARDS THE SOUTH WEST OF THE CITY ON THE CUSP OF THE PEAK DISTRICT





Ground Floor

Approx. 95.6 sq. metres (1028.9 sq. feet)

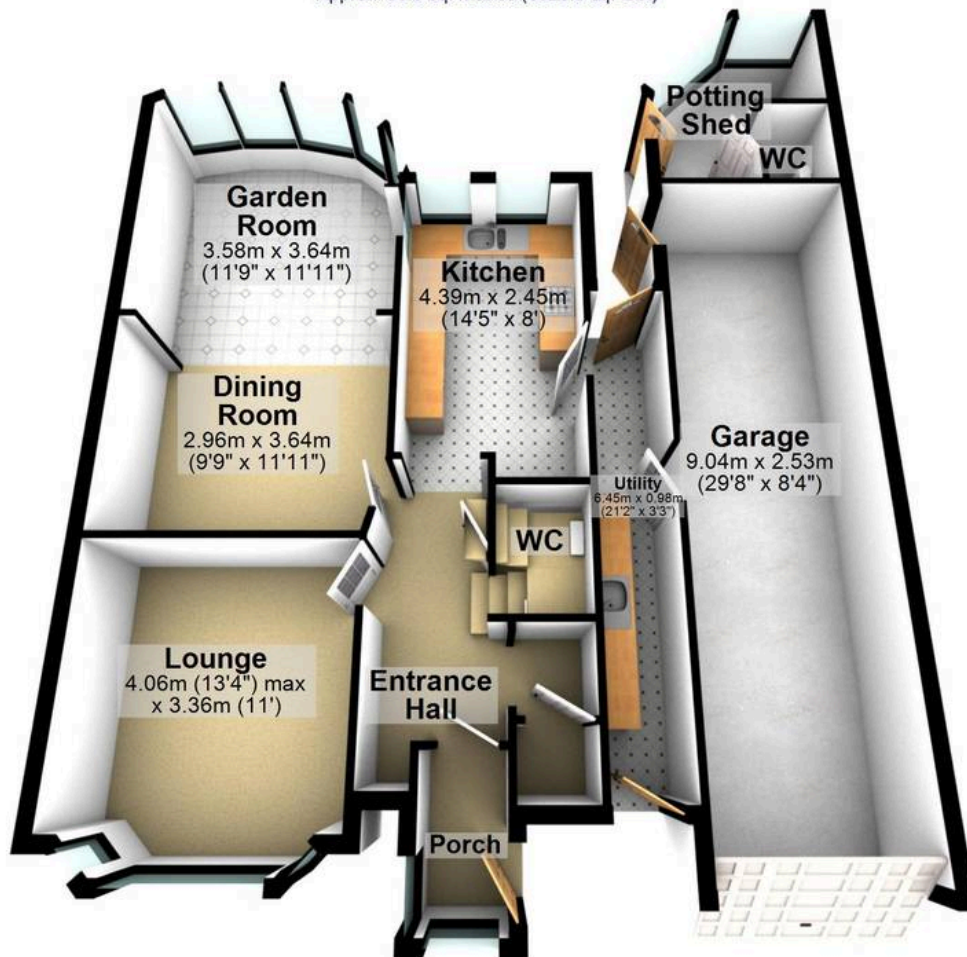

First Floor

Approx. 51.4 sq. metres (553.7 sq. feet)

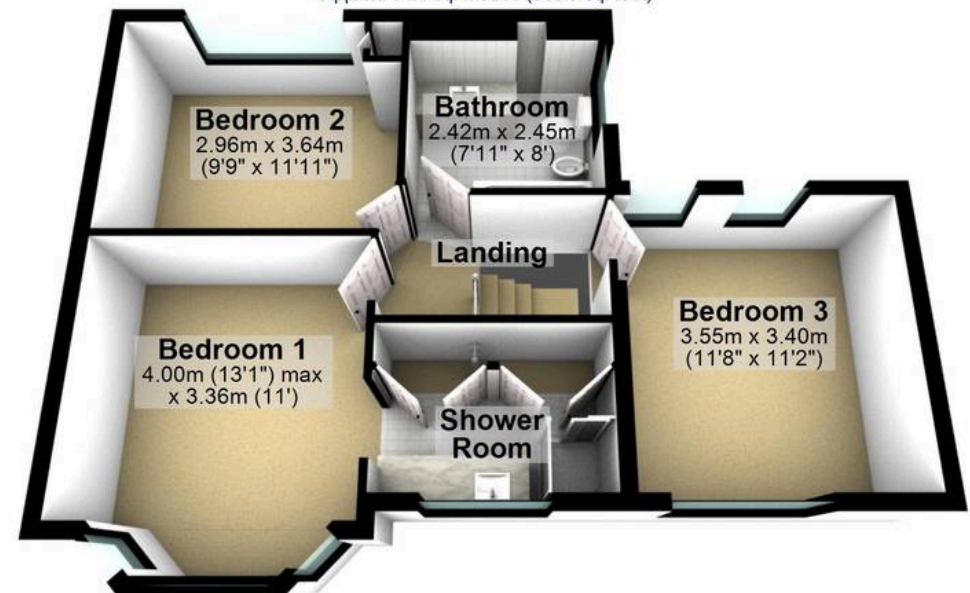

Total area: approx. 147.0 sq. metres (1582.6 sq. feet)

All measurements are approximate
Plan produced using PlanUp.

204 Bradway Road

WHITEHORNES
Buy. Sell. Let. Relax!

0114 268 8533
info@whitehorses.com
www.whitehorses.com