



WHITEHORSES

Buy. Sell. Let. Relax!

0114 268 8533
info@whitehorses.com
www.whitehorses.com



64 Gervase Avenue, Sheffield

Sheffield

Offers in Region of **£135,000**

64 Gervase Avenue

Sheffield, Sheffield

This beautifully presented three-bedroom mid-terraced property offers an ideal family home or buy-to-let investment. Finished to a great standard throughout, the house features a spacious living area, a modern kitchen, and three well-proportioned bedrooms. The property is freehold and benefits from no onward chain, making for a straightforward purchase. Situated close to a wealth of local amenities, including shops, cafes, and reputable local schools, this home is perfectly positioned for convenient every-day living. To the rear, the property boasts a private garden, providing a secure and peaceful outdoor space and to the front is ample on street parking.

Council Tax band: A

Tenure: Freehold

- THREE BEDROOMED MID-TERRACED PROPERTY
- GREAT FAMILY HOME
- FINISHED TO A GREAT STANDARD THROUGHOUT
- CLOSE TO A WEALTH OF LOCAL AMENITIES
- GREAT BUY TO LET OPPORTUNITY
- REPUTABLE LOCAL SCHOOLS
- NO ONWARD CHAIN
- PRIVATE REAR GARDEN
- FREEHOLD PROPERTY
- AMPLE ON STREET PARKING





Ground Floor

Approx. 33.0 sq. metres (355.2 sq. feet)

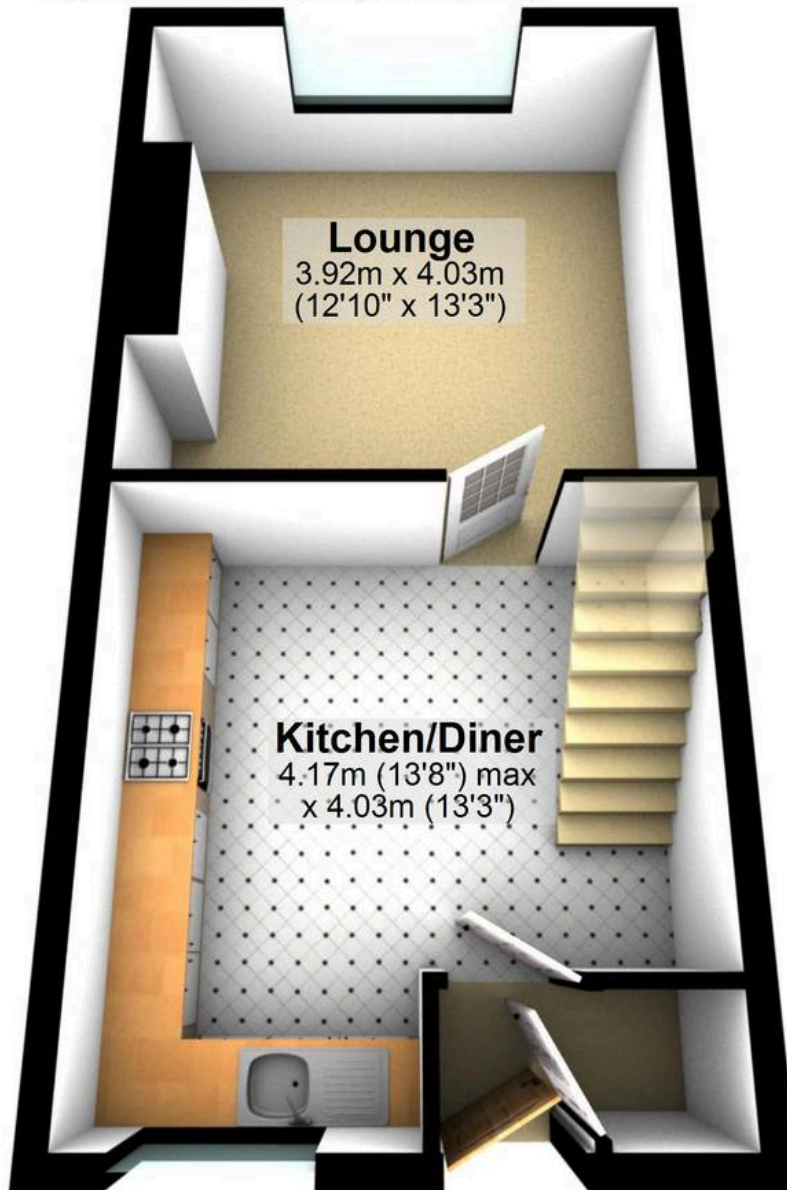

Lounge

3.92m x 4.03m
(12'10" x 13'3")

Kitchen/Diner

4.17m (13'8") max
x 4.03m (13'3")

Total area: approx. 66.0 sq. metres (710.5 sq. feet)

All measurements are approximate
Plan produced using PlanUp.

64 Gervase Avenue

First Floor

Approx. 33.0 sq. metres (355.2 sq. feet)

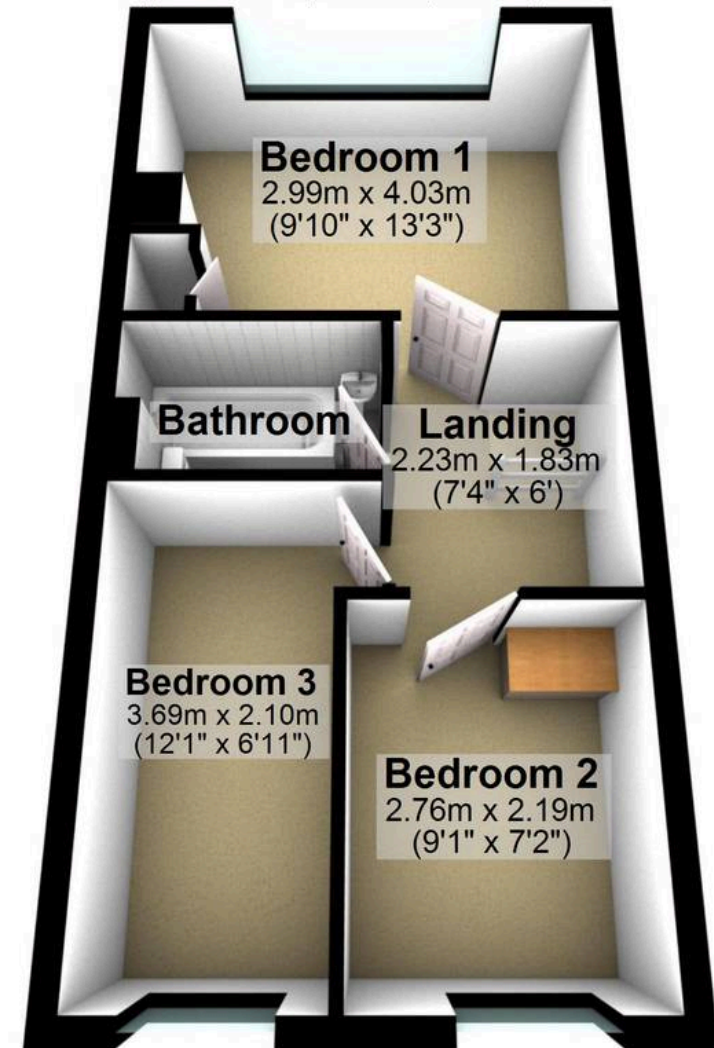

Bedroom 1

2.99m x 4.03m
(9'10" x 13'3")

Bathroom

Landing

2.23m x 1.83m
(7'4" x 6')

Bedroom 3

3.69m x 2.10m
(12'1" x 6'11")

Bedroom 2

2.76m x 2.19m
(9'1" x 7'2")



WHITEHORNS

Buy. Sell. Let. Relax!

0114 268 8533
info@whitehorns.com
www.whitehorns.com