



WHITEHORNES

Buy. Sell. Let. Relax!

0114 268 8533
info@whitehorses.com
www.whitehorses.com

97 Thorpe House Rise, Norton Lees

Sheffield

Offers in Region of **£290,000**

97 Thorpe House Rise

Norton Lees, Sheffield

This stunning three bedroom semi-detached home offers a modern and stylish finish throughout, making it an ideal choice for growing families. The property is situated in a fantastic location close to Graves Park, with reputable local schools nearby and a wealth of shops and cafes within easy walking distance. Inside, the spacious layout provides a welcoming atmosphere, with well-proportioned bedrooms and contemporary fixtures and fittings throughout. The living areas are thoughtfully designed to maximise both comfort and practicality, while the kitchen features high-quality appliances and ample storage. Additional benefits include off-road parking, ensuring convenience for residents and visitors alike. Excellent public transport links are easily accessible, making commuting straightforward and stress-free. With its blend of modern living, superb location, and family-friendly amenities, this property presents a wonderful opportunity for those seeking a home that combines style and convenience. Early viewing is advised to fully appreciate all that this impressive home has to offer.

Council Tax band: B

Tenure: Leasehold

- STUNNING THREE BEDROOMED SEMI-DETACHED HOME
- MODERN AND STYLISH FINISH THROUGHOUT
- FANTASTIC LOCATION CLOSE TO GRAVES PARK
- PERFECT FOR GROWING FAMILIES
- LARGE PRIVATE GARDEN
- OFF ROAD PARKING
- CLOSE TO REPUTABLE LOCAL SCHOOLS
- WEALTH OF LOCAL SHOPS AND CAFES WITHIN EASY





Ground Floor

Approx. 37.6 sq. metres (405.1 sq. feet)

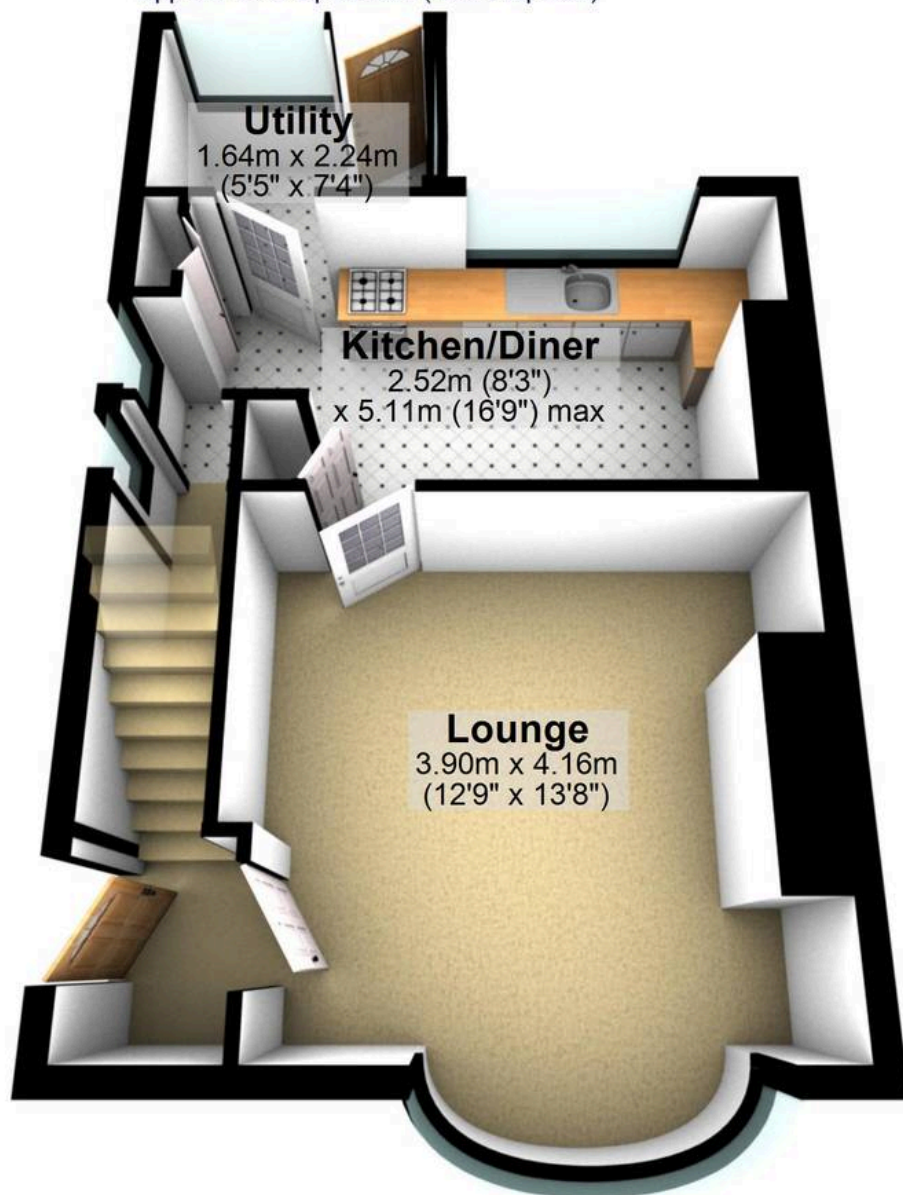

First Floor

Approx. 33.7 sq. metres (362.4 sq. feet)

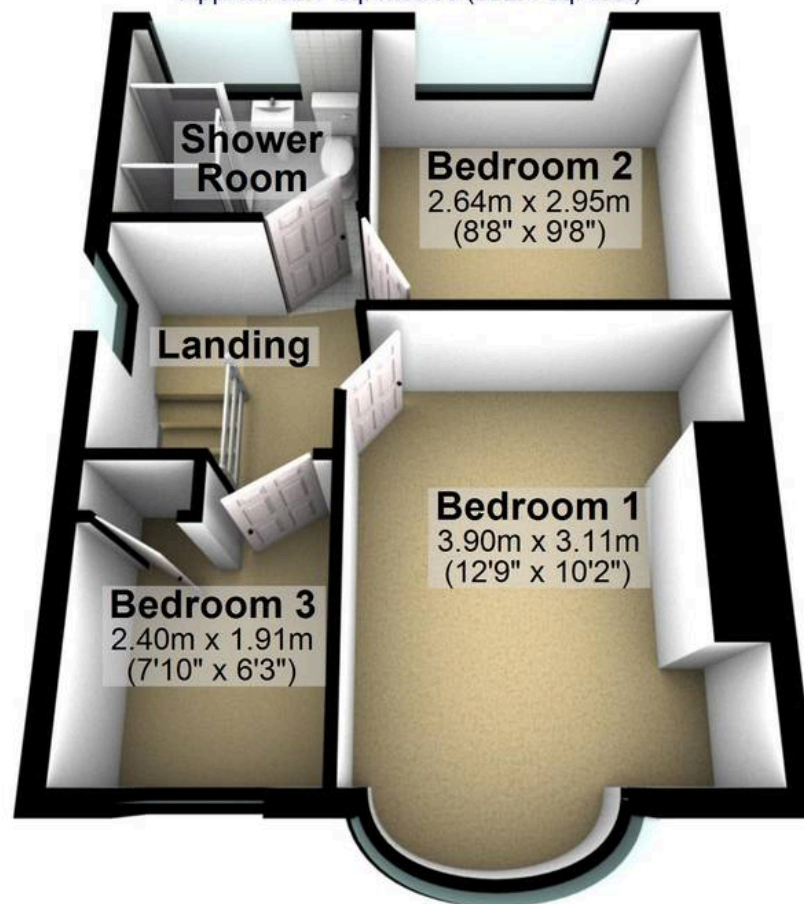

Total area: approx. 71.3 sq. metres (767.5 sq. feet)

All measurements are approximate
Plan produced using PlanUp.

97 Thorpe House Rise