



WHITEHORNES

Buy. Sell. Let. Relax!

0114 268 8533
info@whitehorns.com
www.whitehorns.com

35 Skye Edge Road, Sheffield

Sheffield

Guide Price **£190,000**

35 Skye Edge Road

Sheffield, Sheffield

****GUIDE PRICE - £190,000 to £200,000**** This exceptionally well presented three bedroom semi-detached family home offers a wonderful blend of modern living and comfort, perfect for families and first time buyers alike. The spacious open plan living area is ideal for entertaining or relaxing with loved ones, and large windows throughout the property provide an abundance of natural light as well as stunning views of the surrounding area. The property is conveniently located close to the city centre, with fantastic transport links and reputable local schools nearby, making it an ideal choice for those seeking both convenience and a sense of community. Norfolk Heritage Park is within walking distance, offering a peaceful retreat and plenty of opportunities for outdoor activities. Council Tax band: A

Tenure: Freehold

- THREE BEDROOMED SEMI-DETACHED FAMILY HOME
- EXCEPTIONALLY WELL PRESENTED
- OPEN PLAN LIVING SPACE PERFECT FOR FAMILIES
- STUNNING VIEWS
- CLOSE TO CITY CENTRE
- FANTASTIC TRANSPORT LINKS
- REPUTABLE LOCAL SCHOOLS
- PERFECT FOR FAMILIES AND FIRST TIME BUYERS ALIKE
- NORFOLK HERITAGE PARK WITHIN WALKING DISTANCE
- LARGE PRIVATE GARDEN





Ground Floor

Approx. 33.5 sq. metres (360.5 sq. feet)

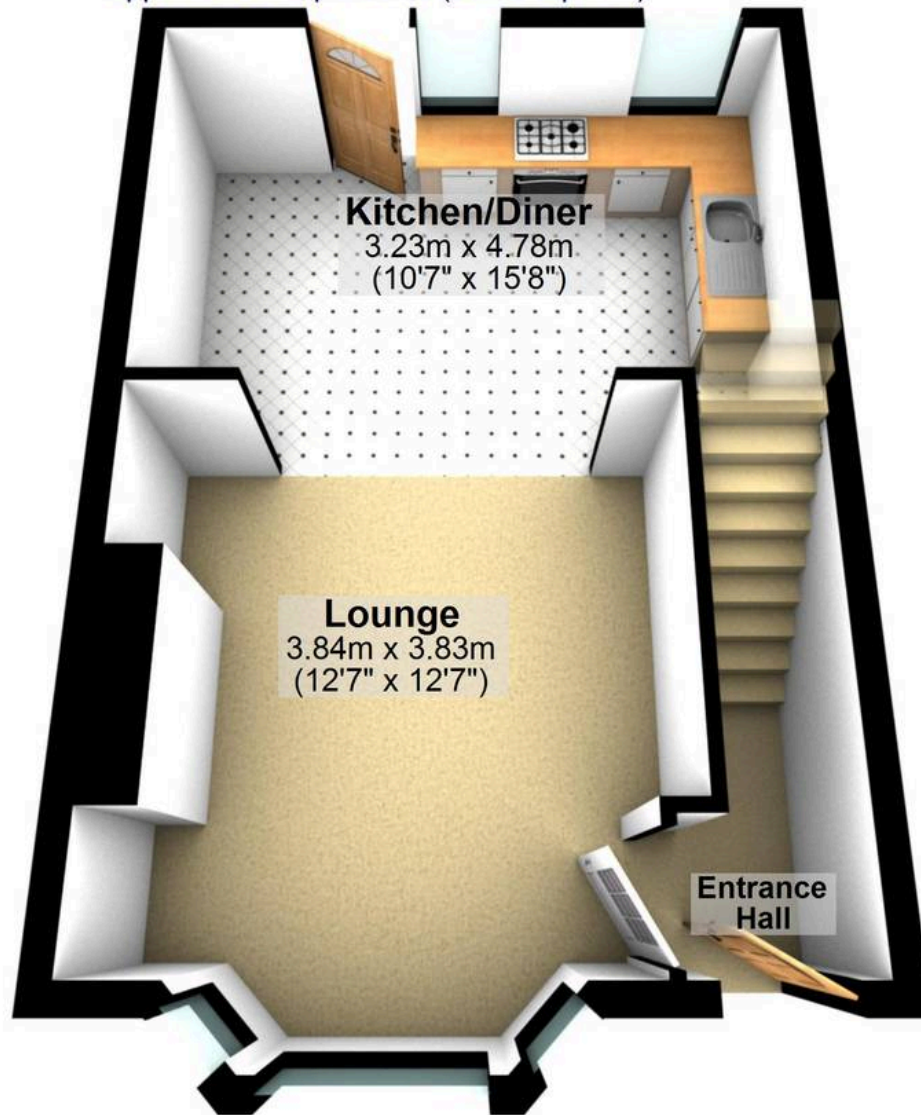

First Floor

Approx. 33.5 sq. metres (360.3 sq. feet)

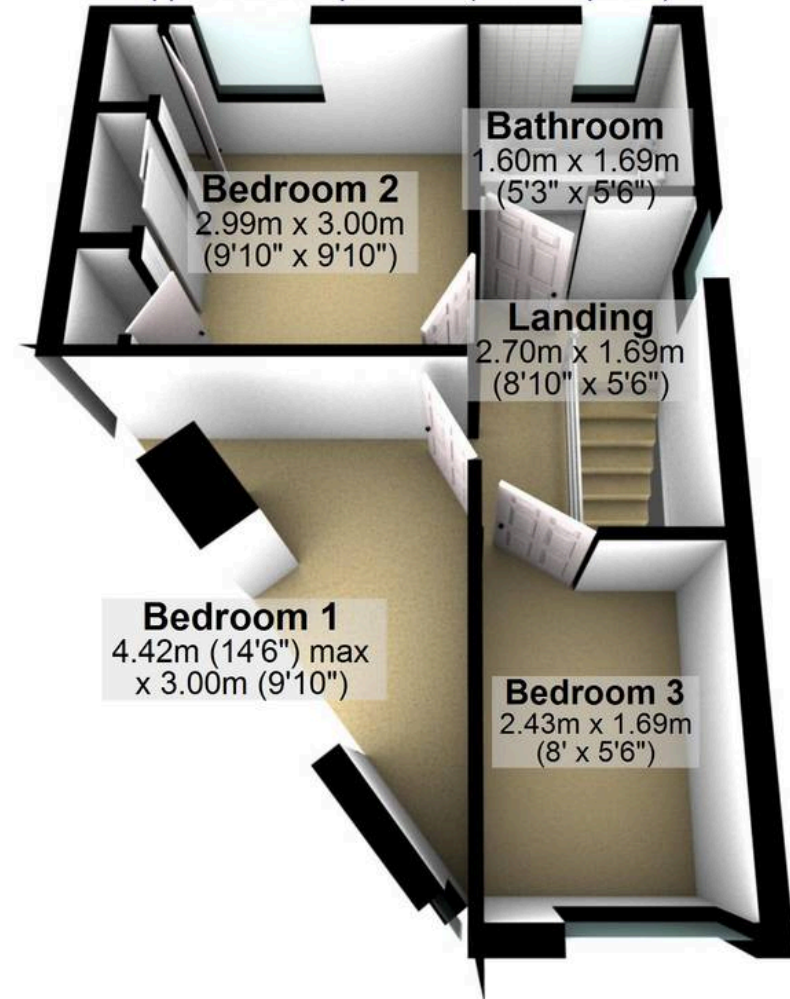

Total area: approx. 67.0 sq. metres (720.8 sq. feet)

All measurements are approximate
Plan produced using PlanUp.

35 Sky Edge Road