



WHITEHORSES

Buy. Sell. Let. Relax!

0114 268 8533
info@whitehorses.com
www.whitehorses.com

Flat 3, 36 Millhouses Lane, Millhouses, Sheffield

Sheffield

Guide Price £117,500 - £120,000

Flat 3, 36 Millhouses Lane

Sheffield

Offered to the market with no onward chain and vacant on completion, this well-presented one bedroom ground floor apartment is an excellent opportunity for first-time buyers, professional couples, investors, or those seeking to downsize. Situated at the quieter rear section of an established and highly sought-after residential development in the heart of Millhouses, the property benefits from a light and spacious feel throughout, with viewing strongly advised to appreciate the accommodation on offer. The apartment comprises a welcoming private entrance hall leading to a generously sized lounge and dining area, where large windows enhance the natural light and create a bright, inviting atmosphere.

Tenure: Leasehold

- ONE BEDROOM GROUND FLOOR APARTMENT
- OFFERED WITH NO ONWARD CHAIN AND VACANT ON COMPLETION
- LIGHT AND SPACIOUS FEEL THROUGHOUT WITH VIEWING ADVISED
- AFFORDABLE PURCHASE FOR THE FIRST TIME BUYERS PROFESSIONAL COUPLE INVESTORS OR THOSE LOOKING TO DOWNSIZE
- WELL SOUGHT AFTER RESIDENTIAL SUBURB IN THE VERY HEART OF ULTRA POPULAR MILLHOUSES
- SET AT THE QUIETER BACK END OF THIS ESTABLISHED DEVELOPMENT WITH THE COMMUNAL GARDENS IN FRONT
- NUMEROUS LOCAL INDEPENDENT BAKERIES CAFES AND LARGER SUPER MARKETS ALL ON THE DOORSTEP
- MILLHOUSES PARK AND ECCLESALL WOODS A SHORT STROLL ALONG WITH THE PEAK DISTRICT UP THE ROAD





Ground Floor

Approx. 37.6 sq. metres (404.6 sq. feet)

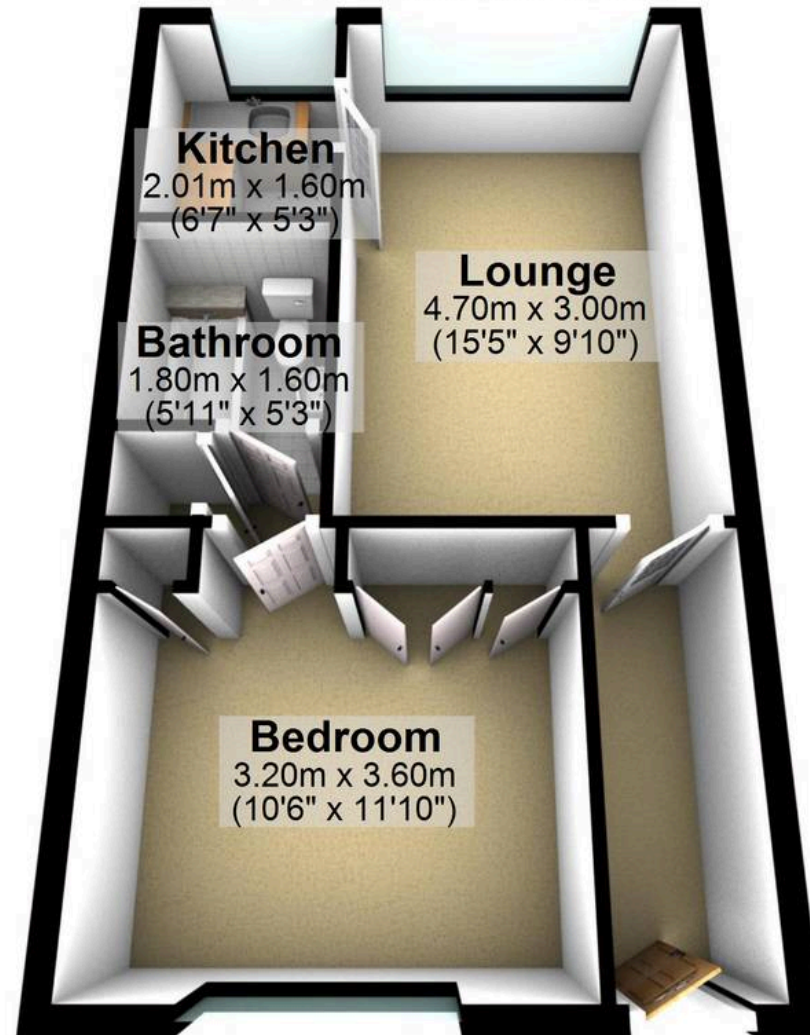

Total area: approx. 37.6 sq. metres (404.6 sq. feet)

All measurements are approximate
Plan produced using PlanUp.