



WHITEHORSES

Buy. Sell. Let. Relax!

0114 268 8533
info@whitehorses.com
www.whitehorses.com



Navarda House, Rotherham Road, Halfway

Sheffield

In Excess of **£350,000**

Navarda House, Rotherham Road

Halfway, Sheffield

Early viewing is advised for this truly deceptive, beautiful four bedroomed semi-detached family home. Boasting a truly impressive 1,895 sq ft of light and bright accommodation which in brief consists of a superb cozy yet spacious sitting/entertainment room, snug which could also be used as a home office or playroom, on the ground floor a modern, well appointed kitchen/dining room which opens onto the airy front living room, and on the first floor, four lovely bedrooms, the master benefitting from an en-suite, and a family bathroom. To the outside of this freehold house is a low maintenance, private rear garden which also boasts a patio space which is ideal for entertaining. Not to forget this property has the added benefit of numerous spaces for off-road parking on the large driveway and garage, Located in the heart of popular Halfway this property is close by to numerous local amenities and reputable schools including Halfway Nursery/infant school and Halfway Junior School. VALUER - BEN WHITEHORNE

Council Tax band: C

Tenure: Freehold

- FOUR BEDROOMED, TWO BATHROOMED SEMI-DETACHED HOUSE
- AN IMPRESSIVE 1,895 SQ FT OF LIGHT, BRIGHT AND SPACIOUS ACCOMMODATION
- CLOSE BY TO REPUTABLE LOCAL SCHOOLS INCLUDING HALFWAY JUNIOR SCHOOL
- VIEWING ESSENTIAL TO DO FULL JUSTICE TO THIS DECEPTIVE PROPERTY
- PRIVATE REAR GARDEN WITH FRECNH DOORS OPENING ONTO PATIO AREA





Lower Ground Floor

Approx. 48.3 sq. metres (519.7 sq. feet)

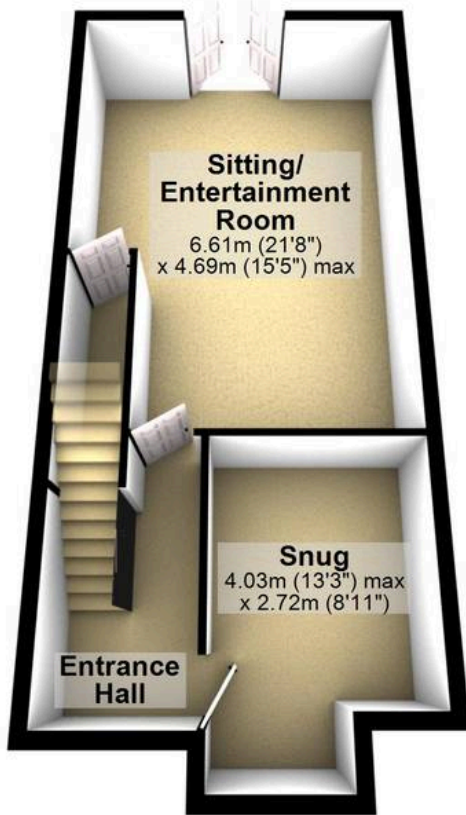

Ground Floor

Approx. 65.0 sq. metres (699.7 sq. feet)

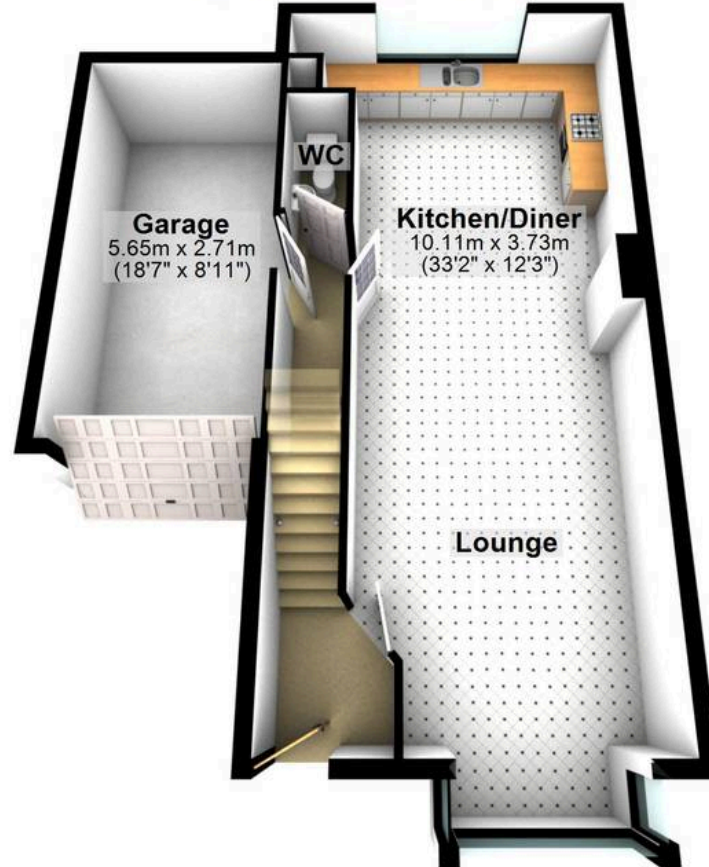

First Floor

Approx. 62.8 sq. metres (676.4 sq. feet)

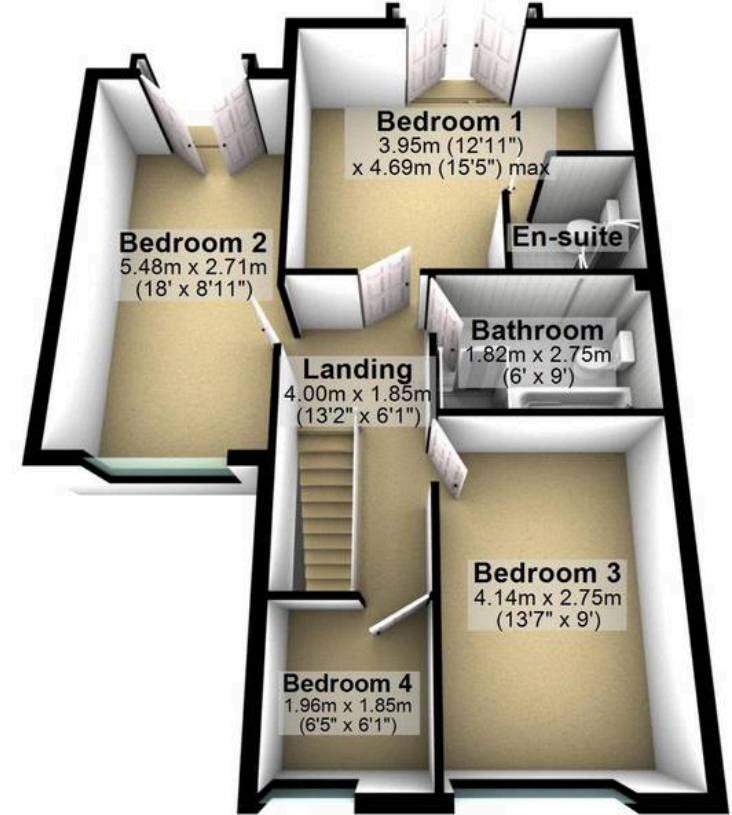

Total area: approx. 176.1 sq. metres (1895.7 sq. feet)

All measurements are approximate
Plan produced using PlanUp.

NAVARDA HOUSE, ROTHERHAM ROAD