

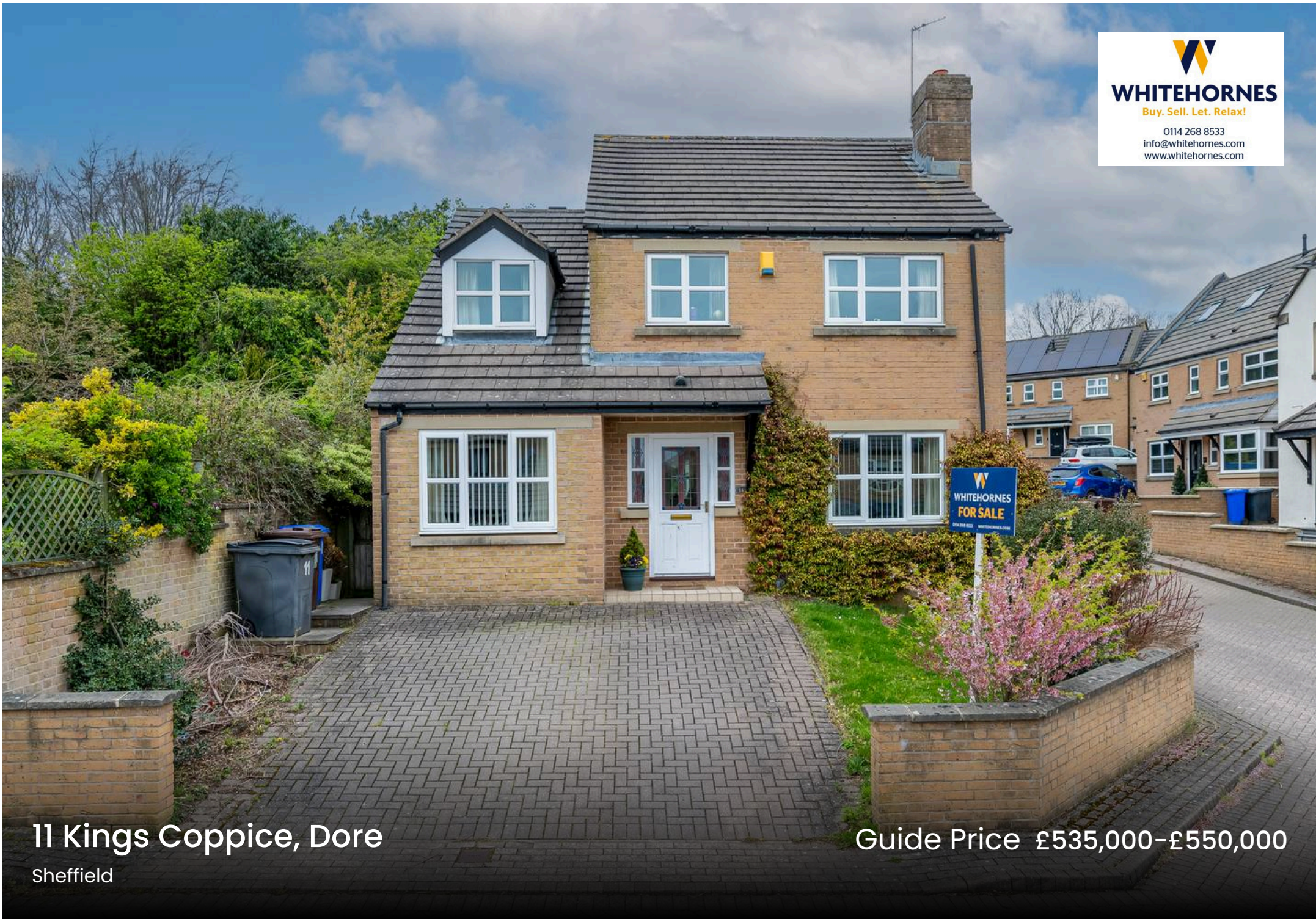

WHITEHORNS
Buy. Sell. Let. Relax!
0114 268 8533
info@whitehorns.com
www.whitehorns.com



11 Kings Coppice, Dore

Sheffield

Guide Price £535,000-£550,000

11 Kings Coppice

Dore, Sheffield

This fabulous four/five bedroom, two bath/shower roomed, detached family home is perfectly positioned in a quiet, tucked away cul-de-sac at the very heart of the ultra-popular Dore area within Sheffield S17. Offering flexible accommodation arranged over two well-planned floors, the property features a converted garage that can be utilised as a fifth bedroom, play room or designated work from home office if required, making it ideal for growing families or those seeking versatile living spaces.

Council Tax band: E Tenure: Leasehold

- FABULOUS FOUR/FIVE BEDROOM TWO BATH/SHOWER ROOMED DETACHED FAMILY HOME
- QUIET TUCKED AWAY CUL DE SAC POSITION WITHIN THE VERY HEART OF ULTRA POPULAR DORE WITHIN SHEFFIELD S17
- FLEXIBLE ACCOMMODATION ARRANGED OVER TWO FLOORS WITH A CONVERTED GARAGE THAT CAN DOUBLE UP AS A FIFTH BEDROOM IF REQUIRED
- TASTEFULLY EXTENDED TO THE REAR WITH AN ADDITIONAL SUN/GARDEN ROOM THAT BENEFITS FROM A NEWLY INSTALLED SOLID ROOF
- OFSTED RATED EXCELLENT SCHOOLING CATCHMENTS INCLUDING DORE JUNIOR AND KING EGBERTS SECONDARY
- LOCATED WITHIN A SHORT STROLL OF DORE VILLAGE INDEPENDENT SHOPS EATERIES AND CAFES
- SET ON THE CUSP OF THE PEAK DISTRICT YET WITHIN EASY ACCESS OF DORE AND TOTLEY TRAIN STATION ALONG WITH PRINCIPAL HOSPITALS UNIVERSITIES AND CENTRAL SHEFFIELD





Ground Floor

Approx. 75.7 sq. metres (814.3 sq. feet)

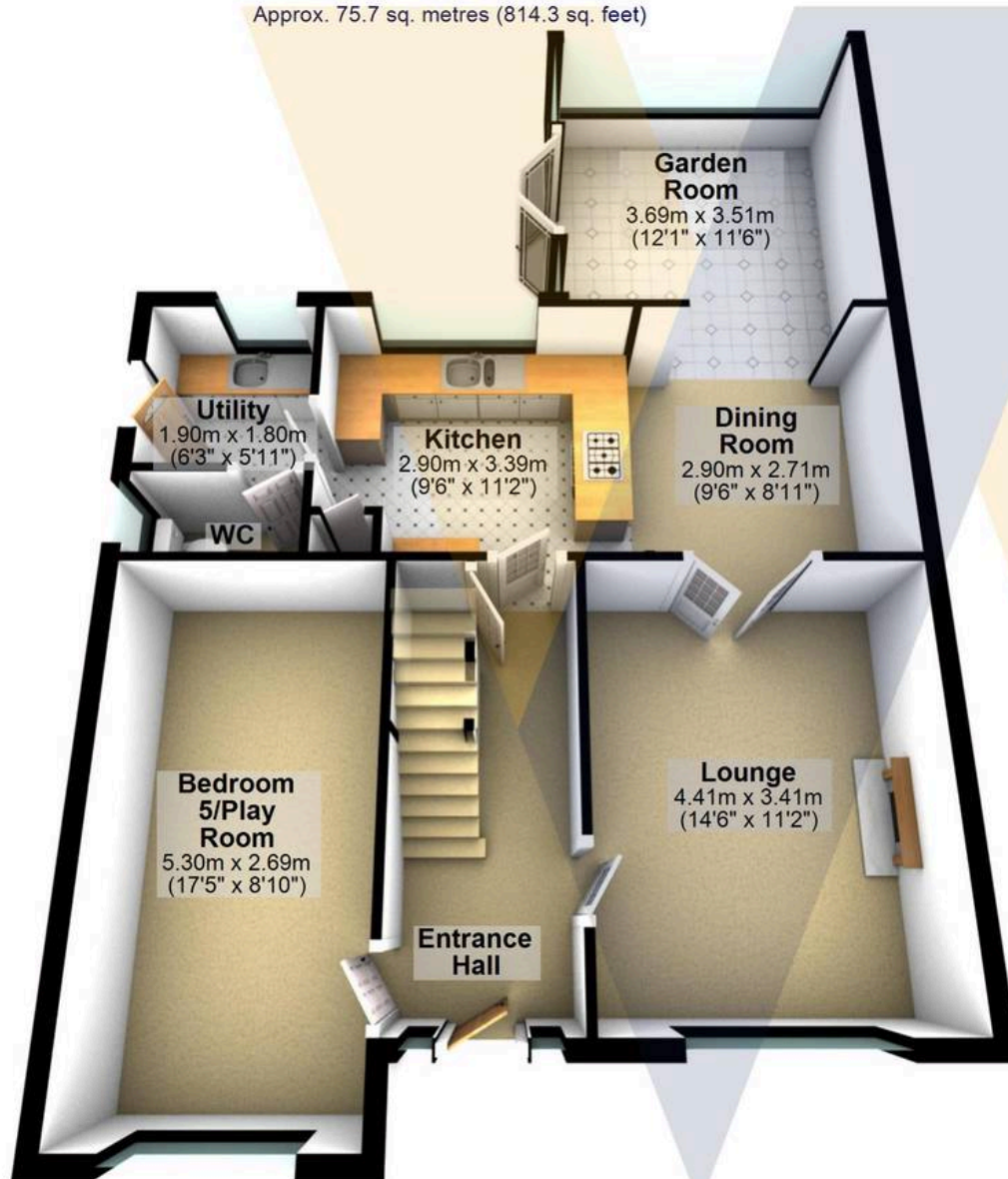

First Floor

Approx. 57.2 sq. metres (615.8 sq. feet)

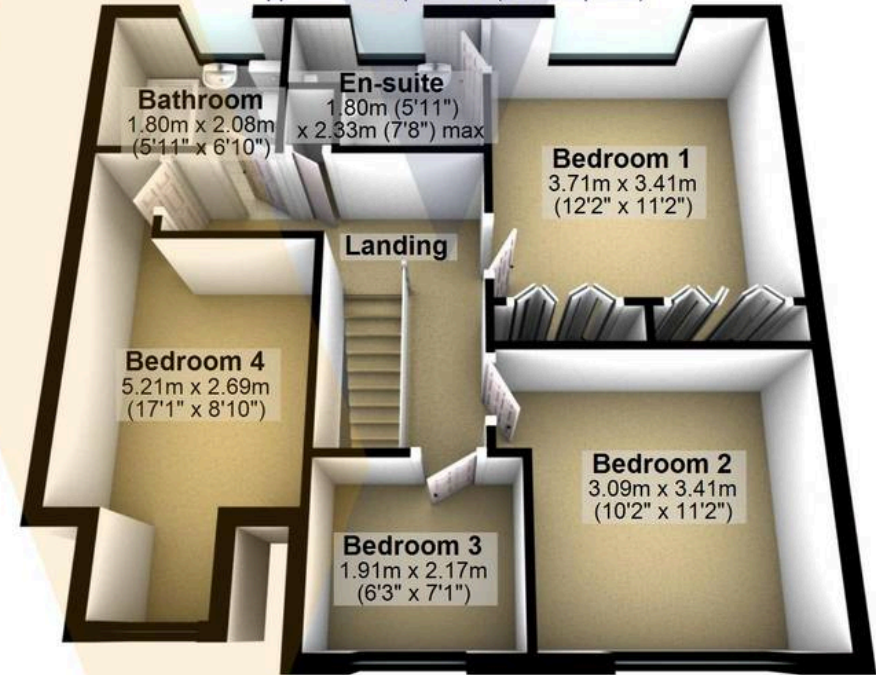

Total area: approx. 132.9 sq. metres (1430.1 sq. feet)

All measurements are approximate
Plan produced using PlanUp.

11 kings coppice, Sheffield



WHITEHORNES

Buy. Sell. Let. Relax!

0114 268 8533
info@whitehornes.com
www.whitehornes.com