



**WHITEHORNES**

Buy. Sell. Let. Relax!

0114 268 8533  
info@whitehorns.com  
www.whitehorns.com

**79 Tullibardine Road, Ecclesall**

Sheffield

Offers in Region of £250,000

# 79 Tullibardine Road

Ecclesall, Sheffield

This well presented and proportioned two double bedroom Victorian mid-terraced home offers an excellent opportunity for first time buyers, professional couples, or young families seeking a property in the heart of ever-popular Ecclesall, on the south west side of Sheffield. The house is set over two spacious and light-filled floors, totalling 718 square feet, and is available to the market with the benefit of no upward chain and vacant possession. The accommodation comprises a welcoming lounge with period features, a separate dining room, and a well-appointed kitchen that provides plenty of scope for personalisation and future value. Upstairs, the passageway to the front first floor allows both bedrooms to be generous doubles, while the family bathroom is well proportioned.

Council Tax band: A Tenure: Leasehold

- WELL PRESENTED AND PROPORTIONED TWO DOUBLE BEDROOM VICTORIAN TERRACED HOME
- ABSOLUTELY PITCH PERFECT FOR THE FIRST BUY PROFESSIONAL COUPLE OR YOUNG FAMILY ALIKE
- PLENTY OF SCOPE TO ADD PERSONALISATION AND CREATE A FINISH TAILORED TO THE NEW BUYERS OWN BRIEF AND IN TURN ADD FUTURE VALUE
- LOCATED OF THIS SUPER POPULAR RESIDENTIAL ROAD WITHIN THE VERY HEART OF ULTRA POPULAR ECCLESALL ON THE SOUTH WEST OF THE CITY
- EXCELLENT SCHOOLING CATCHMENTS INCLUDING GREYSTONES JUNIORS AND HIGH STORRS SECONDARY
- AVAILABLE TO MARKET WITH NO UPWARD CHAIN





Approx Gross Internal Area  
67 sq m / 716 sq ft

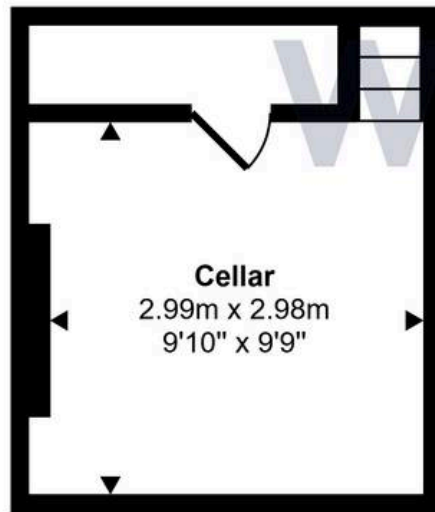

Cellar  
Approx 12 sq m / 128 sq ft

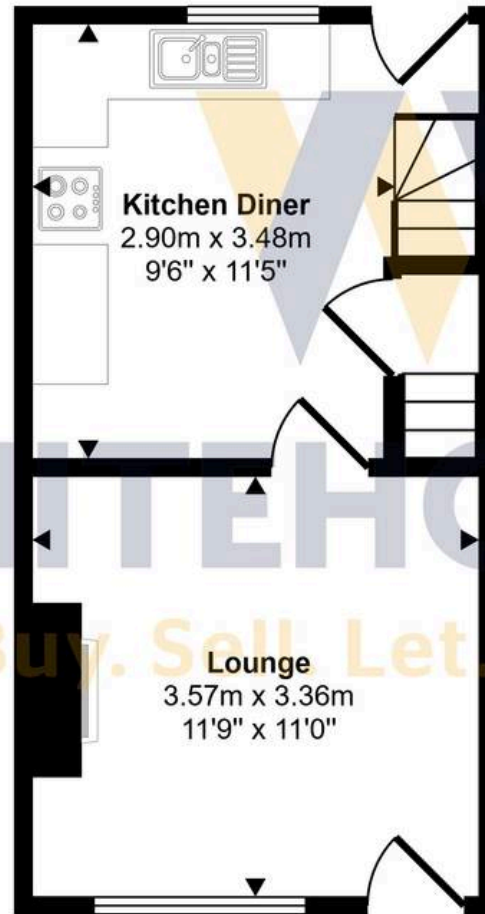

Ground Floor  
Approx 25 sq m / 268 sq ft

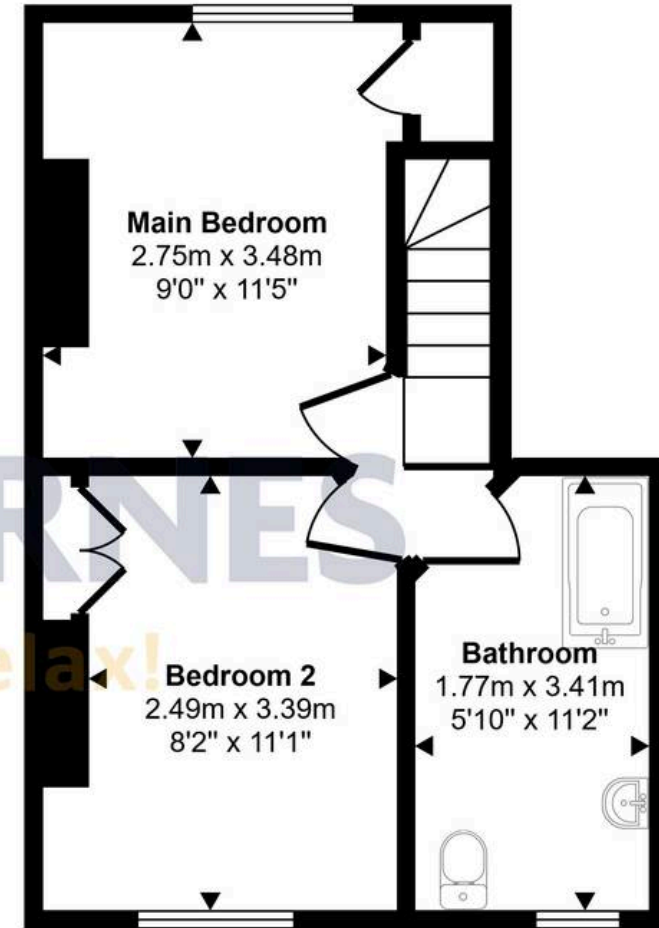

First Floor  
Approx 30 sq m / 320 sq ft

This floorplan is only for illustrative purposes and is not to scale. Measurements of rooms, doors, windows, and any items are approximate and no responsibility is taken for any error, omission or mis-statement. Icons of items such as bathroom suites are representations only and may not look like the real items. Made with Made Snappy 360.