



WHITEHORSES

Buy. Sell. Let. Relax!

0114 268 8533
info@whitehorses.com
www.whitehorses.com

100 Harvey Clough Road, Norton Lees

Sheffield

Offers in Region of **£600,000**

100 Harvey Clough Road

Norton Lees, Sheffield

This stunning five-bedroom detached family home offers versatile and spacious accommodation, ideal for growing families. The main residence features four generously sized bedrooms, two large reception rooms, and a well-appointed kitchen, all finished to a high standard. The property also benefits from a one-bedroom, two-story detached annexe, perfect for guests or multi-generational living. Located in a fantastic position close to both Graves and Meersbrook Parks, this home is within easy reach of reputable local schools, making it particularly attractive for families. A wealth of local shops and charming cafes are within walking distance, and excellent transport links provide convenient access to the wider area. Early viewing is strongly advised to appreciate all this exceptional property has to offer. The outside space is equally impressive, with large private gardens surrounding the house. The mature lawn and established borders create a picturesque setting, while a spacious patio area is perfect for al fresco dining. There is ample off-road parking, as well as secure storage for bikes and garden equipment. The combination of generous outdoor space and a prime location ensures this property is a rare find in the area.

Council Tax band: C

Tenure: Leasehold

- STUNNING FOUR BEDROOMED DETACHED FAMILY HOME
- ONE BEDROOMED TWO STORY DETACHED ANNEX
- LARGE PRIVATE GARDENS
- FANTASTIC LOCATION CLOSE TO GRAVES AND MEERSBROOK PARKS
- PERFECT FOR GROWING FAMILIES





Ground Floor

Approx. 59.0 sq. metres (634.6 sq. feet)



Kitchen
2.94m x 4.98m
(9'8" x 16'4")

Dining Room
3.90m x 5.47m
(12'9" x 17'11")

Lounge
4.03m x 3.93m
(13'3" x 12'11")

First Floor

Approx. 52.3 sq. metres (562.8 sq. feet)

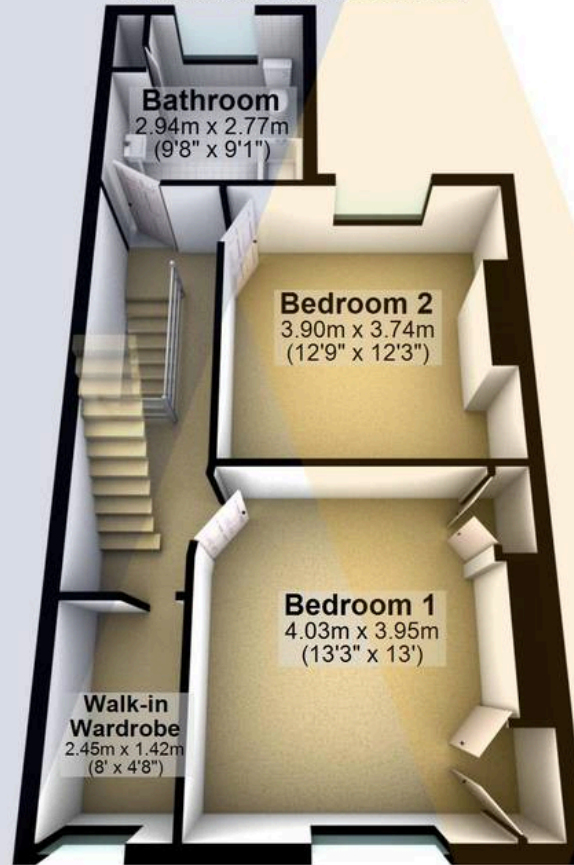

Bathroom
2.94m x 2.77m
(9'8" x 9'1")

Bedroom 2
3.90m x 3.74m
(12'9" x 12'3")

Bedroom 1
4.03m x 3.95m
(13'3" x 13')

**Walk-in
Wardrobe**
2.45m x 1.42m
(8' x 4'8")

Second Floor

Approx. 27.8 sq. metres (298.9 sq. feet)

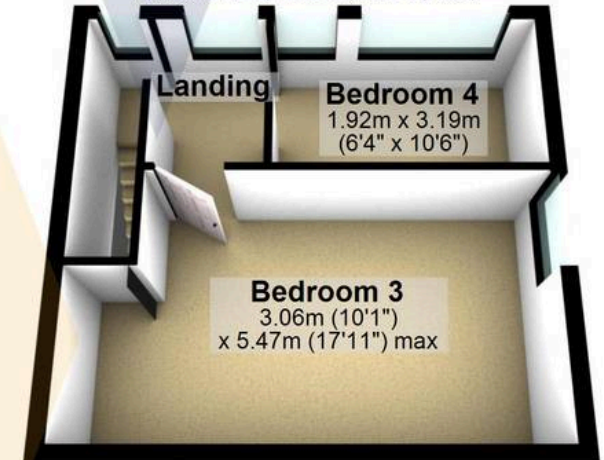

Landing

Bedroom 4
1.92m x 3.19m
(6'4" x 10'6")

Bedroom 3
3.06m (10'1")
x 5.47m (17'11") max

Total area: approx. 139.0 sq. metres (1496.3 sq. feet)

All measurements are approximate
Plan produced using PlanUp.

100 Harvey Clough Road



WHITEHORNES

Buy. Sell. Let. Relax!

0114 268 8533
info@whitehorses.com
www.whitehorses.com