



WHITEHORSES

Buy. Sell. Let. Relax!

0114 268 8533
info@whitehorses.com
www.whitehorses.com

47 Lound Road, Handsworth

Sheffield

Offers in Region of **£150,000**

47 Lound Road

Handsworth, Sheffield

This two-bedroom semi-detached family home presents an excellent opportunity for first-time buyers or investors, offered with no onward chain for a smooth and efficient purchase process. Situated in an enviable location on a quiet road, the property benefits from close proximity to local shops, cafes, and reputable schools, making it ideal for families. The house features a spacious and inviting layout, with scope for further expansion pending planning approval, allowing buyers to tailor the property to their needs. Excellent transport links provide easy access to surrounding areas, enhancing convenience for commuters. The property sits within a sought-after catchment area for well-regarded schools, appealing to those with educational priorities. Off-road parking offers added practicality, ensuring convenience for residents and visitors alike. This home represents a great investment opportunity, combining immediate comfort with the potential for future value growth. Early viewing is advised to fully appreciate the potential and appeal of this well-located and versatile property.

Council Tax band: A

Tenure: Leasehold

- TWO BEDROOMED SEMI-DETACHED FAMILY HOME
- AVAILABLE WITH NO ONWARD CHAIN
- LARGE GARDEN AND OFF ROAD PARKING
- ENVIABLE LOCATION ON THIS QUIET ROAD CLOSE TO LOCAL SHOPS AND CAFES
- EXCELLENT TRANSPORT LINKS
- POTENTIAL FOR EXPANSION PENDING PLANNING APPROVAL
- EARLY VIEWING IS ADVISED AND PERFECT FOR FIRST TIME BUYERS





Approx Gross Internal Area
57 sq m / 616 sq ft

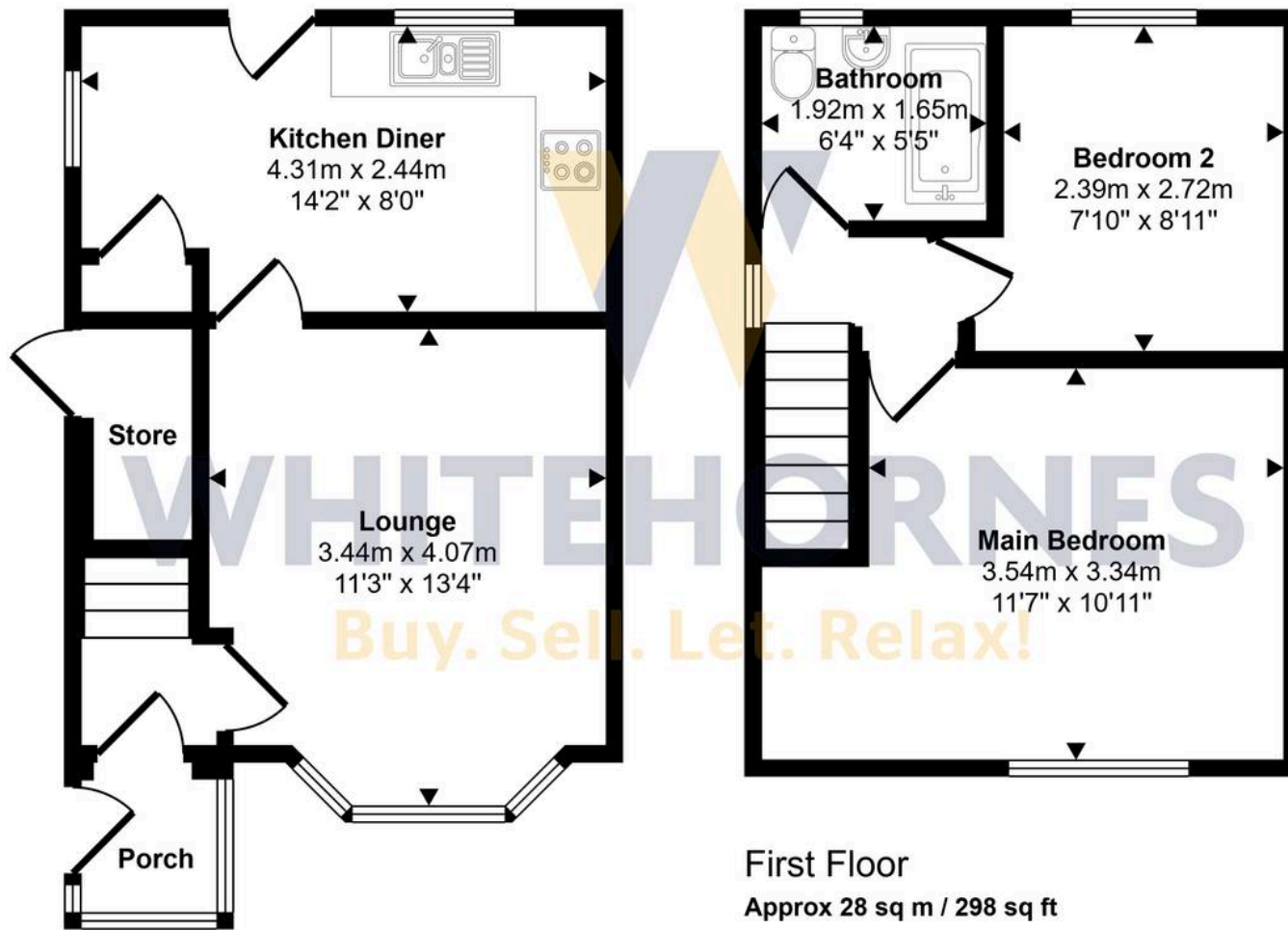

This floorplan is only for illustrative purposes and is not to scale. Measurements of rooms, doors, windows, and any items are approximate and no responsibility is taken for any error, omission or mis-statement. Icons of items such as bathroom suites are representations only and may not look like the real items. Made with Made Snappy 360.